

September 26, 2011

Danielle Wheeler
March JPA
23555 Meyer Drive
Riverside, CA 92518

Re: Lead-based Paint Survey (for RRP Compliance)
March Air Force Base
Buildings 940, 942 and 960
Moreno Valley, California 92581

Project No: 39361

Dear Ms. Wheeler:

On September 19, 2011, California DPH Certified Inspector/Assessor, Michael Hartsfield (#14325) of Patriot Environmental Laboratory Services, Inc. (Patriot) performed a lead-based paint survey at the above subject property located in Riverside, California. **The purpose of this inspection is to identify and assess the Lead-Based Paint (LBP) present on interior and exterior painted components at the subject property for the purpose of complying with the EPA's Renovation Repair and Painting Rule (RRP).**

Site Description

The subject property consists of three building structures, one multi-family residential structure and two commercial building structures. The surveyed structures consist of 2 one-story and 1 three-story structure. The subject buildings are a combination of wood-frame, concrete and metal frame structures set on concrete foundations.

Scope of Work

On September 19, 2011, Michael Hartsfield (DPH#14325) of Patriot conducted a lead-based paint inspection at the subject property. The scope of work for the project, was to perform a lead-based paint (LBP) investigation to identify and assess the Lead-Based Paint (LBP) present on the interior and exterior painted components at the subject property, in accordance with the U.S. Department of Housing and Urban Development (HUD) "Guidelines for the

Evaluation and Control of Lead-Based Paint Hazards in Housing,” 1997 Revision to Chapter 7: Lead Based Paint Inspections. Building 942, 940, and 960 were tested in this investigation.

Methodology

Lead-Based Paint Survey Approach

Suspect LBP was identified based on a walk-through of the interior and exterior buildings at the subject property. Pursuant to HUD inspection requirements for target housing at a multi-family development an appropriate subset of representative similar structures were selected for inspection.

A hand-held Niton XLp #300A x-ray fluorescence (XRF) unit (Serial #25215) was used to determine the presence of lead in painted surfaces throughout the impacted areas of the subject structure. This XRF unit utilizes a 40 mCi Cadmium¹⁰⁹ source dated 6/1/10. Readings were collected from representative interior and exterior building components and common areas.

For this survey, the HUD Guideline policies concerning lead were followed. According to the HUD Guidelines, the definition of a LBP is any paint, varnish, lacquer, putty, plaster, or similar coating material, which contains lead or its compounds in excess of 1.0 mg/cm² when measured by a lead detecting instrument or in excess of 5,000 parts per million (ppm) by dry weight or more of lead.

All necessary areas of the buildings inspected were accessible to Patriot’s representative at the time of this inspection.

Summary of Findings

A total of 988 XRF readings, including calibration readings, were collected by Patriot during the LBP survey conducted at the subject property. **Lead based paint at concentrations greater than 1.0 mg/cm² was identified on several of the XRF readings from the various representative painted structural components tested throughout the subject structures.**

The location of the identified lead-based paints in the **interior and exterior** of the Site structure by XRF includes the following components:

Building 942:

- Men's bathroom, women's bathroom, food prep bathroom ceramic coated sinks
- Food prep ceramic tile baseboards
- Exterior Stucco walls

Building 940:

- All Janitor closets and bathroom 2 ceramic coated sinks

Building 960:

- Merchandise room ceramic tile walls
- All warehouse metal balustrades
- All red warehouse metal shelving
- Lobby 1 and lobby 2 ceramic tile walls
- All exterior ceramic tile walls and columns

Recommendations

The results from this inspection should be provided to any individuals that may disturb the painted surfaces. Lead levels below the HUD/RRP threshold criteria may exist on painted surfaces throughout the subject property, therefore other lead regulations may apply.

TITLE X REQUIREMENTS

A copy of this report must be provided to new lessees (tenants) and purchasers of this property under Federal law (24 CFR part 35 and 40 CFR part 745) before they become obligated under a lease or sales contract. The complete report must also be provided to new purchasers and it must be made available to new tenants*. Landlords (lessors) and sellers are also required to distribute an educational pamphlet approved by the U.S.

Environmental Protection Agency and include standard warning language in their leases or sales contracts to ensure that parents have the information they need to protect their children from lead-based paint hazards. This report should be maintained and updated as a permanent maintenance record for this property.

The lead paint determination survey described herein was conducted by the undersigned of Patriot Environmental Laboratory Services, Inc. The investigation consisted solely of the activities described in the introduction to this report.

Reviewed by:



9/26/11

Chris Blake Date
California DPH Certified LBP Inspector/ Risk Assessor, Monitor & Designer #6283

Attachments: 1) XRF Survey Data
2) Site Plan
3) Certifications
4) DPH 8552 Form



XRF Analysis Data

Serial #XL300A-25215

Site: 1920 Graeber Street
Riverside, California 92581

Date: 19-Sep-11

Reading No	COMPONENT	SUBSTRATE	SIDE	CONDITION	COLOR	ROOM	ROOM NUMBER	FLOOR	SITE ADDRESS	Results	PbC	PbC Error
1	SHUTTER_ CAL										3.7	0
2	CALIBRATE- FRONT	CALIBRATE- FRONT			RED					Positive	1.1	0.1
3	CALIBRATE- FRONT	CALIBRATE- FRONT			RED					Positive	1.1	0.1
4	CALIBRATE- FRONT	CALIBRATE- FRONT			RED					Positive	1.1	0.1
5	WNDW CASING	METAL CERAMIC	A	INTACT	BROWN	FRONT LOBBY			BLDG 942	Negative	< LOD	0.03
6	BASEBOARD	TILE CERAMIC	A	INTACT	BROWN	FRONT LOBBY			BLDG 942	Negative	< LOD	0.04
7	FLOOR	TILE	FLOOR	INTACT	BROWN	FRONT LOBBY			BLDG 942	Negative	< LOD	0.03
8	WALL VENT	METAL	CEILING	INTACT	BROWN	FRONT LOBBY			BLDG 942	Negative	< LOD	0.03
9	WALL	DRYWALL	C	INTACT	TAN	FRONT LOBBY			BLDG 942	Negative	< LOD	0.08
10	DOOR DR.	METAL	D	INTACT	BROWN	FRONT LOBBY			BLDG 942	Negative	< LOD	0.03
11	JAMB/CASING	METAL	D	INTACT	BROWN	FRONT LOBBY			BLDG 942	Negative	< LOD	0.03
12	WALL	DRYWALL	A	INTACT	TAN	DINING ROOM			BLDG 942	Negative	< LOD	0.03
13	WNDW CASING	METAL	B	INTACT	BROWN	DINING ROOM			BLDG 942	Negative	< LOD	0.03
14	WALL	DRYWALL	B	INTACT	TAN	DINING ROOM			BLDG 942	Negative	< LOD	0.03



XRF Analysis Data

Reading No	COMPONENT	SUBSTRATE	SIDE	CONDITION	COLOR	ROOM	ROOM NUMBER	FLOOR	SITE ADDRESS	Results	PbC	PbC Error
15	WALL	DRYWALL	C	INTACT	TAN	DINING ROOM			BLDG 942	Negative	< LOD	0.03
16	WALL TRIM	WOOD	C	INTACT	TAN	DINING ROOM			BLDG 942	Negative	< LOD	0.03
17	DOOR DR.	WOOD	C	INTACT	TAN	DINING ROOM			BLDG 942	Negative	< LOD	0.03
18	JAMB/CASING	WOOD CERAMIC	C	INTACT	TAN	DINING ROOM			BLDG 942	Negative	< LOD	0.04
19	WALL	TILE CERAMIC	C	INTACT	TAN	DINING ROOM			BLDG 942	Negative	< LOD	0.24
20	BASEBOARD	TILE CERAMIC	C	INTACT	TAN	DINING ROOM			BLDG 942	Negative	< LOD	0.03
21	FLOOR	TILE	FLOOR	INTACT	TAN	DINING ROOM			BLDG 942	Negative	< LOD	0.07
22	DOOR	METAL	D	INTACT	BROWN	DINING ROOM			BLDG 942	Negative	< LOD	0.03
23	DOOR	METAL	D	INTACT	BROWN	DINING ROOM			BLDG 942	Negative	< LOD	0.03
24	CEILING	WOOD	D	INTACT	TAN	LOBBY DINING ROOM			BLDG 942	Negative	< LOD	0.03
25	WALL VENT	METAL	CEILING	INTACT	TAN	LOBBY DINING ROOM			BLDG 942	Negative	< LOD	0.07
26	JOIST	WOOD	CEILING	INTACT	BROWN	DINING ROOM			BLDG 942	Negative	< LOD	0.03
27	WALL	DRYWALL	B	INTACT	TAN	HALL			BLDG 942	Negative	< LOD	0.03
28	WALL	DRYWALL	C	INTACT	TAN	HALL			BLDG 942	Negative	< LOD	0.03
29	WALL DR.	DRYWALL	D	INTACT	TAN	HALL			BLDG 942	Negative	< LOD	0.03
30	JAMB/CASING	METAL	B	INTACT	BROWN	MEN'S BATHROOM			BLDG 942	Negative	< LOD	0.03



XRF Analysis Data

Reading No	COMPONENT	SUBSTRATE	SIDE	CONDITION	COLOR	ROOM	ROOM NUMBER	FLOOR	SITE ADDRESS	Results	PbC	PbC Error
31	CEILING	DRYWALL CERAMIC	CEILING	INTACT	WHITE	MEN'S BATHROOM			BLDG 942	Negative	< LOD	0.03
32	WALL	TILE CERAMIC	A	INTACT	TAN	MEN'S BATHROOM			BLDG 942	Negative	< LOD	0.06
33	WALL	TILE CERAMIC	B	INTACT	TAN	MEN'S BATHROOM			BLDG 942	Negative	< LOD	0.1
34	WALL	TILE CERAMIC	C	INTACT	TAN	MEN'S BATHROOM			BLDG 942	Negative	< LOD	0.06
35	WALL	TILE CERAMIC	D	INTACT	TAN	MEN'S BATHROOM			BLDG 942	Negative	< LOD	0.07
36	BASEBOARD	TILE CERAMIC	D	INTACT	BROWN	MEN'S BATHROOM			BLDG 942	Negative	< LOD	0.03
37	FLOOR	TILE CERAMIC	FLOOR	INTACT	BROWN	MEN'S BATHROOM			BLDG 942	Negative	< LOD	0.03
38	SINK	COATED CERAMIC	C	INTACT	WHITE	MEN'S BATHROOM			BLDG 942	Positive	< LOD	40.2
39	URINAL	COATED CERAMIC	C	INTACT	WHITE	MEN'S BATHROOM			BLDG 942	Negative	< LOD	0.03
40	TOILET	COATED CERAMIC	C	INTACT	WHITE	MEN'S BATHROOM			BLDG 942	Negative	< LOD	0.04
41	HAND DRYER DR.	METAL	C	INTACT	WHITE	MEN'S BATHROOM			BLDG 942	Negative	< LOD	0.03
42	JAMB/CASING	METAL	A	INTACT	BROWN	WOMEN'S BATHROOM			BLDG 942	Negative	< LOD	0.03
43	CEILING	DRYWALL CERAMIC	CEILING	INTACT	WHITE	WOMEN'S BATHROOM			BLDG 942	Negative	< LOD	0.03
44	WALL	TILE CERAMIC	A	INTACT	TAN	WOMEN'S BATHROOM			BLDG 942	Negative	< LOD	0.42
45	WALL	TILE CERAMIC	B	INTACT	TAN	WOMEN'S BATHROOM			BLDG 942	Negative	< LOD	0.69
46	WALL	TILE CERAMIC	C	INTACT	TAN	WOMEN'S BATHROOM			BLDG 942	Negative	< LOD	0.23



XRF Analysis Data

Reading No	COMPONENT	SUBSTRATE	SIDE	CONDITION	COLOR	ROOM	ROOM NUMBER	FLOOR	SITE ADDRESS	Results	PbC	PbC Error
47	WALL	CERAMIC TILE	D	INTACT	TAN	WOMEN'S BATHROOM			BLDG 942	Negative	< LOD	0.13
48	JAMB/CASING	METAL CERAMIC	D	INTACT	BROWN	WOMEN'S BATHROOM			BLDG 942	Negative	< LOD	0.03
49	SINK	CERAMIC COATED	C	INTACT	WHITE	WOMEN'S BATHROOM			BLDG 942	Positive	< LOD	5.7
50	TOILET	CERAMIC COATED	D	INTACT	WHITE	WOMEN'S BATH ROOM			BLDG 942	Negative	< LOD	0.21
51	HAND DRYER	METAL CERAMIC	B	INTACT	WHITE	WOMEN'S BATH ROOM			BLDG 942	Negative	< LOD	0.03
52	BASEBOARD	TILE	B	INTACT	BROWN	WOMEN'S BATH ROOM			BLDG 942	Null	< LOD	0.15
53	BASEBOARD	CERAMIC TILE	B	INTACT	BROWN	WOMEN'S BATH ROOM			BLDG 942	Null	< LOD	0.03
54	BASEBOARD	CERAMIC TILE	B	INTACT	BROWN	WOMEN'S BATH ROOM			BLDG 942	Negative	< LOD	0.36
55	FLOOR	CERAMIC TILE	FLOOR	INTACT	BROWN	WOMEN'S BATH ROOM			BLDG 942	Negative	< LOD	0.15
56	WALL	DRYWALL	A	INTACT	TAN	CASHIER			BLDG 942	Negative	< LOD	0.03
57	WALL	DRYWALL	B	INTACT	TAN	CASHIER			BLDG 942	Negative	< LOD	0.03
58	WALL	DRYWALL	B	INTACT	TAN	CASHIER			BLDG 942	Negative	< LOD	0.03
59	WALL	DRYWALL	C	INTACT	TAN	CASHIER			BLDG 942	Negative	< LOD	0.03
60	WALL	DRYWALL	D	INTACT	TAN	CASHIER			BLDG 942	Negative	< LOD	0.03
61	DOOR	WOOD	B	INTACT	TAN	CASHIER			BLDG 942	Negative	< LOD	0.03
62	FLOOR	CERAMIC TILE	FLOOR	INTACT	RED	CASHIER			BLDG 942	Negative	< LOD	0.03
63	WALL	CERAMIC TILE	A	INTACT	TAN	CASHIER			BLDG 942	Negative	< LOD	0.11
64	WALL	CERAMIC TILE	A	INTACT	TAN	FOOD PREP			BLDG 942	Negative	< LOD	0.39
65	WALL	CERAMIC TILE	B	INTACT	TAN	FOOD PREP			BLDG 942	Negative	< LOD	0.36



XRF Analysis Data

Reading No	COMPONENT	SUBSTRATE	SIDE	CONDITION	COLOR	ROOM	ROOM NUMBER	FLOOR	SITE ADDRESS	Results	PbC	PbC Error
66	WALL	CERAMIC TILE	C	INTACT	TAN	FOOD PREP			BLDG 942	Negative	< LOD	0.17
67	WALL	CERAMIC TILE	D	INTACT	TAN	FOOD PREP			BLDG 942	Negative	< LOD	0.24
68	WALL	DRYWALL	A	INTACT	TAN	FOOD PREP			BLDG 942	Negative	< LOD	0.03
69	WNDW CASING	METAL CERAMIC	D	INTACT	BROWN	FOOD PREP			BLDG 942	Negative	< LOD	0.03
70	BASEBOARD	TILE CERAMIC	D	INTACT	RED	FOOD PREP			BLDG 942	Positive	1.5	0.5
71	FLOOR	TILE	FLOOR	INTACT	RED	FOOD PREP			BLDG 942	Negative	< LOD	0.03
72	DOOR DR.	WOOD	B	INTACT	TAN	OFFICE			BLDG 942	Negative	< LOD	0.1
73	JAMB/CASING	METAL	B	INTACT	BROWN	OFFICE			BLDG 942	Negative	< LOD	0.03
74	ELEC PANEL	METAL	C	INTACT	WHITE	OFFICE			BLDG 942	Negative	< LOD	0.03
75	ELEC PANEL	METAL	C	INTACT	GREY	OFFICE			BLDG 942	Negative	< LOD	0.03
76	ELEC PANEL	METAL	C	INTACT	SILVER	FOOD PREP			BLDG 942	Negative	< LOD	0.03
77	ELEC PANEL	METAL	D	INTACT	BEIGE	FOOD PREP			BLDG 942	Negative	< LOD	0.03
78	LADDER RUNG	METAL	CENTER	INTACT	BEIGE	FOOD PREP			BLDG 942	Negative	< LOD	0.15
79	LADDER RUNG LADDER	METAL	CENTER	INTACT	BEIGE	FOOD PREP			BLDG 942	Negative	< LOD	0.06
80	STRINGER LADDER	METAL	CENTER	INTACT	BEIGE	FOOD PREP			BLDG 942	Negative	< LOD	0.04
81	STRINGER	METAL	CENTER	INTACT	BEIGE	FOOD PREP FOOD PREP			BLDG 942	Negative	< LOD	0.37
82	DOOR DR.	WOOD	C	INTACT	BEIGE	BATH ROOM FOOD PREP			BLDG 942	Negative	< LOD	0.12
83	JAMB/CASING	METAL	C	INTACT	BROWN	BATH ROOM FOOD PREP			BLDG 942	Negative	< LOD	0.92
84	CEILING	DRYWALL	CEILING	INTACT	WHITE	BATH ROOM FOOD PREP			BLDG 942	Negative	< LOD	0.03
85	WALL	DRYWALL	A	INTACT	WHITE	BATH ROOM			BLDG 942	Negative	< LOD	0.03



XRF Analysis Data

Reading No	COMPONENT	SUBSTRATE	SIDE	CONDITION	COLOR	ROOM	ROOM NUMBER	FLOOR	SITE ADDRESS	Results	PbC	PbC Error
86	WALL	DRYWALL	B	INTACT	WHITE	FOOD PREP BATH ROOM			BLDG 942	Negative	< LOD	0.03
87	WALL	DRYWALL	C	INTACT	WHITE	FOOD PREP BATH ROOM			BLDG 942	Negative	< LOD	0.03
88	WALL	DRYWALL	D	INTACT	WHITE	FOOD PREP BATH ROOM			BLDG 942	Negative	< LOD	0.03
89	BASEBOARD	CERAMIC TILE	A	INTACT	RED	FOOD PREP BATH ROOM			BLDG 942	Negative	< LOD	0.06
90	FLOOR	CERAMIC TILE	FLOOR	INTACT	RED	FOOD PREP BATH ROOM			BLDG 942	Negative	< LOD	0.04
91	TOILET	CERAMIC COATED	D	INTACT	WHITE	FOOD PREP BATH ROOM			BLDG 942	Negative	< LOD	0.41
92	HAND DRYER	METAL CERAMIC COATED	A	INTACT	WHITE	FOOD PREP BATH ROOM FOOD PREP			BLDG 942	Negative	< LOD	0.03
93	SINK	CERAMIC COATED	B	INTACT	WHITE	BATH ROOM			BLDG 942	Positive	< LOD	36.9
94	WALL	CERAMIC TILE	A	INTACT	TAN	BACK AREA			BLDG 942	Negative	< LOD	0.23
95	WALL	CERAMIC TILE	B	INTACT	TAN	BACK AREA			BLDG 942	Negative	< LOD	0.23
96	WALL	CERAMIC TILE	B	INTACT	TAN	BACK AREA			BLDG 942	Negative	< LOD	0.65
97	WALL	CERAMIC TILE	C	INTACT	TAN	BACK AREA			BLDG 942	Negative	< LOD	0.46
98	WALL	CERAMIC TILE	D	INTACT	TAN	BACK AREA			BLDG 942	Negative	< LOD	0.34
99	BASEBOARD	CERAMIC TILE	D	INTACT	TAN	BACK AREA			BLDG 942	Null	1.4	0.5
100	BASEBOARD	CERAMIC TILE	D	INTACT	TAN	BACK AREA			BLDG 942	Null	< LOD	0.03
101	BASEBOARD	CERAMIC TILE	D	INTACT	TAN	BACK AREA			BLDG 942	Negative	< LOD	0.03



XRF Analysis Data

Reading No	COMPONENT	SUBSTRATE	SIDE	CONDITION	COLOR	ROOM	ROOM NUMBER	FLOOR	SITE ADDRESS	Results	PbC	PbC Error
102	FLOOR	CERAMIC TILE	D	INTACT	RED	BACK AREA			BLDG 942	Negative	< LOD	0.03
103	BASEBOARD DR.	CERAMIC TILE	D	INTACT	RED	BACK AREA			BLDG 942	Negative	< LOD	0.04
104	JAMB/CASING	METAL	D	INTACT	BROWN	BACK AREA			BLDG 942	Negative	< LOD	0.05
105	DOOR	METAL	D	INTACT	BROWN	BACK AREA			BLDG 942	Negative	< LOD	0.03
106	DOOR	METAL	D	INTACT	BEIGE	BACK AREA			BLDG 942	Negative	< LOD	0.1
107	ROOF HATCH	METAL	D	INTACT	BROWN	ROOF			BLDG 942	Negative	< LOD	0.04
108	ROOF HATCH EXT. UPR	METAL	D	INTACT	RED	ROOF			BLDG 942	Negative	< LOD	0.04
109	FLASHING	METAL	D	Not Intact - Peeling	BROWN	ROOF			BLDG 942	Negative	< LOD	0.03
110	EXT. UPR TRIM	WOOD	D	INTACT	BROWN	ROOF			BLDG 942	Negative	< LOD	0.03
111	EXT. UPR TRIM	METAL	D	INTACT	WHITE	ROOF			BLDG 942	Negative	< LOD	0.03
112	EXT. A/C UNIT	METAL	A	Not Intact - Peeling	RED	ROOF			BLDG 942	Negative	< LOD	0.03
113	EXT. A/C UNIT	METAL	A	Peeling	RED	ROOF			BLDG 942	Negative	< LOD	0.04
114	EXT. A/C UNIT	METAL	CENTER	INTACT	GREEN	ROOF			BLDG 942	Negative	< LOD	0.03
115	EXT. A/C UNIT	METAL	CENTER	INTACT	GREEN	ROOF			BLDG 942	Negative	< LOD	0.05
116	WALL	WOOD	B	INTACT	YELLOW	EXTERIOR			BLDG 942	Negative	< LOD	0.03
117	WALL	WOOD	C	INTACT	YELLOW	EXTERIOR			BLDG 942	Negative	< LOD	0.03
118	WALL TRIM	WOOD	C	INTACT	BROWN	ROOF			BLDG 942	Negative	< LOD	0.03
119	WALL	WOOD	D	INTACT	YELLOW	EXTERIOR			BLDG 942	Negative	< LOD	0.03
120	WNDW CASING	METAL	A	INTACT	BROWN	EXTERIOR			BLDG 942	Negative	< LOD	0.03
121	EXT. FASCIA	WOOD	A	INTACT	BROWN	EXTERIOR			BLDG 942	Negative	< LOD	0.03
122	EXT. EAVE	WOOD	A	INTACT	YELLOW	EXTERIOR			BLDG 942	Negative	< LOD	0.03



XRF Analysis Data

Reading No	COMPONENT	SUBSTRATE	SIDE	CONDITION	COLOR	ROOM	ROOM NUMBER	FLOOR	SITE ADDRESS	Results	PbC	PbC Error
123	WALL	STUCCO	D	INTACT	YELLOW	EXTERIOR			BLDG 942	Negative	< LOD	0.03
124	WALL EXT. WALL	WOOD	D	INTACT	YELLOW	EXTERIOR			BLDG 942	Negative	< LOD	0.03
125	TRIM	WOOD	D	INTACT	BROWN	EXTERIOR			BLDG 942	Negative	< LOD	0.04
126	DOOR DR.	WOOD	D	INTACT	BROWN	EXTERIOR			BLDG 942	Negative	< LOD	0.03
127	JAMB/CASING	METAL	D	INTACT	BROWN	EXTERIOR			BLDG 942	Negative	< LOD	0.03
128	PIPE	METAL	D	INTACT	BROWN	EXTERIOR			BLDG 942	Negative	< LOD	0.03
129	PIPE WATER MAIN	METAL	D	INTACT	YELLOW	EXTERIOR			BLDG 942	Negative	< LOD	0.21
130	VALVE AUTO SPRINKLER	METAL	D	INTACT	YELLOW	EXTERIOR			BLDG 942	Negative	< LOD	0.3
131	CONNECTION	METAL	D	INTACT	RED	EXTERIOR			BLDG 942	Negative	< LOD	0.27
132	WALL	STUCCO	B	INTACT	YELLOW	EXTERIOR			BLDG 942	Negative	< LOD	0.03
133	DRIVE-UP WNDW CASING	METAL	B	INTACT	BROWN	EXTERIOR			BLDG 942	Negative	< LOD	0.03
134	BALUSTRADE	METAL	B	INTACT	BROWN	EXTERIOR			BLDG 942	Negative	< LOD	0.03
135	WALL	STUCCO	C	INTACT	YELLOW	EXTERIOR			BLDG 942	Negative	< LOD	0.03
136	ELEC PANEL TRANSFORME	METAL	C	INTACT	YELLOW	EXTERIOR			BLDG 942	Negative	< LOD	0.03
137	R TRANSFORME	METAL	C	INTACT	GREY	EXTERIOR			BLDG 942	Negative	< LOD	0.03
138	R	METAL	C	INTACT	GREEN	EXTERIOR			BLDG 942	Negative	< LOD	0.03
139	DOOR	METAL	C	INTACT	BROWN	EXTERIOR			BLDG 942	Negative	< LOD	0.03



XRF Analysis Data

Reading No	COMPONENT	SUBSTRATE	SIDE	CONDITION	COLOR	ROOM	ROOM NUMBER	FLOOR	SITE ADDRESS	Results	PbC	PbC Error
140	WALL	STUCCO	A	INTACT	YELLOW	TRASH BIN			BLDG 942	Negative	< LOD	0.03
141	WALL	STUCCO	B	INTACT	YELLOW	TRASH BIN			BLDG 942	Negative	< LOD	0.03
142	WALL	STUCCO	D	INTACT	YELLOW	TRASH BIN			BLDG 942	Negative	< LOD	0.03
143	WALL	STUCCO	C	INTACT	YELLOW	TRASH BIN			BLDG 942	Positive	1.6	0.6
144	WALL	STUCCO	C	INTACT	YELLOW	TRASH BIN			BLDG 942	Negative	< LOD	0.03
145	WALL	STUCCO	C	INTACT	YELLOW	TRASH BIN			BLDG 942	Positive	1.5	0.5
146	BALUSTRADE	METAL	D	INTACT	BROWN	TRASH BIN			BLDG 942	Negative	< LOD	0.05
147	BALUSTRADE	METAL	D	INTACT	BROWN	TRASH BIN			BLDG 942	Negative	< LOD	0.08
148	BALUSTRADE	METAL	D	INTACT	BROWN	TRASH BIN			BLDG 942	Negative	< LOD	0.16
149	GATE	WOOD	D	INTACT	BEIGE	TRASH BIN			BLDG 942	Negative	< LOD	0.03
150	GATE	WOOD	D	INTACT	BROWN	TRASH BIN			BLDG 942	Negative	< LOD	0.03
151	GATE	METAL	D	INTACT	WHITE	TRASH BIN			BLDG 942	Negative	< LOD	0.35
152	GATE	WOOD	D	INTACT	WHITE	TRASH BIN			BLDG 942	Negative	< LOD	0.03
153	GATE POST	METAL CINDER BLOCK	D	Not Intact - Chalking	BROWN	TRASH BIN TRASH BIN			BLDG 942	Negative	< LOD	0.03
154	WALL	BLOCK	A	INTACT	BEIGE	INTERIOR TRASH BIN			BLDG 942	Negative	< LOD	0.03
155	WALL	STUCCO	A	INTACT	YELLOW	INTERIOR TRASH BIN			BLDG 942	Negative	< LOD	0.03
156	WALL	STUCCO CINDER BLOCK	B	INTACT	YELLOW	INTERIOR TRASH BIN			BLDG 942	Negative	< LOD	0.03
157	WALL	BLOCK CINDER BLOCK	B	INTACT	BEIGE	INTERIOR TRASH BIN			BLDG 942	Negative	< LOD	0.03
158	WALL	BLOCK	C	INTACT	BEIGE	INTERIOR			BLDG 942	Negative	< LOD	0.03



XRF Analysis Data

Reading No	COMPONENT	SUBSTRATE	SIDE	CONDITION	COLOR	ROOM	ROOM NUMBER	FLOOR	SITE ADDRESS	Results	PbC	PbC Error
159	WALL	CINDER BLOCK	D	INTACT	BEIGE	TRASH BIN INTERIOR			BLDG 942	Negative	< LOD	0.03
160	BALUSTRADE	METAL	CENTER	Not Intact - Peeling	GREY	TRASH BIN INTERIOR			BLDG 942	Negative	< LOD	0.14
161	BALUSTRADE DR.	METAL	CENTER	Not Intact - Peeling	GREY	TRASH BIN INTERIOR			BLDG 942	Negative	< LOD	0.05
162	JAMB/CASING	METAL	A	INTACT	BROWN	BED ROOM	307		BLDG 940	Negative	< LOD	0.07
163	WALL	DRYWALL	A	INTACT	WHITE	BED ROOM	307		BLDG 940	Negative	< LOD	0.03
164	WALL	DRYWALL	B	INTACT	WHITE	BED ROOM	307		BLDG 940	Negative	< LOD	0.03
165	WALL	DRYWALL	C	INTACT	WHITE	BED ROOM	307		BLDG 940	Negative	< LOD	0.03
166	WALL	DRYWALL	D	INTACT	PURPLE	BED ROOM	307		BLDG 940	Negative	< LOD	0.03
167	CEILING	ACOUSTIC	CEILING	INTACT	WHITE	BED ROOM	307		BLDG 940	Negative	< LOD	0.03
168	CEILING	DRYWALL	CEILING	INTACT	WHITE	BATH ROOM	307		BLDG 940	Negative	< LOD	0.03
169	WALL	DRYWALL	A	INTACT	WHITE	BATH ROOM	307		BLDG 940	Negative	< LOD	0.03
170	WALL	DRYWALL	B	INTACT	WHITE	BATH ROOM	307		BLDG 940	Negative	< LOD	0.03
171	WALL	DRYWALL	C	INTACT	WHITE	BATH ROOM	307		BLDG 940	Negative	< LOD	0.03
172	WALL	DRYWALL	D	INTACT	WHITE	BATH ROOM	307		BLDG 940	Negative	< LOD	0.03
173	FLOOR	CERAMIC TILE	FLOOR	INTACT	BEIGE	BATH ROOM	307		BLDG 940	Negative	< LOD	0.03
174	TOILET DR.	CERAMIC COATED	A	INTACT	WHITE	BATH ROOM	307		BLDG 940	Negative	< LOD	0.22
175	JAMB/CASING	METAL	D	INTACT	BROWN	BATH ROOM	307		BLDG 940	Negative	< LOD	0.05
176	WNDW CASING	METAL	A	INTACT	BROWN	BATH ROOM	307		BLDG 940	Negative	< LOD	0.03
177	WNDW CASING DR.	METAL	A	INTACT	BROWN	BED ROOM	325		BLDG 940	Negative	< LOD	0.03
178	JAMB/CASING	METAL	A	INTACT	BROWN	BED ROOM	325		BLDG 940	Negative	< LOD	0.08
179	CEILING	ACOUSTIC	CEILING	INTACT	WHITE	BED ROOM	325		BLDG 940	Negative	< LOD	0.03
180	WALL	DRYWALL	A	INTACT	WHITE	BED ROOM	325		BLDG 940	Negative	< LOD	0.05



XRF Analysis Data

Reading No	COMPONENT	SUBSTRATE	SIDE	CONDITION	COLOR	ROOM	ROOM NUMBER	FLOOR	SITE ADDRESS	Results	PbC	PbC Error
181	WALL	DRYWALL	B	INTACT	WHITE	BED ROOM	325		BLDG 940	Negative	< LOD	0.04
182	WALL	DRYWALL	C	INTACT	WHITE	BED ROOM	325		BLDG 940	Negative	< LOD	0.05
183	WALL	DRYWALL CERAMIC	D	INTACT	WHITE	BED ROOM	325		BLDG 940	Negative	< LOD	0.03
184	SINK DR.	COATED	C	INTACT	WHITE	BED ROOM	325		BLDG 940	Negative	< LOD	1.16
185	JAMB/CASING	METAL CERAMIC	A	INTACT	BROWN	BATH ROOM	325		BLDG 940	Negative	< LOD	0.03
186	FLOOR	TILE	FLOOR	INTACT	BEIGE	BATH ROOM	325		BLDG 940	Negative	< LOD	0.05
187	CEILING	DRYWALL	CEILING	INTACT	WHITE	BATH ROOM	325		BLDG 940	Null	< LOD	0.03
188	CEILING	PLASTER	CEILING	INTACT	WHITE	BATH ROOM	325		BLDG 940	Negative	< LOD	0.03
189	WALL	PLASTER	A	INTACT	WHITE	BATH ROOM	325		BLDG 940	Negative	< LOD	0.07
190	WALL	PLASTER	B	INTACT	WHITE	BATH ROOM	325		BLDG 940	Negative	< LOD	0.04
191	WALL	PLASTER	C	INTACT	WHITE	BATH ROOM	325		BLDG 940	Negative	< LOD	0.24
192	WALL	PLASTER	D	INTACT	WHITE	BATH ROOM	325		BLDG 940	Negative	< LOD	0.05
193	JAMB/CASING	METAL	A	INTACT	BROWN	BATH ROOM	313		BLDG 940	Negative	< LOD	0.22
194	WNDW CASING	METAL	A	INTACT	BROWN	BATH ROOM	313		BLDG 940	Negative	< LOD	0.03
195	CEILING	ACOUSTIC	CEILING	INTACT	WHITE	BATH ROOM	313		BLDG 940	Null	< LOD	0.39
196	CEILING	ACOUSTIC	CEILING	INTACT	WHITE	BATH ROOM	313		BLDG 940	Negative	< LOD	0.03
197	WALL	DRYWALL	A	INTACT	WHITE	BED ROOM	313		BLDG 940	Negative	< LOD	0.05
198	WALL	DRYWALL	B	INTACT	BLUE	BED ROOM	313		BLDG 940	Negative	< LOD	0.07
199	WALL	DRYWALL	C	INTACT	WHITE	BED ROOM	313		BLDG 940	Negative	< LOD	0.03
200	WALL	DRYWALL	D	INTACT	WHITE	BED ROOM	313		BLDG 940	Negative	< LOD	1.28
201	SINK DR.	COATED	C	INTACT	WHITE	BED ROOM	313		BLDG 940	Negative	< LOD	1.37
202	JAMB/CASING	METAL CERAMIC	A	INTACT	BROWN	BATH ROOM	313		BLDG 940	Negative	< LOD	0.03
203	FLOOR	TILE	FLOOR	INTACT	BEIGE	BATH ROOM	313		BLDG 940	Negative	< LOD	0.03



XRF Analysis Data

Reading No	COMPONENT	SUBSTRATE	SIDE	CONDITION	COLOR	ROOM	ROOM NUMBER	FLOOR	SITE ADDRESS	Results	PbC	PbC Error
204	CEILING	PLASTER CERAMIC	CEILING	INTACT	WHITE	BATH ROOM	313		BLDG 940	Negative	< LOD	0.03
205	TOILET	COATED	D	INTACT	WHITE	BATH ROOM	313		BLDG 940	Negative	< LOD	0.03
206	WALL	PLASTER	A	INTACT	WHITE	BATH ROOM	313		BLDG 940	Negative	< LOD	0.03
207	WALL	PLASTER	B	INTACT	WHITE	BATH ROOM	313		BLDG 940	Negative	< LOD	0.03
208	WALL	PLASTER	C	INTACT	WHITE	BATH ROOM	313		BLDG 940	Negative	< LOD	0.03
209	WALL	PLASTER	D	INTACT	WHITE	BATH ROOM	313		BLDG 940	Negative	< LOD	0.06
210	WALL	DRYWALL	A	INTACT	WHITE	HALL	LOUNGE	3rd	BLDG 940	Negative	< LOD	0.03
211	WALL	DRYWALL	B	INTACT	WHITE	HALL	LOUNGE	3rd	BLDG 940	Negative	< LOD	0.05
212	WALL	DRYWALL	C	INTACT	WHITE	HALL	LOUNGE	3rd	BLDG 940	Negative	< LOD	0.03
213	WALL	DRYWALL	D	INTACT	WHITE	HALL	LOUNGE	3rd	BLDG 940	Negative	< LOD	0.06
214	CEILING DR.	ACOUSTIC	CEILING	INTACT	WHITE	HALL	LOUNGE	3rd	BLDG 940	Negative	< LOD	0.03
215	JAMB/CASING DR.	METAL	A	INTACT	BROWN	HALL	LOUNGE	3rd	BLDG 940	Negative	< LOD	0.03
216	JAMB/CASING	METAL	A	INTACT	BROWN	STORAGE 1	LOUNGE	3rd	BLDG 940	Negative	< LOD	0.14
217	CEILING	ACOUSTIC	CEILING	INTACT	WHITE	STORAGE 1	LOUNGE	3rd	BLDG 940	Negative	< LOD	0.03
218	WALL	DRYWALL	A	INTACT	WHITE	STORAGE 1	LOUNGE	3rd	BLDG 940	Negative	< LOD	0.03
219	WALL	CONCRETE	A	INTACT	WHITE	STORAGE 1	LOUNGE	3rd	BLDG 940	Negative	< LOD	0.03
220	WALL	DRYWALL	B	INTACT	WHITE	STORAGE 1	LOUNGE	3rd	BLDG 940	Negative	< LOD	0.03
221	WALL	DRYWALL	C	INTACT	WHITE	STORAGE 1	LOUNGE	3rd	BLDG 940	Negative	< LOD	0.03
222	WALL	DRYWALL	D	INTACT	WHITE	STORAGE 1	LOUNGE	3rd	BLDG 940	Negative	< LOD	0.06
223	COLUMN DR.	CONCRETE	CENTER	INTACT	WHITE	STORAGE 1	LOUNGE	3rd	BLDG 940	Negative	< LOD	0.07
224	JAMB/CASING DR.	METAL	B	INTACT	BROWN	STORAGE 1 JANITOR	LOUNGE	3rd	BLDG 940	Negative	< LOD	0.03
225	JAMB/CASING	METAL	A	INTACT	BROWN	CLOSET JANITOR	LOUNGE	3rd	BLDG 940	Negative	< LOD	0.05
226	WALL	PLASTER	A	INTACT	WHITE	CLOSET	LOUNGE	3rd	BLDG 940	Negative	< LOD	0.03



XRF Analysis Data

Reading No	COMPONENT	SUBSTRATE	SIDE	CONDITION	COLOR	ROOM	ROOM NUMBER	FLOOR	SITE ADDRESS	Results	PbC	PbC Error
227	WALL	PLASTER	B	INTACT	WHITE	JANITOR CLOSET	LOUNGE	3rd	BLDG 940	Negative	< LOD	0.03
228	WALL	PLASTER	C	INTACT	WHITE	JANITOR CLOSET	LOUNGE	3rd	BLDG 940	Negative	< LOD	0.04
229	WALL	PLASTER	D	INTACT	WHITE	JANITOR CLOSET	LOUNGE	3rd	BLDG 940	Negative	< LOD	0.03
230	CEILING	PLASTER	CEILING	INTACT	WHITE	JANITOR CLOSET	LOUNGE	3rd	BLDG 940	Negative	< LOD	0.03
231	SINK DR.	CERAMIC COATED	FLOOR	INTACT	WHITE	CLOSET	LOUNGE	3rd	BLDG 940	Positive	< LOD	8.25
232	JAMB/CASING	METAL	A	INTACT	BROWN	ACCESS ROOF	LOUNGE	3rd	BLDG 940	Negative	< LOD	0.12
233	WALL	DRYWALL	A	INTACT	BLUE	ACCESS ROOF	LOUNGE	3rd	BLDG 940	Negative	< LOD	0.05
234	WALL	DRYWALL	B	INTACT	BLUE	ACCESS ROOF	LOUNGE	3rd	BLDG 940	Negative	< LOD	0.03
235	WALL	DRYWALL	C	INTACT	BLUE	ACCESS ROOF	LOUNGE	3rd	BLDG 940	Negative	< LOD	0.03
236	WALL	DRYWALL	D	INTACT	BLUE	ACCESS ROOF	LOUNGE	3rd	BLDG 940	Negative	< LOD	0.08
237	CEILING	DRYWALL	CEILING	INTACT	BLUE	ACCESS ROOF	LOUNGE	3rd	BLDG 940	Negative	< LOD	0.17
238	LADDER RUNG	METAL	A	INTACT	WHITE	ACCESS ROOF	LOUNGE	3rd	BLDG 940	Negative	0.5	0.3
239	LADDER RUNG	METAL	A	INTACT	WHITE	ACCESS ROOF	LOUNGE	3rd	BLDG 940	Negative	0.5	0.3
240	LADDER STRINGER	METAL	A	INTACT	WHITE	ACCESS ROOF	LOUNGE	3rd	BLDG 940	Negative	< LOD	0.24
241	LADDER STRINGER	METAL	A	INTACT	WHITE	ACCESS ROOF	LOUNGE	3rd	BLDG 940	Negative	< LOD	0.36
242	COLUMN	CONCRETE	B	INTACT	BLUE	ACCESS	LOUNGE	3rd	BLDG 940	Negative	< LOD	0.03



XRF Analysis Data

Reading No	COMPONENT	SUBSTRATE	SIDE	CONDITION	COLOR	ROOM	ROOM NUMBER	FLOOR	SITE ADDRESS	Results	PbC	PbC Error
						ROOF						
243	WALL	WOOD	C	INTACT	BROWN	ACCESS	LOUNGE	3rd	BLDG 940	Negative	< LOD	0.03
244	WALL	DRYWALL	A	INTACT	WHITE	LOUNGE	LOUNGE	3rd	BLDG 940	Negative	< LOD	0.03
245	WALL	DRYWALL	B	INTACT	BLUE	LOUNGE	LOUNGE	3rd	BLDG 940	Negative	< LOD	0.08
246	WALL	DRYWALL	C	INTACT	WHITE	LOUNGE	LOUNGE	3rd	BLDG 940	Negative	< LOD	0.03
247	WALL	DRYWALL	D	INTACT	WHITE	LOUNGE	LOUNGE	3rd	BLDG 940	Negative	< LOD	0.03
248	WNDW CASING DR.	METAL	C	INTACT	BROWN	LOUNGE	LOUNGE	3rd	BLDG 940	Negative	< LOD	0.85
249	JAMB/CASING	METAL	C	INTACT	BROWN	LOUNGE	LOUNGE	3rd	BLDG 940	Negative	< LOD	0.03
250	CEILING	ACOUSTIC	CEILING	INTACT	WHITE	LOUNGE	LOUNGE	3rd	BLDG 940	Negative	< LOD	0.75
251	COLUMN	CONCRETE	D	INTACT	WHITE	LOUNGE	LOUNGE	3rd	BLDG 940	Negative	< LOD	0.06
252	WALL	DRYWALL	A	INTACT	WHITE	STAIR WELL		2nd	BLDG 940	Negative	< LOD	0.03
253	WALL	PLASTER	B	INTACT	WHITE	STAIR WELL		2nd	BLDG 940	Negative	< LOD	0.03
254	WALL	CONCRETE	C	INTACT	WHITE	STAIR WELL		2nd	BLDG 940	Negative	< LOD	0.05
255	WALL	PLASTER	D	INTACT	WHITE	STAIR WELL		2nd	BLDG 940	Negative	< LOD	0.03
256	WALL	PLASTER	D	INTACT	BLUE	STAIR WELL		2nd	BLDG 940	Negative	< LOD	0.03
257	CEILING	CONCRETE	CEILING	INTACT	BLUE	STAIR WELL		2nd	BLDG 940	Negative	< LOD	0.03
258	STR STRINGER	CONCRETE	CENTER	INTACT	WHITE	STAIR WELL		2nd	BLDG 940	Negative	< LOD	0.06
259	STR BALUSTER	METAL	CENTER	INTACT	BROWN	STAIR WELL		2nd	BLDG 940	Negative	0.9	0.1
260	STR RAIL	METAL	CENTER	INTACT	BROWN	STAIR WELL		2nd	BLDG 940	Negative	< LOD	0.27
261	STR RAIL	METAL	B	INTACT	BROWN	STAIR WELL		2nd	BLDG 940	Negative	0.5	0.3
262	STR RAIL	METAL	D	INTACT	BROWN	STAIR WELL		2nd	BLDG 940	Null	1	0.2
263	STR RAIL	METAL	D	INTACT	BROWN	STAIR WELL		2nd	BLDG 940	Negative	0.8	0.2
	DR.											
264	JAMB/CASING	METAL	B	INTACT	BROWN	STAIR WELL		2nd	BLDG 940	Negative	< LOD	0.04



XRF Analysis Data

Reading No	COMPONENT	SUBSTRATE	SIDE	CONDITION	COLOR	ROOM	ROOM NUMBER	FLOOR	SITE ADDRESS	Results	PbC	PbC Error
	DR.											
265	JAMB/CASING	METAL	A	INTACT	BROWN	BED ROOM	109	1st	BLDG 940	Negative	< LOD	0.03
266	WNDW CASING	METAL	A	INTACT	BROWN	BED ROOM	109	1st	BLDG 940	Negative	< LOD	0.03
267	CEILING	ACOUSTIC	CEILING	INTACT	WHITE	BED ROOM	109	1st	BLDG 940	Negative	< LOD	0.03
268	WALL	DRYWALL	A	INTACT	WHITE	BED ROOM	109	1st	BLDG 940	Negative	< LOD	0.03
269	WALL	DRYWALL	B	INTACT	WHITE	BED ROOM	109	1st	BLDG 940	Negative	< LOD	0.03
270	WALL	DRYWALL	C	INTACT	WHITE	BED ROOM	109	1st	BLDG 940	Negative	< LOD	0.03
271	WALL	DRYWALL	D	INTACT	WHITE	BED ROOM	109	1st	BLDG 940	Negative	< LOD	0.03
		CERAMIC										
272	SINK	COATED	C	INTACT	WHITE	BED ROOM	109	1st	BLDG 940	Negative	< LOD	0.03
	DR.											
273	JAMB/CASING	METAL	A	INTACT	BLACK	BATH ROOM	109	1st	BLDG 940	Negative	< LOD	0.09
		CERAMIC										
274	FLOOR	TILE	FLOOR	INTACT	BEIGE	BATH ROOM	109	1st	BLDG 940	Negative	< LOD	0.09
		CERAMIC										
275	TOILET	COATED	D	INTACT	WHITE	BATH ROOM	109	1st	BLDG 940	Negative	< LOD	0.06
276	CEILING	PLASTER	CEILING	INTACT	WHITE	BATH ROOM	109	1st	BLDG 940	Negative	< LOD	0.03
277	WALL	PLASTER	A	INTACT	WHITE	BATH ROOM	109	1st	BLDG 940	Negative	< LOD	0.05
278	WALL	PLASTER	B	INTACT	WHITE	BATH ROOM	109	1st	BLDG 940	Negative	< LOD	0.03
279	WALL	PLASTER	C	INTACT	WHITE	BATH ROOM	109	1st	BLDG 940	Negative	< LOD	0.03
280	WALL	PLASTER	D	INTACT	WHITE	BATH ROOM	109	1st	BLDG 940	Negative	< LOD	0.03
	DR.											
281	JAMB/CASING	METAL	A	INTACT	WHITE	BED ROOM	110	1st	BLDG 940	Negative	< LOD	0.21
282	WNDW CASING	METAL	A	INTACT	WHITE	BED ROOM	110	1st	BLDG 940	Negative	< LOD	0.03
283	CEILING	ACOUSTIC	CEILING	INTACT	WHITE	BED ROOM	110	1st	BLDG 940	Negative	< LOD	0.03
284	WALL	DRYWALL	A	INTACT	WHITE	BED ROOM	110	1st	BLDG 940	Negative	< LOD	0.03
					AQUA							
285	WALL	DRYWALL	B	INTACT	BLUE	BED ROOM	110	1st	BLDG 940	Negative	< LOD	0.03
286	WALL	DRYWALL	C	INTACT	WHITE	BED ROOM	110	1st	BLDG 940	Negative	< LOD	0.03
287	WALL	DRYWALL	D	INTACT	WHITE	BED ROOM	110	1st	BLDG 940	Negative	< LOD	0.03



XRF Analysis Data

Reading No	COMPONENT	SUBSTRATE	SIDE	CONDITION	COLOR	ROOM	ROOM NUMBER	FLOOR	SITE ADDRESS	Results	PbC	PbC Error
288	SINK DR.	CERAMIC COATED	C	INTACT	WHITE	BED ROOM	110	1st	BLDG 940	Negative	< LOD	0.04
289	JAMB/CASING	METAL CERAMIC	C	INTACT	BROWN	BATH ROOM	110	1st	BLDG 940	Negative	< LOD	0.03
290	FLOOR	TILE CERAMIC	FLOOR	INTACT	BEIGE	BATH ROOM	110	1st	BLDG 940	Negative	< LOD	0.23
291	TOILET	COATED	B	INTACT	WHITE	BATH ROOM	110	1st	BLDG 940	Negative	< LOD	0.05
292	WALL	PLASTER	A	INTACT	WHITE	BATH ROOM	110	1st	BLDG 940	Negative	< LOD	0.03
293	WALL	PLASTER	B	INTACT	WHITE	BATH ROOM	110	1st	BLDG 940	Negative	< LOD	0.03
294	WALL	PLASTER	C	INTACT	WHITE	BATH ROOM	110	1st	BLDG 940	Negative	< LOD	0.03
295	WALL	PLASTER	D	INTACT	WHITE	BATH ROOM	110	1st	BLDG 940	Negative	< LOD	0.03
296	CEILING	PLASTER	CEILING	INTACT	WHITE	BATH ROOM	110	1st	BLDG 940	Negative	< LOD	0.03
297	CEILING	PLASTER	CEILING	INTACT	WHITE	BATH ROOM	115	1st	BLDG 940	Negative	< LOD	0.03
298	FLOOR	CERAMIC TILE	FLOOR	INTACT	BEIGE	BATH ROOM	115	1st	BLDG 940	Negative	< LOD	0.03
299	TOILET	COATED	B	INTACT	WHITE	BATH ROOM	115	1st	BLDG 940	Negative	< LOD	0.1
300	WALL	PLASTER	A	INTACT	WHITE	BATH ROOM	115	1st	BLDG 940	Negative	< LOD	0.04
301	WALL	PLASTER	B	INTACT	WHITE	BATH ROOM	115	1st	BLDG 940	Negative	< LOD	0.03
302	WALL	PLASTER	C	INTACT	WHITE	BATH ROOM	115	1st	BLDG 940	Negative	< LOD	0.03
303	WALL	PLASTER	D	INTACT	WHITE	BATH ROOM	115	1st	BLDG 940	Negative	< LOD	0.03
304	JAMB/CASING DR.	METAL	A	INTACT	BROWN	BATH ROOM	115	1st	BLDG 940	Negative	< LOD	0.07
305	JAMB/CASING	METAL	A	INTACT	BROWN	BED ROOM	115	1st	BLDG 940	Negative	< LOD	0.11
306	WNDW CASING	METAL	A	INTACT	BROWN	BED ROOM	115	1st	BLDG 940	Negative	< LOD	0.03
307	CEILING	ACOUSTIC	CEILING	INTACT	WHITE	BED ROOM	115	1st	BLDG 940	Negative	< LOD	0.03
308	WALL	DRYWALL	A	INTACT	WHITE	BED ROOM	115	1st	BLDG 940	Negative	< LOD	0.03
309	WALL	DRYWALL	B	INTACT	LGHT BLUE	BED ROOM	115	1st	BLDG 940	Negative	< LOD	0.03



XRF Analysis Data

Reading No	COMPONENT	SUBSTRATE	SIDE	CONDITION	COLOR	ROOM	ROOM NUMBER	FLOOR	SITE ADDRESS	Results	PbC	PbC Error
310	WALL	DRYWALL	D	INTACT	LGHT BLUE	BED ROOM	115	1st	BLDG 940	Negative	< LOD	0.03
311	WALL	DRYWALL CERAMIC COATED	C	INTACT	WHITE	BED ROOM	115	1st	BLDG 940	Negative	< LOD	0.03
312	SINK DR.	DRYWALL CERAMIC COATED	C	INTACT	WHITE	BED ROOM	115	1st	BLDG 940	Negative	< LOD	0.09
313	JAMB/CASING	METAL	A	INTACT	BROWN	HALL	LOUNGE	2nd	BLDG 940	Negative	< LOD	0.09
314	WALL	DRYWALL	A	INTACT	WHITE	HALL	LOUNGE	2nd	BLDG 940	Negative	< LOD	0.04
315	WALL	DRYWALL	B	INTACT	WHITE	HALL	LOUNGE	2nd	BLDG 940	Negative	< LOD	0.03
316	WALL	DRYWALL	D	INTACT	WHITE	HALL	LOUNGE	2nd	BLDG 940	Negative	< LOD	0.03
317	CEILING DR.	ACOUSTIC	CEILING	INTACT	WHITE	HALL	LOUNGE	2nd	BLDG 940	Negative	< LOD	0.03
318	JAMB/CASING DR.	METAL	D	INTACT	BROWN	STORAGE 1	LOUNGE	2nd	BLDG 940	Negative	< LOD	0.05
319	JAMB/CASING	METAL	A	INTACT	BROWN	STORAGE 1	LOUNGE	2nd	BLDG 940	Negative	< LOD	0.04
320	CEILING	ACOUSTIC	CEILING	INTACT	WHITE	STORAGE 1	LOUNGE	2nd	BLDG 940	Negative	< LOD	0.03
321	COLUMN	CONCRETE	CENTER	INTACT	WHITE	STORAGE 1	LOUNGE	2nd	BLDG 940	Negative	< LOD	0.03
322	WALL	DRYWALL	A	INTACT	WHITE	STORAGE 1	LOUNGE	2nd	BLDG 940	Negative	< LOD	0.03
323	WALL	DRYWALL	B	INTACT	WHITE	STORAGE 1	LOUNGE	2nd	BLDG 940	Negative	< LOD	0.03
324	WALL	DRYWALL	C	INTACT	WHITE	STORAGE 1	LOUNGE	2nd	BLDG 940	Negative	< LOD	0.03
325	WALL	DRYWALL	D	INTACT	WHITE	STORAGE 1	LOUNGE	2nd	BLDG 940	Negative	< LOD	0.03
326	WALL	DRYWALL	D	INTACT	BLUE	STORAGE 2	LOUNGE	2nd	BLDG 940	Negative	< LOD	0.03
327	WALL	DRYWALL	C	INTACT	BLUE	STORAGE 2	LOUNGE	2nd	BLDG 940	Negative	< LOD	0.03
328	WALL	DRYWALL	B	INTACT	BLUE	STORAGE 2	LOUNGE	2nd	BLDG 940	Negative	< LOD	0.03
329	WALL	DRYWALL	A	INTACT	BLUE	STORAGE 2	LOUNGE	2nd	BLDG 940	Negative	< LOD	0.03
330	CEILING DR.	ACOUSTIC	CEILING	INTACT	WHITE	STORAGE 2	LOUNGE	2nd	BLDG 940	Negative	< LOD	0.03
331	JAMB/CASING DR.	METAL	B	INTACT	BROWN	STORAGE 2 JANITOR	LOUNGE	2nd	BLDG 940	Negative	< LOD	0.04
332	JAMB/CASING	METAL	B	INTACT	BROWN	CLOSET	LOUNGE	2nd	BLDG 940	Negative	< LOD	0.08



XRF Analysis Data

Reading No	COMPONENT	SUBSTRATE	SIDE	CONDITION	COLOR	ROOM	ROOM NUMBER	FLOOR	SITE ADDRESS	Results	PbC	PbC Error
333	SINK	CERAMIC COATED	D	INTACT	WHITE	JANITOR CLOSET	LOUNGE	2nd	BLDG 940	Positive	< LOD	7.65
334	WALL	PLASTER	D	INTACT	WHITE	JANITOR CLOSET	LOUNGE	2nd	BLDG 940	Negative	< LOD	0.03
335	WALL	PLASTER	C	INTACT	WHITE	JANITOR CLOSET	LOUNGE	2nd	BLDG 940	Negative	< LOD	0.03
336	WALL	PLASTER	B	INTACT	WHITE	JANITOR CLOSET	LOUNGE	2nd	BLDG 940	Negative	< LOD	0.03
337	WALL	PLASTER	A	INTACT	WHITE	JANITOR CLOSET	LOUNGE	2nd	BLDG 940	Negative	< LOD	0.03
338	CEILING	ACOUSTIC	CEILING	INTACT	WHITE	JANITOR CLOSET	LOUNGE	2nd	BLDG 940	Negative	< LOD	0.03
339	ELEC PANEL	METAL	C	INTACT	GREY	ELEC ROOM	LOUNGE	2nd	BLDG 940	Negative	< LOD	0.03
340	ELEC PANEL	METAL	C	INTACT	GREY	ELEC ROOM	LOUNGE	2nd	BLDG 940	Negative	< LOD	0.03
341	JAMB/CASING DR.	METAL	B	INTACT	BROWN	ELEC ROOM	LOUNGE	2nd	BLDG 940	Negative	< LOD	0.03
342	JAMB/CASING DR.	METAL	C	INTACT	BROWN	LOUNGE	LOUNGE	2nd	BLDG 940	Negative	< LOD	0.03
343	WNDW CASING	METAL	C	INTACT	BROWN	LOUNGE	LOUNGE	2nd	BLDG 940	Negative	< LOD	0.86
344	WALL HEATER	METAL	C	INTACT	BEIGE	LOUNGE	LOUNGE	2nd	BLDG 940	Negative	< LOD	0.08
345	CEILING	ACOUSTIC	CEILING	INTACT	WHITE	LOUNGE	LOUNGE	2nd	BLDG 940	Negative	< LOD	0.03
346	WALL	DRYWALL	A	INTACT	WHITE	LOUNGE	LOUNGE	2nd	BLDG 940	Negative	< LOD	0.03
347	WALL	DRYWALL	C	INTACT	WHITE	LOUNGE	LOUNGE	2nd	BLDG 940	Negative	< LOD	0.03
348	WALL	DRYWALL	B	INTACT	WHITE	LOUNGE	LOUNGE	2nd	BLDG 940	Negative	< LOD	0.03
349	WALL	DRYWALL	D	INTACT	WHITE	LOUNGE	LOUNGE	2nd	BLDG 940	Negative	< LOD	0.03
350	WALL	DRYWALL	D	INTACT	PINK	LOUNGE	LOUNGE	2nd	BLDG 940	Negative	< LOD	0.03
351	WALL	DRYWALL	C	INTACT	PINK	LOUNGE	LOUNGE	2nd	BLDG 940	Negative	< LOD	0.03
352	JAMB/CASING DR.	METAL	A	INTACT	BROWN	BED ROOM	214	2nd	BLDG 940	Negative	< LOD	0.05
353	WNDW CASING	METAL	A	INTACT	BROWN	BED ROOM	214	2nd	BLDG 940	Negative	< LOD	0.03



XRF Analysis Data

Reading No	COMPONENT	SUBSTRATE	SIDE	CONDITION	COLOR	ROOM	ROOM NUMBER	FLOOR	SITE ADDRESS	Results	PbC	PbC Error
354	CEILING	ACOUSTIC	CEILING	INTACT	WHITE	BED ROOM	214	2nd	BLDG 940	Negative	< LOD	0.03
355	WALL	DRYWALL	A	INTACT	GREY	BED ROOM	214	2nd	BLDG 940	Negative	< LOD	0.03
356	WALL	DRYWALL	C	INTACT	GREY	BED ROOM	214	2nd	BLDG 940	Negative	< LOD	0.1
357	WALL	DRYWALL	B	INTACT	GREEN	BED ROOM	214	2nd	BLDG 940	Negative	< LOD	0.03
358	WALL	DRYWALL	D	INTACT	WHITE	BED ROOM	214	2nd	BLDG 940	Negative	< LOD	0.03
359	SINK DR.	CERAMIC COATED	C	INTACT	WHITE	BED ROOM	214	2nd	BLDG 940	Negative	< LOD	0.03
360	JAMB/CASING	METAL CERAMIC	C	INTACT	BROWN	BATH ROOM	214	2nd	BLDG 940	Negative	< LOD	0.08
361	FLOOR	TILE	FLOOR	INTACT	BEIGE	BATH ROOM	214	2nd	BLDG 940	Negative	< LOD	0.04
362	CEILING	PLASTER	CEILING	INTACT	WHITE	BATH ROOM	214	2nd	BLDG 940	Negative	< LOD	0.03
363	WALL	PLASTER	A	INTACT	WHITE	BATH ROOM	214	2nd	BLDG 940	Negative	< LOD	0.03
364	WALL	PLASTER	B	INTACT	WHITE	BATH ROOM	214	2nd	BLDG 940	Negative	< LOD	0.03
365	WALL	PLASTER	C	INTACT	WHITE	BATH ROOM	214	2nd	BLDG 940	Negative	< LOD	0.03
366	WALL	PLASTER	D	INTACT	WHITE	BATH ROOM	214	2nd	BLDG 940	Negative	< LOD	0.03
367	TOILET DR.	CERAMIC COATED	D	INTACT	WHITE	BATH ROOM	214	2nd	BLDG 940	Negative	< LOD	0.06
368	JAMB/CASING	METAL	A	INTACT	BROWN	BED ROOM	223	2nd	BLDG 940	Negative	< LOD	0.06
369	WNDW CASING	METAL	A	INTACT	BROWN	BED ROOM	223	2nd	BLDG 940	Negative	< LOD	0.03
370	CEILING	ACOUSTIC CERAMIC	CEILING	INTACT	WHITE	BED ROOM	223	2nd	BLDG 940	Negative	< LOD	0.03
371	SINK	COATED	C	INTACT	WHITE	BED ROOM	223	2nd	BLDG 940	Negative	< LOD	0.03
372	WALL	DRYWALL	A	INTACT	WHITE	BED ROOM	223	2nd	BLDG 940	Negative	< LOD	0.03
373	WALL	DRYWALL	B	INTACT	BROWN	BED ROOM	223	2nd	BLDG 940	Negative	< LOD	0.03
374	WALL	DRYWALL	C	INTACT	GREY	BED ROOM	223	2nd	BLDG 940	Negative	< LOD	0.03
375	WALL	DRYWALL	D	INTACT	GREY	BED ROOM	223	2nd	BLDG 940	Negative	< LOD	0.03
376	WALL	PLASTER	D	INTACT	WHITE	BATH ROOM	223	2nd	BLDG 940	Negative	< LOD	0.03
377	WALL	PLASTER	C	INTACT	WHITE	BATH ROOM	223	2nd	BLDG 940	Negative	< LOD	0.09
378	WALL	PLASTER	B	INTACT	WHITE	BATH ROOM	223	2nd	BLDG 940	Negative	< LOD	0.08



XRF Analysis Data

Reading No	COMPONENT	SUBSTRATE	SIDE	CONDITION	COLOR	ROOM	ROOM NUMBER	FLOOR	SITE ADDRESS	Results	PbC	PbC Error
379	WALL	PLASTER	A	INTACT	WHITE	BATH ROOM	223	2nd	BLDG 940	Negative	< LOD	0.03
380	CEILING	PLASTER CERAMIC	CEILING	INTACT	WHITE	BATH ROOM	223	2nd	BLDG 940	Negative	< LOD	0.03
381	FLOOR	TILE CERAMIC	FLOOR	INTACT	BEIGE	BATH ROOM	223	2nd	BLDG 940	Negative	< LOD	0.03
382	TOILET DR.	COATED	D	INTACT	WHITE	BATH ROOM	223	2nd	BLDG 940	Negative	< LOD	0.07
383	JAMB/CASING DR.	METAL	C	INTACT	BROWN	BATH ROOM	223	2nd	BLDG 940	Negative	< LOD	0.03
384	JAMB/CASING	METAL	A	INTACT	BROWN	BED ROOM	222	2nd	BLDG 940	Negative	< LOD	0.03
385	WNDW CASING	METAL	A	INTACT	BROWN	BED ROOM	222	2nd	BLDG 940	Negative	< LOD	0.03
386	CEILING	ACOUSTIC CERAMIC	CEILING	INTACT	WHITE	BED ROOM	222	2nd	BLDG 940	Negative	< LOD	0.03
387	SINK	COATED	C	INTACT	WHITE	BED ROOM	222	2nd	BLDG 940	Negative	< LOD	0.03
388	WALL	DRYWALL	A	INTACT	WHITE	BED ROOM	222	2nd	BLDG 940	Negative	< LOD	0.03
389	WALL	DRYWALL	B	INTACT	WHITE	BED ROOM	222	2nd	BLDG 940	Negative	< LOD	0.03
390	WALL	DRYWALL	C	INTACT	WHITE	BED ROOM	222	2nd	BLDG 940	Negative	< LOD	0.03
391	WALL	DRYWALL	D	INTACT	WHITE	BED ROOM	222	2nd	BLDG 940	Negative	< LOD	0.03
392	WALL	DRYWALL	D	INTACT	PINK	BED ROOM	222	2nd	BLDG 940	Negative	< LOD	0.03
393	BLCNY RAIL BLCNY	METAL	C	Not Intact - Peeling	BROWN	EXTERIOR		2nd	BLDG 940	Negative	< LOD	0.94
394	BALUSTER	METAL	C	INTACT	BROWN	EXTERIOR		2nd	BLDG 940	Negative	< LOD	0.25
395	COLUMN	CONCRETE	C	INTACT	WHITE	EXTERIOR		2nd	BLDG 940	Negative	< LOD	0.03
396	COLUMN	CONCRETE	C	INTACT	WHITE	EXTERIOR		2nd	BLDG 940	Negative	< LOD	0.03
397	COLUMN	CONCRETE	C	INTACT	WHITE	EXTERIOR		2nd	BLDG 940	Negative	< LOD	0.05
398	COLUMN	CONCRETE	C	INTACT	WHITE	EXTERIOR		2nd	BLDG 940	Negative	< LOD	0.03



XRF Analysis Data

Reading No	COMPONENT	SUBSTRATE	SIDE	CONDITION	COLOR	ROOM	ROOM NUMBER	FLOOR	SITE ADDRESS	Results	PbC	PbC Error
399	JOIST	CONCRETE	C	INTACT	WHITE	EXTERIOR		2nd	BLDG 940	Negative	< LOD	0.03
400	WALL	STUCCO	C	INTACT	WHITE	EXTERIOR		2nd	BLDG 940	Negative	< LOD	0.03
401	WNDW CASING	METAL	C	INTACT	BROWN	EXTERIOR		2nd	BLDG 940	Negative	< LOD	0.03
402	WALL	CONCRETE	D	INTACT	WHITE	EXTERIOR		2nd	BLDG 940	Negative	< LOD	0.03
403	COLUMN	CONCRETE	D	INTACT	WHITE	EXTERIOR		2nd	BLDG 940	Negative	< LOD	0.03
	FIRE EXTINGUISHER											
404	BOX	METAL	D	INTACT	RED	EXTERIOR		2nd	BLDG 940	Negative	< LOD	0.03
405	STR RAIL	METAL	D	INTACT	BROWN	EXTERIOR		2nd	BLDG 940	Negative	< LOD	1.09
406	STR BALUSTER	METAL	D	INTACT	BROWN	EXTERIOR		2nd	BLDG 940	Negative	< LOD	0.51
407	STR STRINGER	METAL	D	INTACT	BROWN	EXTERIOR		2nd	BLDG 940	Negative	< LOD	0.84
408	STR TREAD	METAL	D	INTACT	BROWN	EXTERIOR		2nd	BLDG 940	Negative	< LOD	0.32
409	STR RISER	METAL	D	INTACT	BROWN	EXTERIOR		2nd	BLDG 940	Negative	< LOD	0.08
410	STAIR WALL	CONCRETE	D	INTACT	WHITE	EXTERIOR		2nd	BLDG 940	Negative	< LOD	0.03
411	WALL	STUCCO	A	INTACT	WHITE	EXTERIOR		1st	BLDG 940	Negative	< LOD	0.03
412	COLUMN	CONCRETE	A	INTACT	WHITE	EXTERIOR		1st	BLDG 940	Negative	< LOD	0.03
413	COLUMN	CONCRETE	A	INTACT	WHITE	EXTERIOR		1st	BLDG 940	Negative	< LOD	0.03
414	COLUMN	CONCRETE	A	INTACT	WHITE	EXTERIOR		1st	BLDG 940	Negative	< LOD	0.03
415	COLUMN	CONCRETE	A	INTACT	WHITE	EXTERIOR		1st	BLDG 940	Negative	< LOD	0.03
416	EXT. EAVE	CONCRETE	A	INTACT	WHITE	EXTERIOR		3rd	BLDG 940	Negative	< LOD	0.03



XRF Analysis Data

Reading No	COMPONENT	SUBSTRATE	SIDE	CONDITION	COLOR	ROOM	ROOM NUMBER	FLOOR	SITE ADDRESS	Results	PbC	PbC Error
417	EXT. UPR FLASHING	METAL	A	INTACT	BROWN	EXTERIOR		3rd	BLDG 940	Negative	< LOD	0.2
418	BLCNY RAIL	METAL	A	INTACT	BROWN	EXTERIOR		3rd	BLDG 940	Negative	< LOD	0.3
419	BLCNY BALUSTER	METAL	A	INTACT	BROWN	EXTERIOR		3rd	BLDG 940	Negative	< LOD	0.48
420	WALL	CONCRETE	B	INTACT	BROWN	EXTERIOR		1st	BLDG 940	Negative	< LOD	0.03
421	WALL	STUCCO	A	INTACT	WHITE	EXTERIOR		1st	BLDG 940	Negative	< LOD	0.03
422	DR. JAMB/CASING	METAL	A	INTACT	BROWN	HALL 1	LOUNGE	1st	BLDG 940	Negative	< LOD	0.03
423	CEILING	ACOUSTIC	CEILING	INTACT	WHITE	HALL 1	LOUNGE	1st	BLDG 940	Negative	< LOD	0.03
424	WALL	DRYWALL	A	INTACT	WHITE	HALL 1	LOUNGE	1st	BLDG 940	Negative	< LOD	0.03
425	WALL	DRYWALL	B	INTACT	WHITE	HALL 1	LOUNGE	1st	BLDG 940	Negative	< LOD	0.03
426	WALL	DRYWALL	C	INTACT	WHITE	HALL 1	LOUNGE	1st	BLDG 940	Negative	< LOD	0.03
427	WALL	DRYWALL	D	INTACT	WHITE	HALL 1	LOUNGE	1st	BLDG 940	Negative	< LOD	0.03
428	DR. JAMB/CASING	METAL	A	INTACT	BROWN	HALL 1	LOUNGE	1st	BLDG 940	Negative	< LOD	0.03
429	FLOOR	CERAMIC TILE	FLOOR	INTACT	BEIGE	BATH ROOM 1	LOUNGE	1st	BLDG 940	Negative	< LOD	0.05
430	SINK	CERAMIC COATED	D	INTACT	WHITE	BATH ROOM 1	LOUNGE	1st	BLDG 940	Negative	< LOD	0.05
431	TOILET	CERAMIC COATED	D	INTACT	WHITE	BATH ROOM 1	LOUNGE	1st	BLDG 940	Negative	< LOD	0.06
432	CEILING	PLASTER	CEILING	INTACT	WHITE	BATH ROOM 1	LOUNGE	1st	BLDG 940	Negative	< LOD	0.03
433	WALL	PLASTER	A	INTACT	WHITE	BATH ROOM 1	LOUNGE	1st	BLDG 940	Negative	< LOD	0.03
434	WALL	PLASTER	B	INTACT	WHITE	BATH ROOM 1	LOUNGE	1st	BLDG 940	Negative	< LOD	0.03
435	WALL	PLASTER	C	INTACT	WHITE	BATH ROOM 1	LOUNGE	1st	BLDG 940	Negative	< LOD	0.03



XRF Analysis Data

Reading No	COMPONENT	SUBSTRATE	SIDE	CONDITION	COLOR	ROOM	ROOM NUMBER	FLOOR	SITE ADDRESS	Results	PbC	PbC Error
436	WALL	PLASTER	D	INTACT	WHITE	BATH ROOM 1	LOUNGE	1st	BLDG 940	Negative	< LOD	0.03
437	WALL	PLASTER	D	INTACT	WHITE	BATH ROOM 2	LOUNGE	1st	BLDG 940	Negative	< LOD	0.03
438	WALL	PLASTER	C	INTACT	WHITE	BATH ROOM 2	LOUNGE	1st	BLDG 940	Negative	< LOD	0.26
439	WALL	PLASTER	B	INTACT	WHITE	BATH ROOM 2	LOUNGE	1st	BLDG 940	Negative	< LOD	0.03
440	WALL	PLASTER	A	INTACT	WHITE	BATH ROOM 2	LOUNGE	1st	BLDG 940	Negative	< LOD	0.03
441	CEILING	PLASTER	CEILING	INTACT	WHITE	BATH ROOM 2	LOUNGE	1st	BLDG 940	Negative	< LOD	0.03
442	FLOOR	CERAMIC TILE	FLOOR	INTACT	BEIGE	BATH ROOM 2	LOUNGE	1st	BLDG 940	Negative	< LOD	0.03
443	SINK	CERAMIC COATED	B	INTACT	WHITE	BATH ROOM 2	LOUNGE	1st	BLDG 940	Negative	< LOD	0.04
444	TOILET DR.	CERAMIC COATED	B	INTACT	WHITE	BATH ROOM 2	LOUNGE	1st	BLDG 940	Negative	< LOD	0.25
445	JAMB/CASING	METAL	A	INTACT	BROWN	BATH ROOM 2	LOUNGE	1st	BLDG 940	Negative	< LOD	0.07
446	SINK	CERAMIC COATED	FLOOR	INTACT	WHITE	BATH ROOM 2	LOUNGE	1st	BLDG 940	Positive	< LOD	33.15
447	WALL	PLASTER	B	INTACT	WHITE	JANITOR CLOSET	LOUNGE	1st	BLDG 940	Negative	< LOD	0.03
448	WALL	PLASTER	C	INTACT	WHITE	JANITOR CLOSET	LOUNGE	1st	BLDG 940	Negative	< LOD	0.06
449	WALL	PLASTER	D	INTACT	WHITE	JANITOR CLOSET	LOUNGE	1st	BLDG 940	Negative	< LOD	0.03
450	CEILING	PLASTER	CEILING	INTACT	WHITE	JANITOR CLOSET	LOUNGE	1st	BLDG 940	Negative	< LOD	0.03
451	CEILING	ACOUSTIC	CEILING	INTACT	WHITE	STORAGE 2	LOUNGE	1st	BLDG 940	Negative	< LOD	0.03



XRF Analysis Data

Reading No	COMPONENT	SUBSTRATE	SIDE	CONDITION	COLOR	ROOM	ROOM NUMBER	FLOOR	SITE ADDRESS	Results	PbC	PbC Error
452	WNDW CASING DR.	METAL	C	INTACT	BROWN	STORAGE 2	LOUNGE	1st	BLDG 940	Negative	< LOD	0.03
453	JAMB/CASING	METAL	A	INTACT	BROWN	STORAGE 2	LOUNGE	1st	BLDG 940	Negative	< LOD	0.03
454	WALL	DRYWALL	A	INTACT	WHITE	STORAGE 2	LOUNGE	1st	BLDG 940	Negative	< LOD	0.06
455	WALL	DRYWALL	B	INTACT	BLUE	STORAGE 2	LOUNGE	1st	BLDG 940	Negative	< LOD	0.03
456	WALL	DRYWALL	C	INTACT	WHITE	STORAGE 2	LOUNGE	1st	BLDG 940	Negative	< LOD	0.03
457	WALL	DRYWALL	D	INTACT	WHITE	STORAGE 2	LOUNGE	1st	BLDG 940	Negative	< LOD	0.03
458	CEILING	ACOUSTIC	CEILING	INTACT	WHITE	LOUNGE	LOUNGE	1st	BLDG 940	Negative	< LOD	0.05
459	WALL HEATER	METAL	C	INTACT	BEIGE	LOUNGE	LOUNGE	1st	BLDG 940	Negative	< LOD	0.04
460	WALL	DRYWALL	A	INTACT	WHITE	LOUNGE	LOUNGE	1st	BLDG 940	Negative	< LOD	0.03
461	WALL	DRYWALL	B	INTACT	WHITE	LOUNGE	LOUNGE	1st	BLDG 940	Negative	< LOD	0.03
462	WALL	DRYWALL	C	INTACT	WHITE	LOUNGE	LOUNGE	1st	BLDG 940	Negative	< LOD	0.03
463	WALL	DRYWALL	D	INTACT	WHITE	LOUNGE	LOUNGE	1st	BLDG 940	Negative	< LOD	0.03
464	WALL	DRYWALL	A	INTACT	BLUE	LOUNGE	LOUNGE	1st	BLDG 940	Negative	< LOD	0.04
465	WALL	DRYWALL	B	INTACT	BLUE	LOUNGE	LOUNGE	1st	BLDG 940	Negative	< LOD	0.03
466	WALL	DRYWALL	C	INTACT	BLUE	LOUNGE	LOUNGE	1st	BLDG 940	Negative	< LOD	0.03
467	WNDW CASING DR.	METAL	C	INTACT	BROWN	LOUNGE	LOUNGE	1st	BLDG 940	Negative	< LOD	0.04
468	JAMB/CASING DR.	METAL	C	INTACT	BROWN	STORAGE 1	LOUNGE	1st	BLDG 940	Negative	< LOD	0.4
469	JAMB/CASING	METAL	A	INTACT	BROWN	STORAGE 1	LOUNGE	1st	BLDG 940	Negative	< LOD	0.33
470	CEILING	CONCRETE	CEILING	INTACT	WHITE	STORAGE 1	LOUNGE	1st	BLDG 940	Negative	< LOD	1.16
471	WALL	DRYWALL	A	INTACT	WHITE	STORAGE 1	LOUNGE	1st	BLDG 940	Negative	< LOD	0.16
472	WALL	PLASTER	B	INTACT	WHITE	STORAGE 1	LOUNGE	1st	BLDG 940	Negative	< LOD	1.19
473	WALL	PLASTER	C	INTACT	WHITE	STORAGE 1	LOUNGE	1st	BLDG 940	Negative	< LOD	0.03
474	WALL	PLASTER	D	INTACT	WHITE	STORAGE 1	LOUNGE	1st	BLDG 940	Negative	< LOD	0.03
475	WALL	DRYWALL	D	INTACT	WHITE	HALL 2	LOUNGE	1st	BLDG 940	Negative	< LOD	0.03
476	WALL	DRYWALL	C	INTACT	WHITE	HALL 2	LOUNGE	1st	BLDG 940	Negative	< LOD	0.03
477	WALL	DRYWALL	B	INTACT	WHITE	HALL 2	LOUNGE	1st	BLDG 940	Negative	< LOD	0.03



XRF Analysis Data

Reading No	COMPONENT	SUBSTRATE	SIDE	CONDITION	COLOR	ROOM	ROOM NUMBER	FLOOR	SITE ADDRESS	Results	PbC	PbC Error
478	WALL	DRYWALL	D	INTACT	BLUE	HALL 2	LOUNGE	1st	BLDG 940	Negative	< LOD	0.04
479	CEILING DR.	ACOUSTIC	CEILING	INTACT	WHITE	HALL 2	LOUNGE	1st	BLDG 940	Negative	< LOD	0.1
480	JAMB/CASING DR.	METAL	B	INTACT	BROWN	HALL 2	LOUNGE	1st	BLDG 940	Negative	< LOD	0.03
481	JAMB/CASING DR.	METAL	C	INTACT	BROWN	LAUNDRY	LOUNGE	1st	BLDG 940	Negative	< LOD	0.04
482	JAMB/CASING	METAL	A	INTACT	BROWN	LAUNDRY	LOUNGE	1st	BLDG 940	Negative	< LOD	0.03
483	CEILING	PLASTER	CEILING	INTACT	WHITE	LAUNDRY	LOUNGE	1st	BLDG 940	Negative	< LOD	0.03
484	WALL	PLASTER	A	INTACT	WHITE	LAUNDRY	LOUNGE	1st	BLDG 940	Negative	< LOD	0.03
485	WALL	PLASTER	B	INTACT	WHITE	LAUNDRY	LOUNGE	1st	BLDG 940	Negative	< LOD	0.03
486	WALL	PLASTER	C	INTACT	WHITE	LAUNDRY	LOUNGE	1st	BLDG 940	Negative	< LOD	0.03
487	WALL	PLASTER CERAMIC COATED	D	INTACT	WHITE	LAUNDRY	LOUNGE	1st	BLDG 940	Negative	< LOD	0.03
488	SINK	CERAMIC COATED	C	INTACT	WHITE	LAUNDRY	LOUNGE	1st	BLDG 940	Negative	< LOD	0.04
489	DOOR DR.	METAL	A	INTACT	BROWN	PUMP ROOM		1st	BLDG 940	Negative	< LOD	0.13
490	JAMB/CASING	METAL	A	INTACT	BROWN	PUMP ROOM		1st	BLDG 940	Negative	< LOD	0.29
491	CEILING	CONCRETE	CEILING	INTACT	WHITE	PUMP ROOM		1st	BLDG 940	Negative	< LOD	0.03
492	WALL	DRYWALL	A	INTACT	WHITE	PUMP ROOM		1st	BLDG 940	Negative	< LOD	0.03
493	WALL	DRYWALL	B	INTACT	WHITE	PUMP ROOM		1st	BLDG 940	Negative	< LOD	0.03
494	WALL	DRYWALL	C	INTACT	WHITE	PUMP ROOM		1st	BLDG 940	Negative	< LOD	0.03
495	WALL	DRYWALL	D	INTACT	WHITE	PUMP ROOM		1st	BLDG 940	Negative	< LOD	0.03
496	PUMP	METAL	CENTER	INTACT	GREY	PUMP ROOM		1st	BLDG 940	Negative	< LOD	0.06



XRF Analysis Data

Reading No	COMPONENT	SUBSTRATE	SIDE	CONDITION	COLOR	ROOM	ROOM NUMBER	FLOOR	SITE ADDRESS	Results	PbC	PbC Error
497	ELEC PANEL	METAL	D	INTACT	GREY	PUMP ROOM		1st	BLDG 940	Negative	< LOD	0.03
498	ELEC PANEL	METAL	D	INTACT	RED	PUMP ROOM		1st	BLDG 940	Negative	< LOD	0.03
499	ELEC PANEL	METAL	B	INTACT	BLUE	PUMP ROOM		1st	BLDG 940	Negative	< LOD	0.03
500	GENERATOR	METAL	CENTER	INTACT	GREY	ROOM BOILER		1st	BLDG 940	Negative	< LOD	0.4
501	GENERATOR	METAL	CENTER	INTACT	GREY	ROOM BOILER		1st	BLDG 940	Negative	< LOD	0.06
502	CEILING	CONCRETE	CEILING	INTACT	WHITE	ROOM BOILER		1st	BLDG 940	Negative	< LOD	0.05
503	WALL	DRYWALL	A	INTACT	WHITE	ROOM BOILER		1st	BLDG 940	Negative	< LOD	0.03
504	WALL	DRYWALL	B	INTACT	WHITE	ROOM BOILER		1st	BLDG 940	Negative	< LOD	0.11
505	WALL	DRYWALL	C	INTACT	WHITE	ROOM BOILER		1st	BLDG 940	Negative	< LOD	0.04
506	WALL DR.	CONCRETE	D	INTACT	WHITE	ROOM BOILER		1st	BLDG 940	Negative	< LOD	0.09
507	JAMB/CASING	METAL	A	INTACT	BROWN	ROOM BOILER		1st	BLDG 940	Negative	< LOD	0.05
508	DOOR	METAL	A	INTACT	BROWN	ROOM BOILER		1st	BLDG 940	Negative	< LOD	0.12
509	DOOR DR.	METAL	A	INTACT	BROWN	ROOM BOILER		1st	BLDG 940	Negative	< LOD	0.09
510	JAMB/CASING	METAL	A	INTACT	BROWN	ROOM HVAC		1st	BLDG 940	Negative	< LOD	0.24
511	WALL	STUCCO	B	INTACT	YELLOW	SHELTER HVAC			BLDG 940	Negative	< LOD	0.03
512	WALL	STUCCO	C	INTACT	YELLOW	SHELTER			BLDG 940	Negative	< LOD	0.03



XRF Analysis Data

Reading No	COMPONENT	SUBSTRATE	SIDE	CONDITION	COLOR	ROOM	ROOM NUMBER	FLOOR	SITE ADDRESS	Results	PbC	PbC Error
513	WALL	STUCCO	A	INTACT	YELLOW	HVAC SHELTER			BLDG 940	Negative	< LOD	0.03
514	WALL	STUCCO	D	INTACT	YELLOW	HVAC SHELTER			BLDG 940	Negative	< LOD	0.03
515	JAMB/CASING	METAL	B	INTACT	BROWN	HVAC SHELTER			BLDG 940	Negative	0.9	0.1
516	DOOR	METAL	B	INTACT	BROWN	HVAC SHELTER			BLDG 940	Negative	< LOD	0.1
517	EXT. FASCIA	METAL	B	INTACT	BROWN	HVAC SHELTER			BLDG 940	Negative	0.7	0.2
518	GENERATOR	METAL CINDER	CENTER	INTACT	GREY	SHELTER			BLDG 940	Negative	< LOD	0.19
519	PLANTER WALL	BLOCK	B	INTACT	WHITE	EXTERIOR			BLDG 940	Negative	< LOD	0.03
520	BENCH	WOOD	B	Not Intact - Peeling	BROWN	EXTERIOR			BLDG 940	Negative	< LOD	0.05
521	CALIBRATE- BACK	CALIBRATE- BACK			RED					Positive	1.1	0.1
522	CALIBRATE- BACK	CALIBRATE- BACK			RED					Positive	1.1	0.1
523	CALIBRATE- BACK	CALIBRATE- BACK			RED					Positive	1.2	0.1
524	SHUTTER_CAL										3.78	0
525	CALIBRATE- FRONT	CALIBRATE- FRONT			RED					Positive	1.2	0.2
526	CALIBRATE- FRONT	CALIBRATE- FRONT			RED					Positive	1.1	0.1
527	CALIBRATE- FRONT	CALIBRATE- FRONT			RED					Positive	1.2	0.2
528	WALL	CINDER BLOCK	A	INTACT	WHITE	SECURITY OFFICE			BLDG 960	Negative	< LOD	0.03



XRF Analysis Data

Reading No	COMPONENT	SUBSTRATE	SIDE	CONDITION	COLOR	ROOM	ROOM NUMBER	FLOOR	SITE ADDRESS	Results	PbC	PbC Error
529	WALL	CINDER BLOCK	D	INTACT	WHITE	SECURITY OFFICE			BLDG 960	Negative	< LOD	0.03
530	WALL	DRYWALL	C	INTACT	WHITE	SECURITY OFFICE			BLDG 960	Negative	< LOD	0.03
531	WALL	DRYWALL	B	INTACT	WHITE	SECURITY OFFICE			BLDG 960	Negative	< LOD	0.16
532	DOOR DR.	METAL	A	INTACT	BEIGE	SECURITY OFFICE			BLDG 960	Negative	< LOD	0.16
533	JAMB/CASING DR.	METAL	A	INTACT	BEIGE	SECURITY OFFICE			BLDG 960	Negative	< LOD	0.1
534	JAMB/CASING	METAL	C	INTACT	BEIGE	SECURITY OFFICE			BLDG 960	Negative	< LOD	0.21
535	DOOR	WOOD	C	INTACT	BEIGE	OFFICE			BLDG 960	Negative	< LOD	0.03
536	DOOR DR.	WOOD	D	INTACT	BEIGE	OFFICE 8			BLDG 960	Negative	< LOD	0.03
537	JAMB/CASING	METAL	D	INTACT	BEIGE	OFFICE 8			BLDG 960	Negative	< LOD	0.06
538	WALL	DRYWALL	D	INTACT	WHITE	OFFICE 8			BLDG 960	Negative	< LOD	0.07
539	WALL	DRYWALL	D	INTACT	WHITE	OFFICE 8			BLDG 960	Negative	< LOD	0.03
540	WALL	DRYWALL	C	INTACT	WHITE	OFFICE 8			BLDG 960	Negative	< LOD	0.03
541	WALL	DRYWALL	B	INTACT	WHITE	OFFICE 8			BLDG 960	Negative	< LOD	0.03
542	WALL	DRYWALL	A	INTACT	WHITE	OFFICE 8			BLDG 960	Negative	< LOD	0.03
543	DOOR	WOOD	C	INTACT	GREY	SECURITY OFFICE			BLDG 960	Negative	< LOD	0.03
544	DOOR DR.	WOOD	C	INTACT	GREY	ELEC ROOM			BLDG 960	Negative	< LOD	0.03
545	JAMB/CASING	METAL	C	INTACT	GREY	ELEC ROOM			BLDG 960	Negative	< LOD	0.03
546	WALL	DRYWALL	C	INTACT	WHITE	ELEC ROOM			BLDG 960	Negative	< LOD	0.03
547	WALL	DRYWALL	B	INTACT	WHITE	ELEC ROOM			BLDG 960	Negative	< LOD	0.03
548	WALL	DRYWALL	A	INTACT	WHITE	ELEC ROOM			BLDG 960	Negative	< LOD	0.03
549	CEILING	DRYWALL	CEILING	INTACT	WHITE	ELEC ROOM			BLDG 960	Negative	< LOD	0.03



XRF Analysis Data

Reading No	COMPONENT	SUBSTRATE	SIDE	CONDITION	COLOR	ROOM	ROOM NUMBER	FLOOR	SITE ADDRESS	Results	PbC	PbC Error
		CINDER										
550	WALL	BLOCK	D	INTACT	WHITE	ELEC ROOM			BLDG 960	Negative	< LOD	0.06
551	ELEC BOX DR.	METAL	A	INTACT	GREY	ELEC ROOM			BLDG 960	Negative	< LOD	0.03
552	JAMB/CASING	METAL	C	INTACT	GREY	OFFICE 7			BLDG 960	Negative	< LOD	0.03
553	DOOR	WOOD	C	INTACT	GREY	OFFICE 7			BLDG 960	Negative	< LOD	0.03
554	WALL	DRYWALL	A	INTACT	WHITE	OFFICE 7			BLDG 960	Negative	< LOD	0.23
555	WALL	DRYWALL	B	INTACT	WHITE	OFFICE 7			BLDG 960	Negative	< LOD	0.06
556	WALL	DRYWALL	C	INTACT	WHITE	OFFICE 7			BLDG 960	Negative	< LOD	0.09
557	WALL	DRYWALL	D	INTACT	WHITE	OFFICE 7			BLDG 960	Negative	< LOD	0.03
558	CEILING	DRYWALL	CEILING	INTACT	WHITE	OFFICE 7			BLDG 960	Negative	< LOD	0.06
559	CEILING	DRYWALL	CEILING	INTACT	WHITE	OFFICE 6			BLDG 960	Negative	< LOD	0.03
560	WALL	DRYWALL	A	INTACT	WHITE	OFFICE 6			BLDG 960	Negative	< LOD	0.03
561	WALL	DRYWALL	B	INTACT	WHITE	OFFICE 6			BLDG 960	Negative	< LOD	0.03
562	WALL	DRYWALL	C	INTACT	WHITE	OFFICE 6			BLDG 960	Negative	< LOD	0.03
563	WALL	DRYWALL	D	INTACT	WHITE	OFFICE 6			BLDG 960	Negative	< LOD	0.03
564	DOOR DR.	WOOD	C	INTACT	GREY	OFFICE 6			BLDG 960	Negative	< LOD	0.03
565	JAMB/CASING	WOOD	C	INTACT	GREY	OFFICE 6			BLDG 960	Negative	< LOD	0.03
566	WALL	DRYWALL	A	INTACT	WHITE	OFFICE 9			BLDG 960	Negative	< LOD	0.03
567	WALL	DRYWALL	A	INTACT	ORANGE	OFFICE 9			BLDG 960	Negative	< LOD	0.03
568	WALL	DRYWALL	B	INTACT	ORANGE	OFFICE 9			BLDG 960	Negative	< LOD	0.03
569	WALL DR.	DRYWALL	C	INTACT	ORANGE	OFFICE 9			BLDG 960	Negative	< LOD	0.03
570	JAMB/CASING	METAL	B	INTACT	WHITE	OFFICE 9			BLDG 960	Negative	< LOD	0.03
571	DOOR	METAL	B	INTACT	WHITE	OFFICE 9			BLDG 960	Negative	< LOD	0.03
572	DOOR	METAL	B	INTACT	WHITE	DAMAGE MERCHANDI SE ROOM			BLDG 960	Negative	< LOD	0.25



XRF Analysis Data

Reading No	COMPONENT	SUBSTRATE	SIDE	CONDITION	COLOR	ROOM	ROOM NUMBER	FLOOR	SITE ADDRESS	Results	PbC	PbC Error
573	DR. JAMB/CASING	METAL	B	INTACT	WHITE	DAMAGE MERCHANDI SE ROOM			BLDG 960	Negative	< LOD	0.06
574	DR. JAMB/CASING	METAL	B	INTACT	WHITE	DAMAGE MERCHANDI SE ROOM			BLDG 960	Negative	< LOD	0.08
575	WALL	METAL	B	INTACT	WHITE	DAMAGE MERCHANDI SE ROOM			BLDG 960	Negative	< LOD	0.12
576	WALL	DRYWALL	B	INTACT	WHITE	DAMAGE MERCHANDI SE ROOM			BLDG 960	Negative	< LOD	0.03
577	WALL	DRYWALL	A	INTACT	WHITE	DAMAGE MERCHANDI SE ROOM			BLDG 960	Negative	< LOD	0.03
578	WALL	DRYWALL	D	INTACT	WHITE	DAMAGE MERCHANDI SE ROOM			BLDG 960	Negative	< LOD	0.03
579	WALL	DRYWALL	C	INTACT	WHITE	DAMAGE MERCHANDI SE ROOM			BLDG 960	Negative	< LOD	0.03
580	WALL	DRYWALL	D	INTACT	WHITE	DAMAGE MERCHANDI SE ROOM			BLDG 960	Negative	< LOD	0.04
581	WALL	CERAMIC TILE	D	INTACT	BEIGE	DAMAGE MERCHANDI SE ROOM			BLDG 960	Positive	21.2	13
582	WALL	CERAMIC TILE	A	INTACT	BEIGE	DAMAGE MERCHANDI SE ROOM			BLDG 960	Positive	< LOD	12



XRF Analysis Data

Reading No	COMPONENT	SUBSTRATE	SIDE	CONDITION	COLOR	ROOM	ROOM NUMBER	FLOOR	SITE ADDRESS	Results	PbC	PbC Error
583	FLOOR	CERAMIC TILE	FLOOR	INTACT	BEIGE	DAMAGE MERCHANDI SE ROOM DAMAGE MERCHANDI			BLDG 960	Negative	< LOD	0.03
584	CEILING	DRYWALL	CEILING	INTACT	WHITE	SE ROOM			BLDG 960	Negative	< LOD	0.03
585	WALL	DRYWALL	A	INTACT	WHITE	OFFICE 11			BLDG 960	Negative	< LOD	0.03
586	WALL	DRYWALL	A	INTACT	WHITE	OFFICE 11			BLDG 960	Negative	< LOD	0.03
587	WALL	DRYWALL	D	INTACT	WHITE	OFFICE 11			BLDG 960	Negative	< LOD	0.03
588	WALL	DRYWALL	D	INTACT	WHITE	OFFICE 11			BLDG 960	Negative	< LOD	0.03
589	WALL	DRYWALL	B	INTACT	WHITE	OFFICE 11			BLDG 960	Negative	< LOD	0.03
590	WALL	DRYWALL	C	INTACT	WHITE	OFFICE 11			BLDG 960	Negative	< LOD	0.03
591	JAMB/CASING	METAL	A	INTACT	WHITE	OFFICE 11			BLDG 960	Negative	< LOD	0.03
592	WNDW CASING	METAL	A	INTACT	WHITE	OFFICE 11			BLDG 960	Negative	< LOD	0.03
593	WNDW CASING	METAL	C	INTACT	WHITE	OFFICE 10			BLDG 960	Negative	< LOD	0.06
594	JAMB/CASING	METAL	C	INTACT	WHITE	OFFICE 10			BLDG 960	Negative	< LOD	0.03
595	WALL	DRYWALL	C	INTACT	WHITE	OFFICE 10			BLDG 960	Negative	< LOD	0.03
596	WALL	DRYWALL	C	INTACT	WHITE	OFFICE 10			BLDG 960	Negative	< LOD	0.03
597	WALL	DRYWALL	D	INTACT	WHITE	OFFICE 10			BLDG 960	Negative	< LOD	0.75
598	WALL	DRYWALL	D	INTACT	WHITE	OFFICE 10			BLDG 960	Negative	< LOD	0.03
599	WALL	DRYWALL	A	INTACT	WHITE	OFFICE 10			BLDG 960	Negative	< LOD	0.03
600	WALL	DRYWALL	A	INTACT	WHITE	OFFICE 10			BLDG 960	Negative	< LOD	0.75
601	WALL	DRYWALL	B	INTACT	WHITE	OFFICE 10			BLDG 960	Negative	< LOD	0.03
602	JAMB/CASING	METAL	B	INTACT	TAN	OFFICE 15			BLDG 960	Negative	< LOD	0.03
603	DOOR	WOOD	B	INTACT	TAN	OFFICE 15			BLDG 960	Negative	< LOD	0.03
604	WALL	DRYWALL	B	INTACT	WHITE	OFFICE 15			BLDG 960	Negative	< LOD	0.03
605	WALL	DRYWALL	C	INTACT	WHITE	OFFICE 15			BLDG 960	Negative	< LOD	0.03



XRF Analysis Data

Reading No	COMPONENT	SUBSTRATE	SIDE	CONDITION	COLOR	ROOM	ROOM NUMBER	FLOOR	SITE ADDRESS	Results	PbC	PbC Error
606	WALL	DRYWALL	D	INTACT	WHITE	OFFICE 15			BLDG 960	Negative	< LOD	0.09
607	WALL	DRYWALL	A	INTACT	WHITE	OFFICE 15			BLDG 960	Negative	< LOD	0.03
608	CEILING	DRYWALL	CEILING	INTACT	WHITE	OFFICE 15			BLDG 960	Negative	< LOD	0.04
609	WALL	DRYWALL	A	INTACT	WHITE	KITCHEN 2			BLDG 960	Negative	< LOD	0.03
610	WALL	DRYWALL	B	INTACT	WHITE	KITCHEN 2			BLDG 960	Negative	< LOD	0.03
611	WALL	DRYWALL	C	INTACT	WHITE	KITCHEN 2			BLDG 960	Negative	< LOD	0.03
612	WALL	DRYWALL	D	INTACT	WHITE	KITCHEN 2			BLDG 960	Negative	< LOD	0.03
613	JAMB/CASING DR.	METAL	B	INTACT	BEIGE	KITCHEN 2			BLDG 960	Negative	< LOD	0.03
614	JAMB/CASING	METAL	B	INTACT	BROWN	KITCHEN 2			BLDG 960	Negative	< LOD	0.03
615	DOOR	WOOD	B	INTACT	BEIGE	KITCHEN 2			BLDG 960	Negative	< LOD	0.07
616	WALL	WOOD	A	INTACT	WHITE	KITCHEN 2			BLDG 960	Negative	< LOD	0.03
617	WALL	METAL	A	INTACT	WHITE	KITCHEN 1			BLDG 960	Negative	< LOD	0.03
618	WALL	DRYWALL	A	INTACT	WHITE	KITCHEN 1			BLDG 960	Negative	< LOD	0.03
619	WALL	DRYWALL	B	INTACT	YELLOW	KITCHEN 1			BLDG 960	Negative	< LOD	0.05
620	WALL	DRYWALL	C	INTACT	YELLOW	KITCHEN 1			BLDG 960	Negative	< LOD	0.03
621	WALL	DRYWALL	D	INTACT	YELLOW	KITCHEN 1			BLDG 960	Negative	< LOD	0.03
622	WALL	METAL	A	INTACT	WHITE	KITCHEN 1			BLDG 960	Negative	< LOD	0.03
623	DOOR	WOOD	C	INTACT	GREY	KITCHEN 1			BLDG 960	Negative	< LOD	0.03
624	JAMB/CASING DR.	METAL	C	INTACT	GREY	KITCHEN 1			BLDG 960	Negative	< LOD	0.12
625	JAMB/CASING	METAL	C	INTACT	BEIGE	KITCHEN 1			BLDG 960	Negative	< LOD	0.05
626	JAMB/CASING DR.	WOOD	D	INTACT	WHITE	MEN'S LOCKER ROOM			BLDG 960	Negative	< LOD	0.07



XRF Analysis Data

Reading No	COMPONENT	SUBSTRATE	SIDE	CONDITION	COLOR	ROOM	ROOM NUMBER	FLOOR	SITE ADDRESS	Results	PbC	PbC Error
627	DOOR	WOOD	D	INTACT	WHITE	MEN'S LOCKER ROOM			BLDG 960	Negative	< LOD	0.03
628	WALL	DRYWALL	A	INTACT	WHITE	MEN'S LOCKER ROOM			BLDG 960	Negative	< LOD	0.75
629	WALL	DRYWALL	B	INTACT	WHITE	MEN'S LOCKER ROOM			BLDG 960	Negative	< LOD	0.03
630	WALL	DRYWALL	C	INTACT	WHITE	MEN'S LOCKER ROOM			BLDG 960	Negative	< LOD	0.03
631	WALL	DRYWALL	D	INTACT	WHITE	MEN'S LOCKER ROOM			BLDG 960	Negative	< LOD	0.03
632	BASEBOARD	WOOD	D	INTACT	RED	MEN'S LOCKER ROOM			BLDG 960	Negative	< LOD	0.03
633	CEILING	DRYWALL	CEILING	INTACT	WHITE	MEN'S BATH ROOM - WARE HOUSE			BLDG 960	Negative	< LOD	0.03
634	WALL	DRYWALL	A	INTACT	WHITE	MEN'S BATH ROOM - WARE HOUSE			BLDG 960	Negative	< LOD	0.21
635	WALL	DRYWALL	A	INTACT	WHITE	MEN'S BATH ROOM - WARE HOUSE			BLDG 960	Negative	< LOD	0.04



XRF Analysis Data

Reading No	COMPONENT	SUBSTRATE	SIDE	CONDITION	COLOR	ROOM	ROOM NUMBER	FLOOR	SITE ADDRESS	Results	PbC	PbC Error
636	WALL	DRYWALL	B	INTACT	WHITE	MEN'S BATH ROOM - WARE HOUSE			BLDG 960	Negative	< LOD	0.07
637	WALL	DRYWALL	C	INTACT	WHITE	MEN'S BATH ROOM - WARE HOUSE			BLDG 960	Negative	< LOD	0.03
638	WALL	DRYWALL	D	INTACT	WHITE	MEN'S BATH ROOM - WARE HOUSE			BLDG 960	Negative	< LOD	0.03
639	WALL	CERAMIC TILE	D	INTACT	BROWN	MEN'S BATH ROOM - WARE HOUSE			BLDG 960	Negative	< LOD	0.31
640	WALL	CERAMIC TILE	A	INTACT	BROWN	MEN'S BATH ROOM - WARE HOUSE			BLDG 960	Negative	< LOD	0.21
641	FLOOR	CERAMIC TILE	FLOOR	INTACT	BROWN	MEN'S BATH ROOM - WARE HOUSE			BLDG 960	Negative	< LOD	0.03
642	SINK	CERAMIC COATED	C	INTACT	WHITE	MEN'S BATHROOM - WAREHOUSE E			BLDG 960	Negative	< LOD	0.18
643	TOILET	CERAMIC COATED	A	INTACT	WHITE	MEN'S BATHROOM - WAREHOUSE E			BLDG 960	Negative	< LOD	0.13



XRF Analysis Data

Reading No	COMPONENT	SUBSTRATE	SIDE	CONDITION	COLOR	ROOM	ROOM NUMBER	FLOOR	SITE ADDRESS	Results	PbC	PbC Error
644	URINAL	CERAMIC COATED	A	INTACT	WHITE	MEN'S BATHROOM - WAREHOUS E			BLDG 960	Negative	< LOD	0.21
645	STALL WALL	METAL	A	INTACT	ORANGE	MEN'S BATHROOM - WAREHOUS E			BLDG 960	Negative	< LOD	0.03
646	STALL DOOR	METAL	A	INTACT	ORANGE	MEN'S BATHROOM - WAREHOUS E			BLDG 960	Negative	< LOD	0.03
647	DOOR	WOOD	C	INTACT	ORANGE	MEN'S BATHROOM - WAREHOUS E			BLDG 960	Negative	< LOD	0.03
648	DR. JAMB/CASING	METAL	C	INTACT	ORANGE	MEN'S BATHROOM - WAREHOUS E			BLDG 960	Negative	< LOD	0.06
649	DR. JAMB/CASING	WOOD	D	INTACT	WHITE	WOMEN'S LOCKER ROOM			BLDG 960	Negative	< LOD	0.03
650	DOOR	WOOD	D	INTACT	WHITE	WOMEN'S LOCKER ROOM			BLDG 960	Negative	< LOD	0.03
651	BASEBOARD	WOOD	D	INTACT	RED	WOMEN'S LOCKER ROOM			BLDG 960	Negative	< LOD	0.03
652	WALL	DRYWALL	A	INTACT	WHITE	WOMEN'S LOCKER ROOM			BLDG 960	Negative	< LOD	0.03



XRF Analysis Data

Reading No	COMPONENT	SUBSTRATE	SIDE	CONDITION	COLOR	ROOM	ROOM NUMBER	FLOOR	SITE ADDRESS	Results	PbC	PbC Error
653	WALL	DRYWALL	B	INTACT	WHITE	WOMEN'S LOCKER ROOM			BLDG 960	Negative	< LOD	0.03
654	WALL	DRYWALL	C	INTACT	WHITE	WOMEN'S LOCKER ROOM			BLDG 960	Negative	< LOD	0.03
655	WALL	DRYWALL	D	INTACT	WHITE	WOMEN'S LOCKER ROOM			BLDG 960	Negative	< LOD	0.03
656	WALL	DRYWALL	D	INTACT	WHITE	WOMEN'S BATH ROOM - WARE HOUSE			BLDG 960	Negative	< LOD	0.04
657	WALL	DRYWALL	B	INTACT	WHITE	WOMEN'S BATH ROOM - WARE HOUSE			BLDG 960	Negative	< LOD	0.03
658	WALL	DRYWALL	C	INTACT	WHITE	WOMEN'S BATH ROOM - WARE HOUSE			BLDG 960	Negative	< LOD	0.03
659	WALL	DRYWALL	D	INTACT	WHITE	WOMEN'S BATH ROOM - WARE HOUSE			BLDG 960	Negative	< LOD	0.03
660	CEILING	DRYWALL	CEILING	INTACT	WHITE	WOMEN'S BATH ROOM - WARE HOUSE			BLDG 960	Negative	< LOD	0.03



XRF Analysis Data

Reading No	COMPONENT	SUBSTRATE	SIDE	CONDITION	COLOR	ROOM	ROOM NUMBER	FLOOR	SITE ADDRESS	Results	PbC	PbC Error
661	DOOR	WOOD	C	INTACT	YELLOW	WOMEN'S BATH ROOM - WARE HOUSE			BLDG 960	Negative	< LOD	0.03
662	DR. JAMB/CASING	METAL	C	INTACT	YELLOW	WOMEN'S BATH ROOM - WARE HOUSE			BLDG 960	Negative	< LOD	0.03
663	WALL	CERAMIC TILE	C	INTACT	YELLOW	WOMEN'S BATH ROOM - WARE HOUSE			BLDG 960	Negative	< LOD	0.13
664	STALL WALL	METAL	A	INTACT	YELLOW	WOMEN'S BATH ROOM - WARE HOUSE			BLDG 960	Negative	0.8	0.2
665	STALL DOOR	METAL	A	INTACT	YELLOW	WOMEN'S BATH ROOM - WARE HOUSE			BLDG 960	Negative	0.5	0.2
666	TOILET	CERAMIC COATED	A	INTACT	WHITE	WOMEN'S BATH ROOM - WARE HOUSE			BLDG 960	Negative	< LOD	0.1
667	SINK	CERAMIC COATED	C	INTACT	WHITE	WOMEN'S BATH ROOM - WARE HOUSE			BLDG 960	Negative	< LOD	0.61
668	FLOOR	CERAMIC TILE	FLOOR	INTACT	BROWN	WOMEN'S BATH ROOM - WARE HOUSE			BLDG 960	Negative	< LOD	0.12



XRF Analysis Data

Reading No	COMPONENT	SUBSTRATE	SIDE	CONDITION	COLOR	ROOM	ROOM NUMBER	FLOOR	SITE ADDRESS	Results	PbC	PbC Error
669	DOOR	WOOD	C	INTACT	GREY	OFFICE 3			BLDG 960	Negative	< LOD	0.03
	DR.											
670	JAMB/CASING	METAL	C	INTACT	GREY	OFFICE 3			BLDG 960	Negative	< LOD	0.04
671	CEILING	DRYWALL	CEILING	INTACT	WHITE	OFFICE 3			BLDG 960	Negative	< LOD	0.03
672	WALL	DRYWALL	B	INTACT	WHITE	OFFICE 3			BLDG 960	Negative	< LOD	0.03
673	WALL	DRYWALL	C	INTACT	WHITE	OFFICE 3			BLDG 960	Negative	< LOD	0.03
674	WALL	DRYWALL	D	INTACT	WHITE	OFFICE 3			BLDG 960	Negative	< LOD	0.03
675	WALL	METAL	A	INTACT	WHITE	OFFICE 3			BLDG 960	Negative	< LOD	0.04
676	COLUMN	METAL	A	INTACT	WHITE	OFFICE 3			BLDG 960	Negative	< LOD	0.36
677	JOIST	METAL	A	INTACT	WHITE	OFFICE 3			BLDG 960	Negative	< LOD	0.04
678	DOOR	METAL	A	INTACT	GREY	OFFICE 3			BLDG 960	Negative	< LOD	0.37
	DR.											
679	JAMB/CASING	METAL	A	INTACT	GREY	OFFICE 3			BLDG 960	Negative	< LOD	0.1
	DR.											
680	JAMB/CASING	WOOD	C	INTACT	GREY	OFFICE 4			BLDG 960	Negative	< LOD	0.03
681	DOOR	WOOD	C	INTACT	GREY	OFFICE 4			BLDG 960	Negative	< LOD	0.03
682	CEILING	DRYWALL	CEILING	INTACT	WHITE	OFFICE 4			BLDG 960	Negative	< LOD	0.03
683	WALL	DRYWALL	A	INTACT	WHITE	OFFICE 4			BLDG 960	Negative	< LOD	0.03
684	WALL	DRYWALL	B	INTACT	WHITE	OFFICE 4			BLDG 960	Negative	< LOD	0.03
685	WALL	DRYWALL	C	INTACT	WHITE	OFFICE 4			BLDG 960	Negative	< LOD	0.03
686	WALL	DRYWALL	D	INTACT	WHITE	OFFICE 4			BLDG 960	Negative	< LOD	0.03
687	WALL	DRYWALL	D	INTACT	WHITE	OFFICE 5			BLDG 960	Negative	< LOD	0.03
688	WALL	DRYWALL	C	INTACT	WHITE	OFFICE 5			BLDG 960	Negative	< LOD	0.03
689	WALL	DRYWALL	B	INTACT	WHITE	OFFICE 5			BLDG 960	Negative	< LOD	0.03
690	WALL	DRYWALL	A	INTACT	WHITE	OFFICE 5			BLDG 960	Negative	< LOD	0.03
691	CEILING	DRYWALL	CEILING	INTACT	WHITE	OFFICE 5			BLDG 960	Negative	< LOD	0.03
692	DOOR	WOOD	B	INTACT	GREY	OFFICE 5			BLDG 960	Negative	< LOD	0.03
	DR.											
693	JAMB/CASING	WOOD	B	INTACT	GREY	OFFICE 5 WARE			BLDG 960	Negative	< LOD	0.03
694	WALL	DRYWALL	A	INTACT	WHITE	HOUSE			BLDG 960	Negative	< LOD	0.39



XRF Analysis Data

Reading No	COMPONENT	SUBSTRATE	SIDE	CONDITION	COLOR	ROOM	ROOM NUMBER	FLOOR	SITE ADDRESS	Results	PbC	PbC Error
695	WALL	METAL	B	INTACT	WHITE	WARE HOUSE			BLDG 960	Negative	< LOD	0.08
696	COLUMN DR.	METAL	B	INTACT	BROWN	WARE HOUSE			BLDG 960	Negative	0.6	0.3
697	JAMB/CASING DR.	METAL	B	INTACT	WHITE	WARE HOUSE			BLDG 960	Negative	< LOD	0.05
698	JAMB/CASING	METAL	B	INTACT	BROWN	WARE HOUSE			BLDG 960	Negative	0.3	0.18
699	DOOR	METAL	B	INTACT	BROWN	WARE HOUSE			BLDG 960	Negative	0.28	0.18
700	LADDER RUNG	METAL	A	INTACT	BLACK	WARE HOUSE			BLDG 960	Negative	< LOD	0.07
701	LADDER STRINGER	METAL	A	INTACT	BLACK	WARE HOUSE			BLDG 960	Negative	< LOD	0.03
702	WALL	METAL	C	INTACT	WHITE	WARE HOUSE			BLDG 960	Negative	< LOD	0.08
703	COLUMN	METAL	C	INTACT	BROWN	WARE HOUSE			BLDG 960	Negative	< LOD	0.06
704	COLUMN	METAL	C	INTACT	RED	WARE HOUSE			BLDG 960	Negative	< LOD	0.25
705	BALUSTRADE	METAL	CENTER	INTACT	YELLOW	WARE HOUSE			BLDG 960	Positive	1.5	0.5
706	BALUSTRADE	METAL	CENTER	INTACT	BLACK	WARE HOUSE			BLDG 960	Null	0.9	0.1
707	BALUSTRADE	METAL	CENTER	INTACT	YELLOW	WARE HOUSE			BLDG 960	Positive	1.4	0.4
708	BALUSTRADE	METAL	CENTER	INTACT	YELLOW	WARE HOUSE			BLDG 960	Positive	1.3	0.3
709	BALUSTRADE	METAL	CENTER	INTACT	YELLOW	WARE HOUSE			BLDG 960	Positive	1.7	0.5
710	SHELVING	METAL	CENTER	INTACT	RED	HOUSE			BLDG 960	Positive	1.5	0.5



XRF Analysis Data

Reading No	COMPONENT	SUBSTRATE	SIDE	CONDITION	COLOR	ROOM	ROOM NUMBER	FLOOR	SITE ADDRESS	Results	PbC	PbC Error
711	SHELVING	METAL	CENTER	INTACT	GREEN	WARE HOUSE			BLDG 960	Negative	< LOD	0.16
712	SHELVING	METAL	CENTER	INTACT	GREEN	WARE HOUSE			BLDG 960	Negative	< LOD	0.26
713	SHELVING	METAL	CENTER	INTACT	RED	WARE HOUSE			BLDG 960	Negative	0.7	0.2
714	SHELVING	METAL	CENTER	INTACT	RED	WARE HOUSE			BLDG 960	Negative	0.7	0.3
715	SHELVING	METAL	CENTER	INTACT	RED	WARE HOUSE			BLDG 960	Positive	1.4	0.4
716	SHELVING	METAL	CENTER	INTACT	RED	WARE HOUSE			BLDG 960	Positive	1.3	0.3
717	SHELVING	METAL	CENTER	INTACT	RED	WARE HOUSE			BLDG 960	Positive	1.2	0.2
718	STR RAIL	METAL	D	INTACT	WHITE	WARE HOUSE			BLDG 960	Negative	< LOD	0.19
719	STR BALUSTER	METAL	D	INTACT	WHITE	WARE HOUSE			BLDG 960	Negative	< LOD	0.03
720	STR STRINGER	METAL	D	INTACT	WHITE	WARE HOUSE			BLDG 960	Negative	< LOD	0.03
721	STR TREAD	METAL	D	INTACT	WHITE	WARE HOUSE			BLDG 960	Negative	< LOD	0.03
722	STR SUPPORT COLUMN	METAL	D	INTACT	WHITE	WARE HOUSE			BLDG 960	Negative	< LOD	0.03
723	ELEC BOX	METAL	A	INTACT	BLUE	WARE HOUSE			BLDG 960	Negative	< LOD	0.24
724	ELEC BOX	METAL	A	INTACT	GREY	WARE HOUSE			BLDG 960	Negative	< LOD	0.25
725	DOOR DR.	WOOD	A	INTACT	GREY	ROOM VAULT			BLDG 960	Negative	< LOD	0.03
726	JAMB/CASING	METAL	A	INTACT	GREY	ROOM VAULT			BLDG 960	Negative	< LOD	0.06



XRF Analysis Data

Reading No	COMPONENT	SUBSTRATE	SIDE	CONDITION	COLOR	ROOM	ROOM NUMBER	FLOOR	SITE ADDRESS	Results	PbC	PbC Error
727	CEILING	DRYWALL	CEILING	INTACT	WHITE	VAULT ROOM			BLDG 960	Negative	< LOD	0.03
728	WALL	DRYWALL	A	INTACT	WHITE	VAULT ROOM			BLDG 960	Negative	< LOD	0.03
729	WALL	DRYWALL	B	INTACT	WHITE	VAULT ROOM			BLDG 960	Negative	< LOD	0.03
730	WALL	CINDER BLOCK	C	INTACT	WHITE	VAULT ROOM			BLDG 960	Negative	< LOD	0.03
731	WALL	CINDER BLOCK	D	INTACT	WHITE	VAULT ROOM			BLDG 960	Negative	< LOD	0.03
732	ELEC PANEL	METAL	B	INTACT	GREY	VAULT ROOM			BLDG 960	Negative	< LOD	0.19
733	VAULT	METAL	CENTER	INTACT	BEIGE	ROOM			BLDG 960	Negative	< LOD	0.03
734	WALL	DRYWALL	A	INTACT	WHITE	OFFICE 12			BLDG 960	Negative	< LOD	0.07
735	WALL	DRYWALL	B	INTACT	WHITE	OFFICE 12			BLDG 960	Negative	< LOD	0.03
736	WALL	DRYWALL	C	INTACT	WHITE	OFFICE 12			BLDG 960	Negative	< LOD	0.03
737	WALL	DRYWALL	D	INTACT	WHITE	OFFICE 12			BLDG 960	Negative	< LOD	0.05
738	CHAIR RAIL	WOOD	D	INTACT	WHITE	OFFICE 12			BLDG 960	Negative	< LOD	0.03
739	CEILING	METAL	CEILING	INTACT	WHITE	CAFETERIA			BLDG 960	Negative	< LOD	0.03
740	CEILING	PLASTER	CEILING	INTACT	WHITE	CAFETERIA			BLDG 960	Negative	< LOD	0.03
741	COLUMN	METAL	A	INTACT	RED	CAFETERIA			BLDG 960	Negative	< LOD	0.15
742	COLUMN DR.	METAL	CENTER	INTACT	RED	CAFETERIA			BLDG 960	Negative	< LOD	0.05
743	JAMB/CASING	WOOD	A	INTACT	GREY	CAFETERIA			BLDG 960	Negative	< LOD	0.03
744	WALL	DRYWALL	B	INTACT	ORANGE	CAFETERIA			BLDG 960	Negative	0.5	0.2
745	CEILING	METAL	CEILING	INTACT	ORANGE	CAFETERIA			BLDG 960	Negative	0.3	0.18
746	WALL	DRYWALL	D	INTACT	TAN	CAFETERIA			BLDG 960	Negative	0.4	0.2
747	DOOR	WOOD	C	INTACT	ORANGE	OFFICE 2			BLDG 960	Negative	< LOD	0.05



XRF Analysis Data

Reading No	COMPONENT	SUBSTRATE	SIDE	CONDITION	COLOR	ROOM	ROOM NUMBER	FLOOR	SITE ADDRESS	Results	PbC	PbC Error
	DR.											
748	JAMB/CASING	METAL	C	INTACT	ORANGE	OFFICE 2			BLDG 960	Negative	< LOD	0.13
749	CEILING	METAL	CEILING	INTACT	WHITE	ROOM 11			BLDG 960	Negative	< LOD	0.06
750	WALL	METAL	A	INTACT	WHITE	ROOM 11			BLDG 960	Negative	< LOD	0.05
751	WALL	METAL	B	INTACT	WHITE	ROOM 11			BLDG 960	Negative	< LOD	0.29
752	WALL	METAL	C	INTACT	WHITE	ROOM 11			BLDG 960	Negative	< LOD	0.08
753	WALL	METAL	D	INTACT	WHITE	ROOM 11			BLDG 960	Negative	< LOD	0.05
754	WALL	METAL	D	INTACT	WHITE	ROOM 10			BLDG 960	Negative	< LOD	0.19
755	WALL	METAL	C	INTACT	WHITE	ROOM 10			BLDG 960	Negative	< LOD	0.07
756	WALL	METAL	B	INTACT	WHITE	ROOM 10			BLDG 960	Negative	< LOD	0.05
757	WALL	METAL	A	INTACT	WHITE	ROOM 10			BLDG 960	Negative	< LOD	0.06
758	CEILING	METAL	CEILING	INTACT	WHITE	ROOM 10			BLDG 960	Negative	< LOD	0.07
759	WALL	METAL	D	INTACT	WHITE	HALL 4			BLDG 960	Negative	< LOD	0.11
760	WALL	PLASTER	D	INTACT	BEIGE	HALL 4			BLDG 960	Negative	< LOD	0.05
761	WALL	DRYWALL	D	INTACT	BEIGE	HALL 4			BLDG 960	Negative	< LOD	0.03
762	WALL	DRYWALL	B	INTACT	BEIGE	HALL 4			BLDG 960	Negative	< LOD	0.03
763	LADDER RUNG	METAL	D	INTACT	BROWN	HALL 4			BLDG 960	Negative	< LOD	0.03
	LADDER											
764	STRINGER	METAL	D	INTACT	BROWN	HALL 4			BLDG 960	Negative	< LOD	0.06
765	BALUSTRADE	METAL	D	INTACT	YELLOW	HALL 4			BLDG 960	Negative	0.6	0.2
766	BALUSTRADE	METAL	D	INTACT	YELLOW	HALL 4			BLDG 960	Negative	0.7	0.3
767	DOOR	METAL	B	INTACT	BEIGE	HALL 4			BLDG 960	Negative	< LOD	0.06
	DR.											
768	JAMB/CASING	METAL CINDER	B	INTACT	BEIGE	HALL 4			BLDG 960	Negative	< LOD	0.08
769	WALL	BLOCK	B	INTACT	WHITE	HALL 4			BLDG 960	Negative	< LOD	0.03
770	ELEC BOX	METAL	B	INTACT	GREY	HALL 4			BLDG 960	Negative	< LOD	0.12
771	WALL	METAL	A	INTACT	WHITE	HALL 4			BLDG 960	Negative	< LOD	0.03
772	SCALE	METAL	B	INTACT	BLUE	HALL 4			BLDG 960	Negative	< LOD	0.03
773	WALL	DRYWALL	A	INTACT	BEIGE	HALL 4			BLDG 960	Negative	< LOD	0.03



XRF Analysis Data

Reading No	COMPONENT	SUBSTRATE	SIDE	CONDITION	COLOR	ROOM	ROOM NUMBER	FLOOR	SITE ADDRESS	Results	PbC	PbC Error
774	WALL	METAL	A	INTACT	WHITE	ROOM 6			BLDG 960	Negative	< LOD	0.07
775	WALL	METAL	B	INTACT	WHITE	ROOM 6			BLDG 960	Negative	< LOD	0.07
776	WALL	METAL	C	INTACT	WHITE	ROOM 6			BLDG 960	Negative	< LOD	0.07
777	WALL	METAL	D	INTACT	WHITE	ROOM 6			BLDG 960	Negative	< LOD	0.06
778	CEILING	METAL	CEILING	INTACT	WHITE	ROOM 6			BLDG 960	Negative	< LOD	0.06
779	COLUMN	METAL	C	INTACT	RED	ROOM 6			BLDG 960	Negative	< LOD	0.07
780	CROSS BEAM	METAL	CEILING	INTACT	RED	ROOM 6			BLDG 960	Negative	< LOD	0.04
781	CROSS BEAM	METAL	CEILING	INTACT	WHITE	ROOM 6			BLDG 960	Negative	< LOD	0.03
		CERAMIC										
782	FLOOR	TILE	FLOOR	INTACT	RED	ROOM 6			BLDG 960	Negative	< LOD	0.03
783	WALL	METAL	A	INTACT	WHITE	HALL 3			BLDG 960	Negative	< LOD	0.05
784	WALL	METAL	A	INTACT	WHITE	HALL 3			BLDG 960	Negative	< LOD	0.05
785	WALL	METAL	C	INTACT	WHITE	HALL 3			BLDG 960	Negative	< LOD	0.05
786	WALL	METAL	D	INTACT	WHITE	HALL 3			BLDG 960	Negative	< LOD	0.15
787	CEILING	METAL	CEILING	INTACT	WHITE	ROOM 9			BLDG 960	Negative	< LOD	0.03
788	WALL	METAL	A	INTACT	WHITE	ROOM 9			BLDG 960	Negative	< LOD	0.05
789	WALL	METAL	B	INTACT	WHITE	ROOM 9			BLDG 960	Negative	< LOD	0.04
790	WALL	METAL	C	INTACT	WHITE	ROOM 9			BLDG 960	Negative	< LOD	0.04
791	WALL	METAL	D	INTACT	WHITE	ROOM 9			BLDG 960	Negative	< LOD	0.05
792	COLUMN	METAL	CENTER	INTACT	WHITE	ROOM 9			BLDG 960	Negative	< LOD	0.19
793	COLUMN	METAL	CENTER	INTACT	WHITE	ROOM 8			BLDG 960	Negative	< LOD	0.14
794	WALL	METAL	A	INTACT	WHITE	ROOM 8			BLDG 960	Negative	< LOD	0.04
795	WALL	METAL	B	INTACT	WHITE	ROOM 8			BLDG 960	Negative	< LOD	0.05
796	WALL	METAL	C	INTACT	WHITE	ROOM 8			BLDG 960	Negative	< LOD	0.04
797	WALL	METAL	D	INTACT	WHITE	ROOM 8			BLDG 960	Negative	< LOD	0.04
798	CEILING	METAL	CEILING	INTACT	WHITE	ROOM 8			BLDG 960	Negative	< LOD	0.04
799	CEILING	METAL	CEILING	INTACT	WHITE	ROOM 7			BLDG 960	Negative	< LOD	0.05
800	WALL	METAL	A	INTACT	WHITE	ROOM 7			BLDG 960	Negative	< LOD	0.07
801	WALL	METAL	B	INTACT	WHITE	ROOM 7			BLDG 960	Negative	< LOD	0.04
802	WALL	METAL	C	INTACT	WHITE	ROOM 7			BLDG 960	Negative	< LOD	0.06
803	WALL	METAL	D	INTACT	WHITE	ROOM 7			BLDG 960	Negative	< LOD	0.12



XRF Analysis Data

Reading No	COMPONENT	SUBSTRATE	SIDE	CONDITION	COLOR	ROOM	ROOM NUMBER	FLOOR	SITE ADDRESS	Results	PbC	PbC Error
804	DR. JAMB/CASING	METAL	B	INTACT	YELLOW	ROOM 7			BLDG 960	Negative	< LOD	0.04
805	DOOR	METAL	B	INTACT	YELLOW	ROOM 7			BLDG 960	Negative	< LOD	0.2
806	SINK	CERAMIC COATED CERAMIC	D	INTACT	WHITE	ROOM 8			BLDG 960	Negative	< LOD	0.04
807	FLOOR	TILE	FLOOR	INTACT	RED	HALL 1			BLDG 960	Negative	< LOD	0.03
808	WALL	DRYWALL	C	INTACT	ORANGE	HALL 1			BLDG 960	Negative	0.3	0.13
809	WALL	DRYWALL	A	INTACT	ORANGE	HALL 1			BLDG 960	Null	< LOD	0.45
810	WALL	DRYWALL	A	INTACT	ORANGE	HALL 1			BLDG 960	Negative	< LOD	0.03
811	CEILING	METAL	CEILING	INTACT	ORANGE	HALL 1			BLDG 960	Negative	0.4	0.2
812	DR. JAMB/CASING	WOOD	D	INTACT	GREY	HALL 1			BLDG 960	Negative	< LOD	0.03
813	CEILING	METAL	CEILING	INTACT	WHITE	ROOM 5			BLDG 960	Negative	< LOD	0.05
814	WALL	METAL	A	INTACT	WHITE	ROOM 5			BLDG 960	Negative	< LOD	0.04
815	WALL	METAL	B	INTACT	WHITE	ROOM 5			BLDG 960	Negative	< LOD	0.07
816	WALL	METAL	C	INTACT	WHITE	ROOM 5			BLDG 960	Negative	< LOD	0.08
817	WALL	METAL	D	INTACT	WHITE	ROOM 5			BLDG 960	Negative	< LOD	0.04
818	SHELVING	METAL	CENTER	INTACT	GREEN	ROOM 5			BLDG 960	Negative	< LOD	0.11
819	SHELVING	METAL	CENTER	INTACT	GREEN	ROOM 5			BLDG 960	Negative	< LOD	0.14
820	DR. JAMB/CASING	METAL	B	INTACT	RED	ROOM 5			BLDG 960	Negative	< LOD	0.03
821	DOOR	METAL	B	INTACT	WHITE	ROOM 5			BLDG 960	Negative	< LOD	0.03
822	ELEC BOX	METAL	B	INTACT	GREY	ROOM 5			BLDG 960	Negative	< LOD	0.04
823	CEILING	DRYWALL	CEILING	INTACT	WHITE	ROOM 3			BLDG 960	Negative	< LOD	0.03
824	WALL	DRYWALL	A	INTACT	WHITE	ROOM 3			BLDG 960	Negative	< LOD	0.03
825	WALL	DRYWALL	B	INTACT	WHITE	ROOM 3			BLDG 960	Negative	< LOD	0.03



XRF Analysis Data

Reading No	COMPONENT	SUBSTRATE	SIDE	CONDITION	COLOR	ROOM	ROOM NUMBER	FLOOR	SITE ADDRESS	Results	PbC	PbC Error
826	WALL	DRYWALL	C	INTACT	WHITE	ROOM 3			BLDG 960	Negative	< LOD	0.03
827	WALL	DRYWALL	D	INTACT	WHITE	ROOM 3			BLDG 960	Negative	< LOD	0.03
828	DOOR	WOOD	C	INTACT	TAN	ROOM 3			BLDG 960	Negative	< LOD	0.03
	DR.											
829	JAMB/CASING	METAL	C	INTACT	TAN	ROOM 3			BLDG 960	Negative	< LOD	0.03
	DR.											
830	JAMB/CASING	METAL	C	INTACT	TAN	ROOM 4			BLDG 960	Negative	< LOD	0.05
831	CEILING	DRYWALL	CEILING	INTACT	WHITE	ROOM 4			BLDG 960	Negative	< LOD	0.12
832	WALL	DRYWALL	A	INTACT	WHITE	ROOM 4			BLDG 960	Negative	< LOD	0.03
833	WALL	DRYWALL	B	INTACT	WHITE	ROOM 4			BLDG 960	Negative	< LOD	0.03
834	WALL	DRYWALL	C	INTACT	WHITE	ROOM 4			BLDG 960	Negative	< LOD	0.05
835	WALL	DRYWALL	D	INTACT	WHITE	ROOM 4			BLDG 960	Negative	< LOD	0.03
836	WALL	DRYWALL	A	INTACT	WHITE	HALL 2			BLDG 960	Negative	< LOD	0.03
837	CEILING	DRYWALL	CEILING	INTACT	WHITE	HALL 2			BLDG 960	Negative	< LOD	0.23
838	WALL	DRYWALL	C	INTACT	WHITE	HALL 2			BLDG 960	Negative	< LOD	0.03
839	WALL	METAL	C	INTACT	WHITE	HALL 2			BLDG 960	Negative	< LOD	0.07
840	WALL	METAL	B	INTACT	WHITE	HALL 2			BLDG 960	Negative	< LOD	0.06
841	WALL	DRYWALL	D	INTACT	WHITE	HALL 2			BLDG 960	Negative	< LOD	0.05
	DR.											
842	JAMB/CASING	METAL	D	INTACT	RED	HALL 2			BLDG 960	Negative	< LOD	0.03
	DR.											
843	JAMB/CASING	METAL	B	INTACT	YELLOW	OFFICE 14			BLDG 960	Negative	< LOD	0.04
844	DOOR	WOOD	B	INTACT	YELLOW	OFFICE 14			BLDG 960	Negative	< LOD	0.04
845	WALL	DRYWALL	A	INTACT	PINK	OFFICE 14			BLDG 960	Negative	< LOD	0.03
846	WALL	DRYWALL	B	INTACT	PINK	OFFICE 14			BLDG 960	Negative	< LOD	0.03
847	WALL	DRYWALL	C	INTACT	PINK	OFFICE 14			BLDG 960	Negative	< LOD	0.04
848	WALL	DRYWALL	D	INTACT	PINK	OFFICE 14			BLDG 960	Negative	< LOD	0.03
						MEN'S BATH						
	DR.					ROOM -						
849	JAMB/CASING	METAL	C	INTACT	ORANGE	HALL 2			BLDG 960	Negative	< LOD	0.03



XRF Analysis Data

Reading No	COMPONENT	SUBSTRATE	SIDE	CONDITION	COLOR	ROOM	ROOM NUMBER	FLOOR	SITE ADDRESS	Results	PbC	PbC Error
850	DOOR	WOOD	C	INTACT	ORANGE	MEN'S BATH ROOM - HALL 2			BLDG 960	Negative	< LOD	0.03
851	CEILING	DRYWALL	CEILING	INTACT	WHITE	MEN'S BATH ROOM - HALL 2			BLDG 960	Negative	< LOD	0.03
852	WALL	DRYWALL	A	INTACT	WHITE	MEN'S BATH ROOM - HALL 2			BLDG 960	Negative	< LOD	0.03
853	WALL	DRYWALL	B	INTACT	WHITE	MEN'S BATH ROOM - HALL 2			BLDG 960	Negative	< LOD	0.03
854	WALL	DRYWALL	C	INTACT	WHITE	MEN'S BATH ROOM - HALL 2			BLDG 960	Negative	< LOD	0.05
855	WALL	DRYWALL	D	INTACT	WHITE	MEN'S BATH ROOM - HALL 2			BLDG 960	Negative	< LOD	0.03
856	WALL	CERAMIC TILE	D	INTACT	BROWN	MEN'S BATH ROOM - HALL 2			BLDG 960	Negative	< LOD	0.12
857	FLOOR	CERAMIC TILE	FLOOR	INTACT	BROWN	MEN'S BATH ROOM - HALL 2			BLDG 960	Negative	< LOD	0.03
858	STALL WALL	METAL	A	INTACT	ORANGE	MEN'S BATH ROOM - HALL 2			BLDG 960	Negative	0.7	0.3
859	STALL DOOR	METAL	A	INTACT	ORANGE	MEN'S BATH ROOM - HALL 2			BLDG 960	Null	0.9	0.1



XRF Analysis Data

Reading No	COMPONENT	SUBSTRATE	SIDE	CONDITION	COLOR	ROOM	ROOM NUMBER	FLOOR	SITE ADDRESS	Results	PbC	PbC Error
860	STALL DOOR	METAL	A	INTACT	ORANGE	MEN'S BATH ROOM - HALL 2			BLDG 960	Negative	0.6	0.3
861	TOILET	CERAMIC COATED	FLOOR	INTACT	WHITE	MEN'S BATH ROOM - HALL 2			BLDG 960	Negative	< LOD	0.04
862	URINAL	CERAMIC COATED	B	INTACT	WHITE	MEN'S BATH ROOM - HALL 2			BLDG 960	Negative	< LOD	0.04
863	SINK	CERAMIC COATED	B	INTACT	WHITE	MEN'S BATH ROOM - HALL 2			BLDG 960	Negative	< LOD	0.11
864	SINK	CERAMIC COATED	B	INTACT	WHITE	WOMEN'S BATH ROOM - HALL 2			BLDG 960	Negative	< LOD	0.11
865	TOILET	CERAMIC COATED	B	INTACT	WHITE	WOMEN'S BATH ROOM - HALL 2			BLDG 960	Negative	< LOD	0.25
866	STALL WALL	METAL	A	INTACT	YELLOW	WOMEN'S BATH ROOM - HALL 2			BLDG 960	Negative	0.5	0.2
867	STALL DOOR	METAL	A	INTACT	YELLOW	WOMEN'S BATH ROOM - HALL 2			BLDG 960	Negative	0.4	0.2
868	WALL	CERAMIC TILE	A	INTACT	YELLOW	WOMEN'S BATH ROOM - HALL 2			BLDG 960	Negative	< LOD	0.21
869	FLOOR	CERAMIC TILE	FLOOR	INTACT	BROWN	WOMEN'S BATH ROOM - HALL 2			BLDG 960	Negative	< LOD	0.04



XRF Analysis Data

Reading No	COMPONENT	SUBSTRATE	SIDE	CONDITION	COLOR	ROOM	ROOM NUMBER	FLOOR	SITE ADDRESS	Results	PbC	PbC Error
870	CEILING	DRYWALL	CEILING	INTACT	GREY	WOMEN'S BATH ROOM - HALL 2			BLDG 960	Negative	< LOD	0.03
871	WALL	DRYWALL	A	INTACT	GREY	WOMEN'S BATH ROOM - HALL 2			BLDG 960	Negative	< LOD	0.04
872	WALL	DRYWALL	B	INTACT	GREY	WOMEN'S BATH ROOM - HALL 2			BLDG 960	Negative	< LOD	0.03
873	WALL	DRYWALL	C	INTACT	GREY	WOMEN'S BATH ROOM - HALL 2			BLDG 960	Negative	< LOD	0.03
874	WALL	DRYWALL	D	INTACT	GREY	WOMEN'S BATH ROOM - HALL 2			BLDG 960	Negative	< LOD	0.07
875	DOOR	WOOD	C	INTACT	YELLOW	WOMEN'S BATH ROOM - HALL 2			BLDG 960	Negative	< LOD	0.03
876	DR. JAMB/CASING DR.	METAL	C	INTACT	YELLOW	WOMEN'S BATH ROOM - HALL 2			BLDG 960	Negative	< LOD	0.03
877	JAMB/CASING	METAL	C	INTACT	GREY	ROOM 1			BLDG 960	Negative	< LOD	0.03
878	DOOR	WOOD	C	INTACT	GREY	ROOM 1			BLDG 960	Negative	< LOD	0.06
879	CEILING	METAL	CEILING	INTACT	GREY	ROOM 1			BLDG 960	Negative	0.3	0.13
880	WALL	DRYWALL	A	INTACT	GREY	ROOM 1			BLDG 960	Negative	< LOD	0.03
881	WALL	DRYWALL	B	INTACT	GREY	ROOM 1			BLDG 960	Negative	< LOD	0.03
882	WALL	DRYWALL	C	INTACT	GREY	ROOM 1			BLDG 960	Negative	< LOD	0.03
883	WALL	DRYWALL	D	INTACT	GREY	ROOM 1			BLDG 960	Negative	< LOD	0.07
884	WALL	METAL	D	INTACT	WHITE	ROOM 2			BLDG 960	Negative	< LOD	0.06
885	WALL	METAL	D	INTACT	WHITE	ROOM 2			BLDG 960	Negative	< LOD	0.06
886	WALL	METAL	C	INTACT	WHITE	ROOM 2			BLDG 960	Negative	< LOD	0.15



XRF Analysis Data

Reading No	COMPONENT	SUBSTRATE	SIDE	CONDITION	COLOR	ROOM	ROOM NUMBER	FLOOR	SITE ADDRESS	Results	PbC	PbC Error
887	WALL	METAL	B	INTACT	WHITE	ROOM 2			BLDG 960	Negative	< LOD	0.05
888	WALL	METAL	A	INTACT	WHITE	ROOM 2			BLDG 960	Negative	< LOD	0.04
889	CEILING DR.	METAL	CEILING	INTACT	WHITE	ROOM 2			BLDG 960	Negative	< LOD	0.04
890	JAMB/CASING	METAL	D	INTACT	WHITE	ROOM 2			BLDG 960	Negative	< LOD	0.06
891	DOOR	METAL CERAMIC COATED	D	INTACT	WHITE	ROOM 2			BLDG 960	Negative	< LOD	0.06
892	SINK		C	INTACT	WHITE	ROOM 1 SALES FLOOR			BLDG 960	Negative	< LOD	0.06
893	WALL	DRYWALL	A	INTACT	WHITE	ROOM 1 SALES FLOOR			BLDG 960	Negative	< LOD	0.03
894	WALL	DRYWALL	B	INTACT	WHITE	ROOM 1 SALES FLOOR			BLDG 960	Negative	< LOD	0.05
895	WALL	DRYWALL	C	INTACT	WHITE	ROOM 1 SALES FLOOR			BLDG 960	Negative	< LOD	0.03
896	CEILING	PLASTER	CEILING	INTACT	WHITE	ROOM 1 SALES FLOOR			BLDG 960	Negative	< LOD	0.03
897	CEILING	METAL	CEILING	INTACT	WHITE	ROOM 1 SALES FLOOR			BLDG 960	Negative	< LOD	0.03
898	WNDW CASING	METAL	D	INTACT	BROWN	ROOM 1 SALES FLOOR			BLDG 960	Negative	< LOD	0.03
899	DOOR DR.	METAL	D	INTACT	BROWN	ROOM 1 SALES FLOOR			BLDG 960	Negative	< LOD	0.03
900	JAMB/CASING	METAL	D	INTACT	BROWN	ROOM 1 SALES FLOOR			BLDG 960	Negative	< LOD	0.03
901	COLUMN	METAL	CENTER	INTACT	RED	ROOM 1 SALES FLOOR			BLDG 960	Negative	< LOD	0.04
902	COLUMN	METAL	CENTER	INTACT	RED	ROOM 1 SALES FLOOR			BLDG 960	Negative	< LOD	0.03
903	COLUMN DR.	METAL	CENTER	INTACT	RED	ROOM 1 SALES FLOOR			BLDG 960	Negative	< LOD	0.05
904	JAMB/CASING	METAL	C	INTACT	GREY	OFFICE 13			BLDG 960	Negative	< LOD	0.07



XRF Analysis Data

Reading No	COMPONENT	SUBSTRATE	SIDE	CONDITION	COLOR	ROOM	ROOM NUMBER	FLOOR	SITE ADDRESS	Results	PbC	PbC Error
905	DOOR	WOOD	C	INTACT	GREY	OFFICE 13			BLDG 960	Negative	< LOD	0.04
906	WALL	DRYWALL	A	INTACT	WHITE	OFFICE 13			BLDG 960	Negative	< LOD	0.03
907	WALL	DRYWALL	A	INTACT	WHITE	OFFICE 13			BLDG 960	Negative	< LOD	0.03
908	WALL	DRYWALL	C	INTACT	WHITE	OFFICE 13			BLDG 960	Negative	< LOD	0.03
909	WALL	DRYWALL	D	INTACT	WHITE	OFFICE 13			BLDG 960	Negative	< LOD	0.03
						MEN'S BATH ROOM - SALES FLOOR						
910	DOOR	WOOD	B	INTACT	GREY	MEN'S BATH ROOM - SALES FLOOR			BLDG 960	Negative	< LOD	0.03
						MEN'S BATH ROOM - SALES FLOOR						
911	DR. JAMB/CASING	METAL	B	INTACT	GREY	MEN'S BATH ROOM - SALES FLOOR			BLDG 960	Negative	< LOD	0.03
						MEN'S BATH ROOM - SALES FLOOR						
912	WALL	CERAMIC TILE	A	INTACT	GREY	MEN'S BATH ROOM - SALES FLOOR			BLDG 960	Negative	< LOD	0.08
						MEN'S BATH ROOM - SALES FLOOR						
913	BASEBOARD	CERAMIC TILE	A	INTACT	BROWN	MEN'S BATH ROOM - SALES FLOOR			BLDG 960	Negative	< LOD	0.08
						MEN'S BATH ROOM - SALES FLOOR						
914	FLOOR	CERAMIC TILE	FLOOR	INTACT	BROWN	MEN'S BATH ROOM - SALES FLOOR			BLDG 960	Negative	< LOD	0.03
						MEN'S BATH ROOM - SALES FLOOR						
915	WALL	DRYWALL	A	INTACT	WHITE	MEN'S BATH ROOM - SALES FLOOR			BLDG 960	Negative	< LOD	0.03



XRF Analysis Data

Reading No	COMPONENT	SUBSTRATE	SIDE	CONDITION	COLOR	ROOM	ROOM NUMBER	FLOOR	SITE ADDRESS	Results	PbC	PbC Error
916	WALL	DRYWALL	B	INTACT	WHITE	MEN'S BATH ROOM - SALES FLOOR			BLDG 960	Negative	< LOD	0.03
917	WALL	DRYWALL	C	INTACT	WHITE	MEN'S BATH ROOM - SALES FLOOR			BLDG 960	Negative	< LOD	0.03
918	WALL	DRYWALL	D	INTACT	WHITE	MEN'S BATH ROOM - SALES FLOOR			BLDG 960	Negative	< LOD	0.03
919	STALL WALL	METAL	A	INTACT	GREY	MEN'S BATH ROOM - SALES FLOOR			BLDG 960	Null	1	0.1
920	STALL WALL	METAL	A	INTACT	GREY	MEN'S BATH ROOM - SALES FLOOR			BLDG 960	Negative	< LOD	0.03
921	STALL DOOR	METAL	A	INTACT	GREY	MEN'S BATH ROOM - SALES FLOOR			BLDG 960	Negative	< LOD	0.03
922	STALL DOOR	METAL	B	INTACT	GREY	WOMEN'S BATHROOM - SALES FLOOR			BLDG 960	Negative	< LOD	0.03
923	STALL WALL	METAL	B	INTACT	GREY	WOMEN'S BATH ROOM - SALES FLOOR			BLDG 960	Negative	< LOD	0.03



XRF Analysis Data

Reading No	COMPONENT	SUBSTRATE	SIDE	CONDITION	COLOR	ROOM	ROOM NUMBER	FLOOR	SITE ADDRESS	Results	PbC	PbC Error
924	WALL	DRYWALL	A	INTACT	WHITE	WOMEN'S BATH ROOM - SALES FLOOR			BLDG 960	Negative	< LOD	0.03
925	WALL	DRYWALL	B	INTACT	WHITE	WOMEN'S BATH ROOM - SALES FLOOR			BLDG 960	Negative	< LOD	0.03
926	WALL	DRYWALL	C	INTACT	WHITE	WOMEN'S BATH ROOM - SALES FLOOR			BLDG 960	Negative	< LOD	0.03
927	WALL	DRYWALL	D	INTACT	WHITE	WOMEN'S BATH ROOM - SALES FLOOR			BLDG 960	Negative	< LOD	0.03
928	FLOOR	CERAMIC TILE	FLOOR	INTACT	BROWN	WOMEN'S BATH ROOM - SALES FLOOR			BLDG 960	Negative	< LOD	0.03
929	BASEBOARD	CERAMIC TILE	A	INTACT	YELLOW	WOMEN'S BATH ROOM - SALES FLOOR			BLDG 960	Negative	< LOD	0.39
930	DR. JAMB/CASING	METAL	C	INTACT	YELLOW	WOMEN'S BATH ROOM - SALES FLOOR			BLDG 960	Negative	< LOD	0.03
931	DOOR	WOOD	C	INTACT	YELLOW	WOMEN'S BATH ROOM - SALES FLOOR			BLDG 960	Negative	< LOD	0.03



XRF Analysis Data

Reading No	COMPONENT	SUBSTRATE	SIDE	CONDITION	COLOR	ROOM	ROOM NUMBER	FLOOR	SITE ADDRESS	Results	PbC	PbC Error
932	DOOR	WOOD	B	INTACT	GREY	EMPLOYEE LOCKER ROOM			BLDG 960	Negative	< LOD	0.03
933	DR. JAMB/CASING	METAL	B	INTACT	GREY	EMPLOYEE LOCKER ROOM			BLDG 960	Negative	< LOD	0.05
934	ELEC PANEL	METAL	B	INTACT	GREY	EMPLOYEE LOCKER ROOM			BLDG 960	Negative	< LOD	0.31
935	CROSS BEAM DR.	METAL	CEILING	INTACT	RED	EMPLOYEE LOCKER ROOM			BLDG 960	Negative	< LOD	0.46
936	JAMB/CASING	METAL	A	INTACT	BROWN	LOBBY 1			BLDG 960	Negative	< LOD	0.03
937	DOOR	METAL	A	INTACT	BROWN	LOBBY 1			BLDG 960	Negative	< LOD	0.03
938	CEILING	METAL	CEILING	INTACT	WHITE	LOBBY 1			BLDG 960	Negative	< LOD	0.03
939	CEILING	STUCCO CERAMIC	CEILING	INTACT	WHITE	LOBBY 1			BLDG 960	Negative	< LOD	0.03
940	WALL	TILE CERAMIC	B	INTACT	WHITE	LOBBY 1			BLDG 960	Positive	< LOD	13.8
941	WALL	TILE CERAMIC	D	INTACT	WHITE	LOBBY 1			BLDG 960	Positive	< LOD	13.05
942	WNDW CASING DR.	METAL	D	INTACT	GREY	LOBBY 1			BLDG 960	Negative	< LOD	0.05
943	JAMB/CASING	METAL	B	INTACT	BROWN	OFFICE 1			BLDG 960	Negative	< LOD	0.03
944	DOOR	METAL	B	INTACT	BROWN	OFFICE 1			BLDG 960	Negative	< LOD	0.03
945	WALL	CINDER BLOCK	A	INTACT	BROWN	OFFICE 1			BLDG 960	Negative	< LOD	0.05
946	WALL	CINDER BLOCK	B	INTACT	BROWN	OFFICE 1			BLDG 960	Negative	< LOD	0.03
947	WALL	CINDER BLOCK	C	INTACT	BROWN	OFFICE 1			BLDG 960	Negative	< LOD	0.03



XRF Analysis Data

Reading No	COMPONENT	SUBSTRATE	SIDE	CONDITION	COLOR	ROOM	ROOM NUMBER	FLOOR	SITE ADDRESS	Results	PbC	PbC Error
948	WALL	CINDER BLOCK	D	INTACT	BROWN	OFFICE 1			BLDG 960	Negative	< LOD	0.13
949	CROSS BEAM	METAL	CEILING	INTACT	RED	OFFICE 1			BLDG 960	Negative	< LOD	0.18
950	DOOR DR.	METAL	A	INTACT	BROWN	LOBBY 2			BLDG 960	Negative	< LOD	0.03
951	JAMB/CASING	METAL	A	INTACT	BROWN	LOBBY 2			BLDG 960	Negative	< LOD	0.03
952	WNDW CASING	METAL	D	INTACT	GREY	LOBBY 2			BLDG 960	Negative	< LOD	0.15
953	CEILING	METAL	CEILING	INTACT	WHITE	LOBBY 2			BLDG 960	Negative	< LOD	0.18
954	CEILING	METAL	CEILING	INTACT	WHITE	LOBBY 2			BLDG 960	Negative	< LOD	0.14
955	BASEBOARD	CERAMIC TILE	D	INTACT	BROWN	LOBBY 2			BLDG 960	Negative	< LOD	0.03
956	WALL	CERAMIC TILE	B	INTACT	WHITE	LOBBY 2			BLDG 960	Positive	< LOD	10.95
957	WALL	CERAMIC TILE	D	INTACT	WHITE	LOBBY 2			BLDG 960	Positive	< LOD	12.9
958	EXT. UPR FLASHING	METAL	D	Not Intact - Chalking	BROWN	LOBBY 2			BLDG 960	Negative	< LOD	0.03
959	DOOR DR.	METAL	D	INTACT	BEIGE	EXTERIOR	CART ROOM		BLDG 960	Negative	< LOD	0.12
960	JAMB/CASING	METAL	D	INTACT	BEIGE	EXTERIOR	CART ROOM		BLDG 960	Negative	< LOD	0.08
961	WALL	CERAMIC TILE	D	INTACT	WHITE	EXTERIOR			BLDG 960	Positive	< LOD	8.55
962	WALL	CERAMIC TILE	D	INTACT	WHITE	EXTERIOR			BLDG 960	Positive	< LOD	10.05
963	WALL LOW TRIM	CERAMIC TILE	D	INTACT	BROWN	EXTERIOR			BLDG 960	Negative	< LOD	0.04
964	COLUMN	CERAMIC TILE	D	INTACT	WHITE	EXTERIOR			BLDG 960	Positive	< LOD	10.35
965	CEILING	STUCCO	D	INTACT	WHITE	EXTERIOR			BLDG 960	Negative	< LOD	0.03



XRF Analysis Data

Reading No	COMPONENT	SUBSTRATE	SIDE	CONDITION	COLOR	ROOM	ROOM NUMBER	FLOOR	SITE ADDRESS	Results	PbC	PbC Error
966	CEILING SKYLIGHT	METAL	D	INTACT	YELLOW	EXTERIOR			BLDG 960	Negative	< LOD	1.72
967	SHUTTER_CAL			INTACT							3.52	0
968	CALIBRATE-FRONT	CALIBRATE-FRONT		INTACT	RED					Positive	1.1	0.1
969	CALIBRATE-FRONT	CALIBRATE-FRONT		INTACT	RED					Positive	1.1	0.1
970	CALIBRATE-FRONT	CALIBRATE-FRONT		INTACT	RED					Positive	1.1	0.1
971	DR. JAMB/CASING	METAL	B	INTACT	RED	EXTERIOR			BLDG 960	Negative	< LOD	0.04
972	DR. JAMB/CASING	METAL	B	INTACT	BEIGE	EXTERIOR			BLDG 960	Negative	< LOD	0.13
973	DOOR	METAL	B	INTACT	BEIGE	EXTERIOR			BLDG 960	Negative	< LOD	0.1
974	STR RAIL	METAL	B	Not Intact - Peeling	BROWN	EXTERIOR			BLDG 960	Negative	< LOD	0.88
975	STR BALUSTER EXT. DWN	METAL	B	Not Intact - Peeling	BROWN	EXTERIOR			BLDG 960	Negative	< LOD	0.41
976	SPOUT	METAL	B	INTACT	WHITE	EXTERIOR			BLDG 960	Negative	< LOD	0.16
977	WALL	METAL	B	INTACT	WHITE	EXTERIOR			BLDG 960	Negative	< LOD	0.18
978	BAILER	METAL	B	Not Intact - Peeling	BLUE	EXTERIOR			BLDG 960	Negative	< LOD	0.03
979	BALUSTRADE	METAL	B	INTACT	YELLOW	EXTERIOR			BLDG 960	Negative	0.7	0.2
980	BALUSTRADE	METAL	B	INTACT	WHITE	EXTERIOR			BLDG 960	Negative	0.7	0.3
981	WALL	METAL	C	INTACT	WHITE	EXTERIOR			BLDG 960	Negative	< LOD	1.03
982	DOOR	METAL	C	INTACT	BROWN	EXTERIOR			BLDG 960	Negative	< LOD	0.05
983	DOOR	METAL	B	INTACT	BROWN	EXTERIOR			BLDG 960	Negative	0.23	0.15
984	DOOR	METAL	B	INTACT	WHITE	EXTERIOR			BLDG 960	Negative	< LOD	0.04
985	CROSS BEAM	METAL	B	INTACT	GREY	EXTERIOR			BLDG 960	Negative	< LOD	0.03



XRF Analysis Data

Reading No	COMPONENT	SUBSTRATE	SIDE	CONDITION	COLOR	ROOM	ROOM NUMBER	FLOOR	SITE ADDRESS	Results	PbC	PbC Error
986	CALIBRATE- BACK	CALIBRATE- BACK			RED					Positive	1.1	0.1
987	CALIBRATE- BACK	CALIBRATE- BACK			RED					Positive	1.1	0.1
988	CALIBRATE- BACK	CALIBRATE- BACK			RED					Positive	1.1	0.1

SITE PLAN

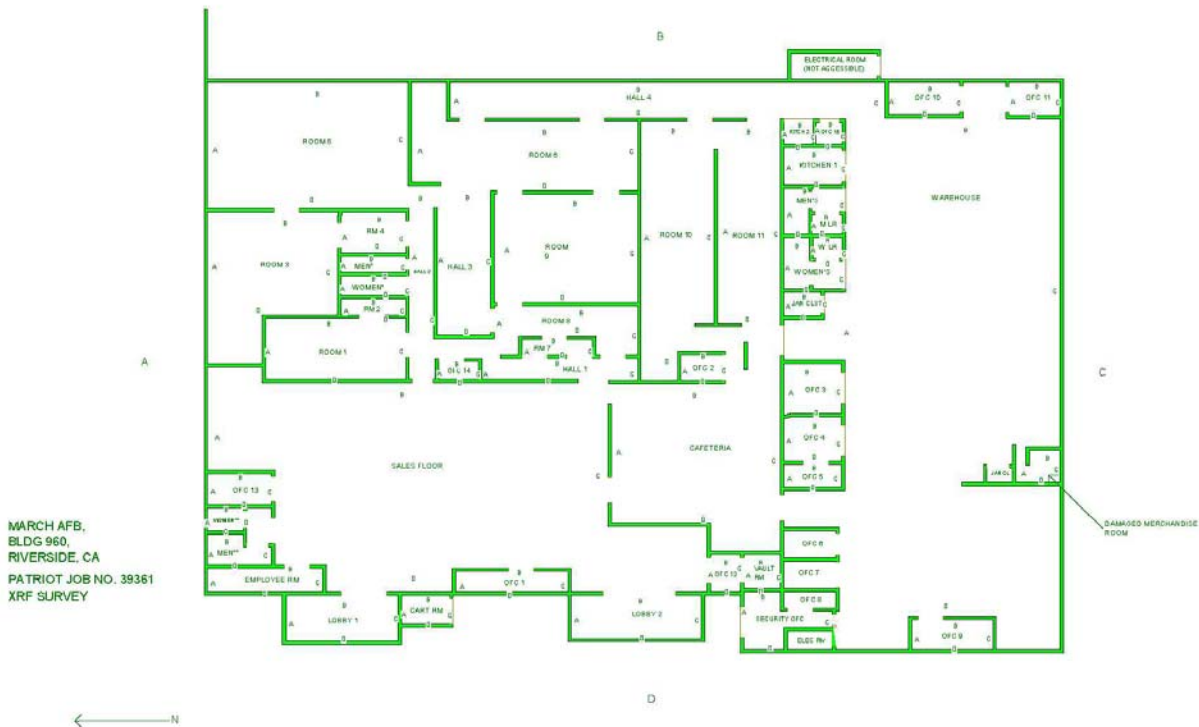

Note: The exterior front side of the building is labeled as Side “A”. Sides B, C & D proceed clockwise from side A.

Entries to each room or room equivalent is Side “A” for building interiors. Sides B, C & D proceed clockwise from side A.

SITE PLAN

MARCH AFB
 BLDG 940
 RIVERSIDE CA
 PATRIOT PROJ NO. 39361
 XRF SURVEY



Note: The exterior front side of the building is labeled as Side "A". Sides B, C & D proceed clockwise from side A.

Entries to each room or room equivalent is Side "A" for building interiors. Sides B, C & D proceed clockwise from side A.

SITE PLAN

MARCH ARB
BLDG 942
RIVERSIDE CA

PATRIOT JOB NO. 39361
XRF SURVEY

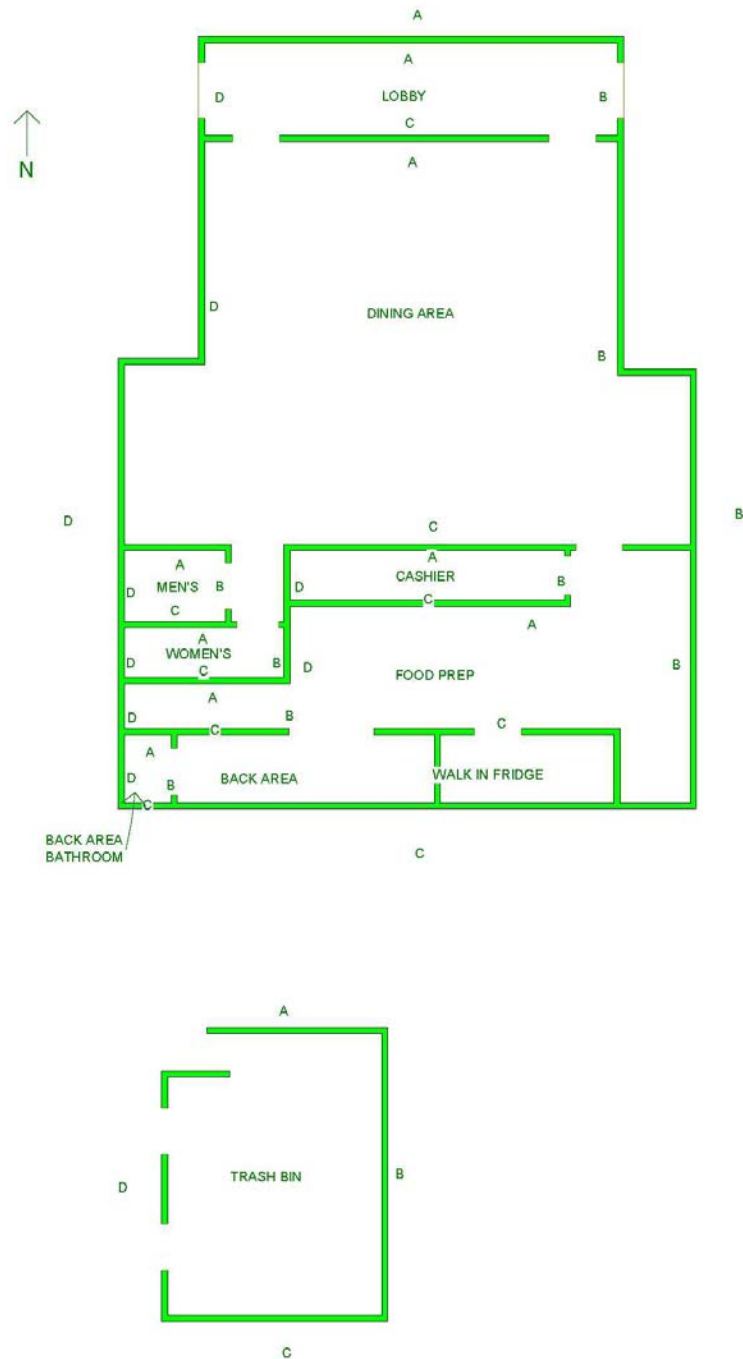

Note: The exterior front side of the building is labeled as Side "A". Sides B, C & D proceed clockwise from side A.

Entries to each room or room equivalent is Side "A" for building interiors. Sides B, C & D proceed clockwise from side A.

LEAD HAZARD EVALUATION REPORT

Section 1 – Date of Lead Hazard Evaluation 9/19/11

Section 2 – Type of Lead Hazard Evaluation (Check one box only)

Lead Inspection Risk assessment Clearance Inspection Other (specify) _____

Section 3 – Structure Where Lead Hazard Evaluation Was Conducted

Address [number, street, apartment (if applicable)]	City	County	Zip Code
1920 Graeber Street, Bldg 940, 942, 960	Riverside	Riverside	92581

Construction date (year) of structure	Type of structure	Children living in structure?
Pre-1978	<input checked="" type="checkbox"/> Multi-unit building <input type="checkbox"/> School or daycare <input type="checkbox"/> Single family dwelling <input checked="" type="checkbox"/> Other <small>Commercial Building Structure</small>	<input type="checkbox"/> Yes <input type="checkbox"/> No <input checked="" type="checkbox"/> Don't Know

Section 4 – Owner of Structure (if business/agency, list contact person)

Name	Telephone number
Owner's Representative - Danielle Wheeler (March JPA)	951-656-7000

Address [number, street, apartment (if applicable)]	City	State	Zip Code
23555 Meyer Drive	Riverside	CA	92518

Section 5 – Results of Lead Hazard Evaluation (check all that apply)

No lead-based paint detected Intact lead-based paint detected Deteriorated lead-based paint detected
 No lead hazards detected Lead-contaminated dust found Lead-contaminated soil found Other _____

Section 6 – Individual Conducting Lead Hazard Evaluation

Name	Telephone number
Michael Hartsfield #14325	714-899-8900

Address [number, street, apartment (if applicable)]	City	State	Zip Code
7271 Garden Grove Blvd., #A	Garden Grove	CA	92841

CDPH certification number	Signature	Date
14325		9/26/11

Name and CDPH certification number of any other individuals conducting sampling or testing (if applicable)

Michael Hartsfield #14325

Section 7 – Attachments

- A. A foundation diagram or sketch of the structure indicating the specific locations of each lead hazard or presence of lead-based paint;
- B. Each testing method, device, and sampling procedure used;
- C. All data collected, including quality control data, laboratory results, including laboratory name, address, and phone number.

First copy and attachments retained by inspector
 Second copy and attachments retained by owner

Third copy only (no attachments) mailed or faxed to:
 California Department of Public Health
 Childhood Lead Poisoning Prevention Branch Reports
 850 Marina Bay Parkway, Building P, Third Floor
 Richmond, CA 94804-6403
 Fax: (510) 620-5656

State of California Department of Public Health

Lead-Related
Construction
Certificate

Certificate
Type

Expiration
Date



Inspector/Assessor

04/26/2012



Michael Hartsfield

ID #: 14325

State of California
Division of Occupational Safety and Health
Certified Asbestos Consultant

Christopher A Blake



Name

Certification No. 01-3027

Expires on 11/09/11

This certification was issued by the Division of Occupational Safety and Health as authorized by Sections 7180 et seq. of the Business and Professions Code.