

ASBESTOS ASSESSMENT REPORT

Building Identification Number: 2995

Report Date: July 1998

Building Description: Dental Clinic

Date of Construction: 1985

Approximate Square Footage: 16,430 SF

Occupied: No

Exterior Components:

The exterior walls of the building are a combination of concrete and stucco. The building has a flat roof covered with built-up roofing material with ballast.

Interior Components:

The building has a concrete slab on grade foundation with a concrete frame. The floors are either bare concrete or are finished with vinyl sheet flooring, carpet and ceramic tiles. The interior walls are finished with drywall. The ceilings are finished with lay-in ceiling tiles.

Previous Survey Information:

No previous survey information was available for this facility.

Findings:

1. The following friable suspect asbestos-containing materials were identified in this facility.
 - a. Non-Asbestos-Containing Fiberglass Pipe Insulation
 - b. Non-Asbestos-Containing White Cloth HVAC Canvas Tape
 - c. Non-Asbestos-Containing Neoprene Insulation
 - d. Non-Asbestos-Containing Supply-Air Fiberglass Duct Insulation
 - e. Non-Asbestos-Containing Metal Wrap Fiberglass Duct Insulation
 - f. Non-Asbestos-Containing 2'x2' Fissured Lay-In Ceiling Tile

2. The following non-friable suspect asbestos-containing materials were identified in the facility.

- a. Non-Asbestos-Containing Built-up Roofing Material w/Ballast
- b. Non-Asbestos-Containing Roofing Material (Parapet Wall)
- c. Asbestos-Containing Roof Mastic
- d. Non-Asbestos-Containing Gray Rubberized Flooring
- e. Non-Asbestos-Containing White/Gray VSF/Mastic
- f. Non-Asbestos-Containing Drywall/Tape/Compound
- g. Non-Asbestos-Containing Baseboard/Mastic
- h. Non-Asbestos-Containing Carpet Mastic
- i. Non-Asbestos-Containing Beige Stucco
- j. Asbestos-Containing Transite Material (Assumed)

The following Suspect/Confirmed Asbestos-Containing Material Inventory lists the material description, general location, sample number, asbestos content, friability, and condition. All materials were sampled during the survey. Materials which were bulk sampled and for which laboratory analysis revealed no detectable level of asbestos present have been included on the table for reference purposes only.

SUSPECT/CONFIRMED ASBESTOS-CONTAINING MATERIAL INVENTORY

MATERIAL DESCRIPTION	LOCATION	SAMPLE NUMBER	ASBESTOS CONTENT	FRIABLE ACM	DAMAGED ACM
Built-up Roofing Material w/Ballast	Roof	2995-01, 02, 03	None Detected	N/A	N/A
Roofing Material (Parapet Wall)	Roof	2995-04, 05, 06	None Detected	N/A	N/A
Roof Mastic	Roof	2995-07, 08, 09	10% Chrysotile	No	No
Fiberglass Pipe Insulation	Throughout the Building	2995-10, 11, 12	None Detected	N/A	N/A
White Cloth HVAC Canvas Tape	Room: 187	2995-13, 14, 15	None Detected	N/A	N/A
Neoprene Insulation	Room: 187	2995-16, 17, 18	None Detected	N/A	N/A
Gray Rubberized Flooring	Rooms: 115, 143, 144, 150, 151, 152, 153, 154, 155, 158, 159, 162, 164, 165, 167, 174, 175, 177, 183, and 189	2995-19, 20, 21	None Detected	N/A	N/A
White/Gray VSF/Mastic	Rooms: 120 through 142, 145, 147, 148, 149, 161, 163, 169, 171, and 172	2995-22, 23, 24	None Detected	N/A	N/A
2'x2' Fissured Lay-In Ceiling Tile	Throughout the Building	2995-25, 26, 27	None Detected	N/A	N/A
Drywall/Tape/Compound	Throughout the Building	2995-28, 29, 30	None Detected	N/A	N/A
Supply-Air Fiberglass Duct Insulation	Air Plenum Area	2995-31, 32, 33	None Detected	N/A	N/A
Metal Wrap Fiberglass Duct Insulation	Air Plenum Area	2995-34, 35, 36	None Detected	N/A	N/A
Baseboard/Mastic	Throughout the Building	2995-37, 38, 39	None Detected	N/A	N/A
Carpet Mastic		2995-40, 41, 42	None Detected	N/A	N/A
Beige Stucco	Exterior of Building	2995-43, 44, 45, 46, 47	None Detected	N/A	N/A
Transite Material	Room: 163 (Countertops and Vent Hood)	Not Sampled (See Note 1)	Assumed	No	No

Note 1: The transite materials located in Room 163 were not sampled because they were in good condition and sampling would cause severe damage. This material should be assumed to be asbestos-containing until bulk samples can be collected and analyzed prior to demolition or renovation.



ASBESTOS MATERIAL INVENTORY	
MATERIAL TYPE	ASBESTOS CONTENT
ROOF MASTIC	10% CHRYSOTILE
	FRIABLE
	NO

MARCH AIR RESERVE BASE, CALIFORNIA
ASBESTOS SURVEY OF NON-CANTONMENT AREA
INDUSTRIAL AND RESIDENTIAL STRUCTURES
 U.S. DEPARTMENT OF THE AIR FORCE
 HQ. AFCEC/ERB
 3207 NORTH ROAD, BROOKS, TX 78235-5363

CONTRACT NO. F 41624-94-D-8138 CONTRACT NO. 0067
 PROJECT **BUILDING #2995**

EARTHTECH
 10 West Broadway, Ste. 500, Los Brea, California 90801-4403

PROJECT NO.	23517-03	REVISION	
DRAWN BY	MCGRATZ	DATE	
APPROVED BY	LJENSEN	DATE	
SCALE	NOT TO SCALE	DATE	
		SHEET NO.	A-1
		OF	1

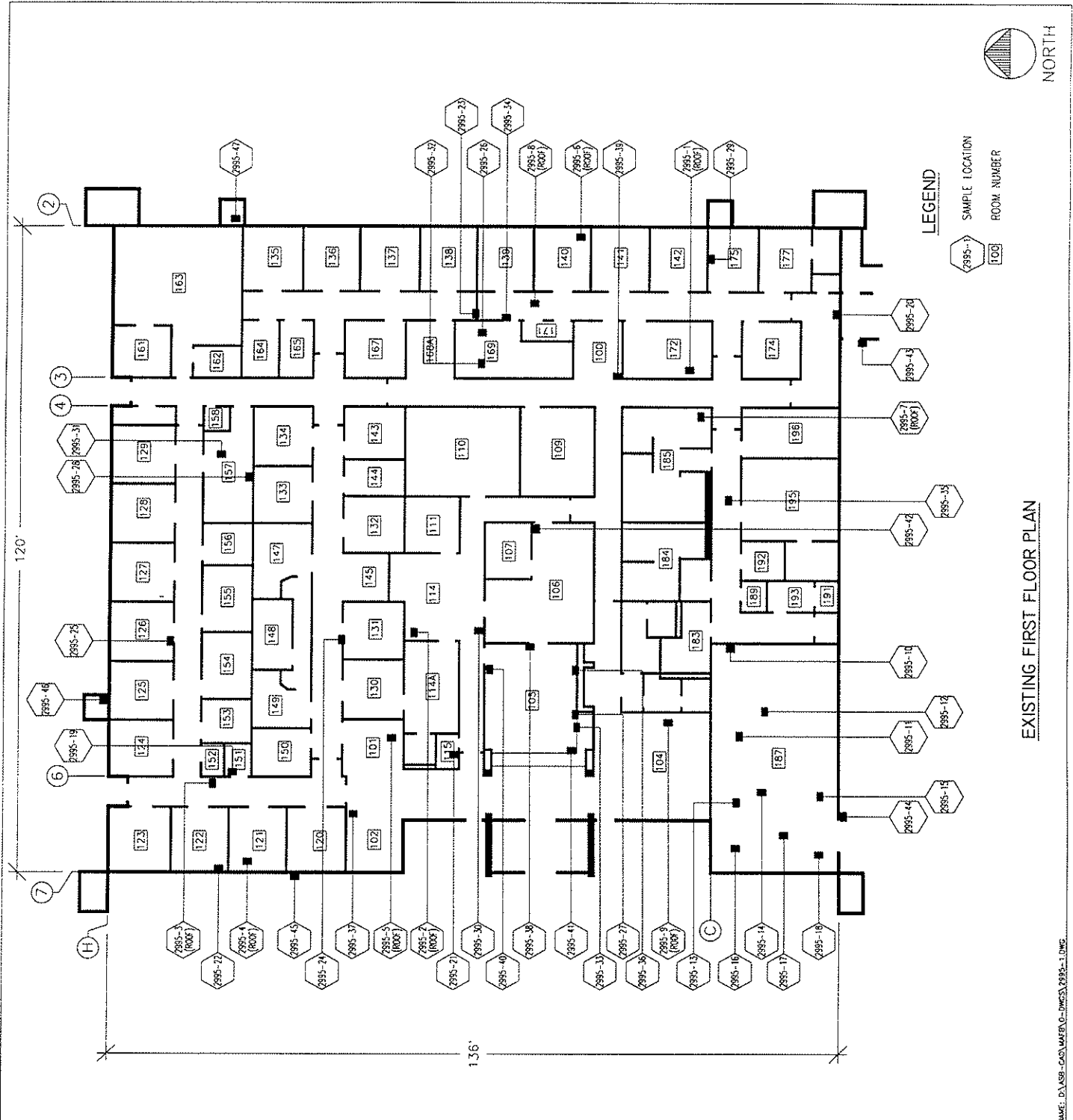

EXISTING FIRST FLOOR PLAN

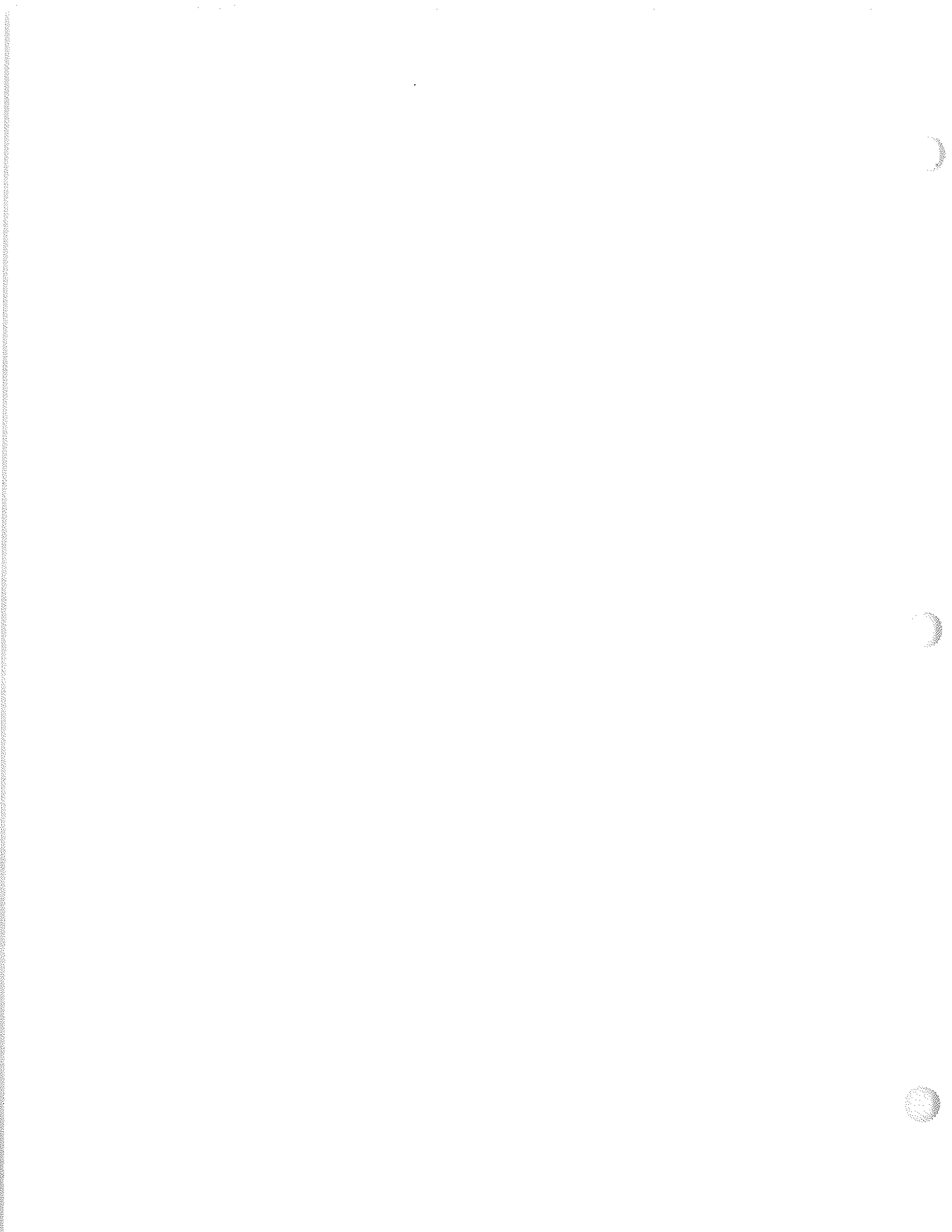



1. Facility 2995, exterior front view.

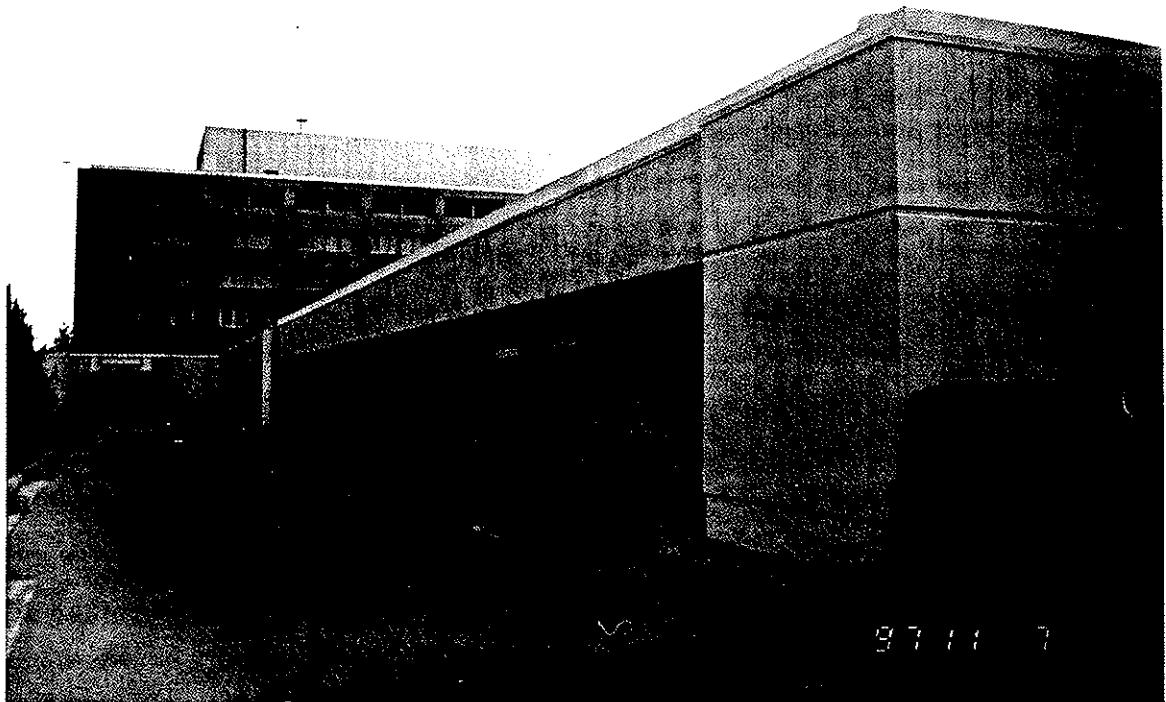

2. Facility 2995, exterior rear view.

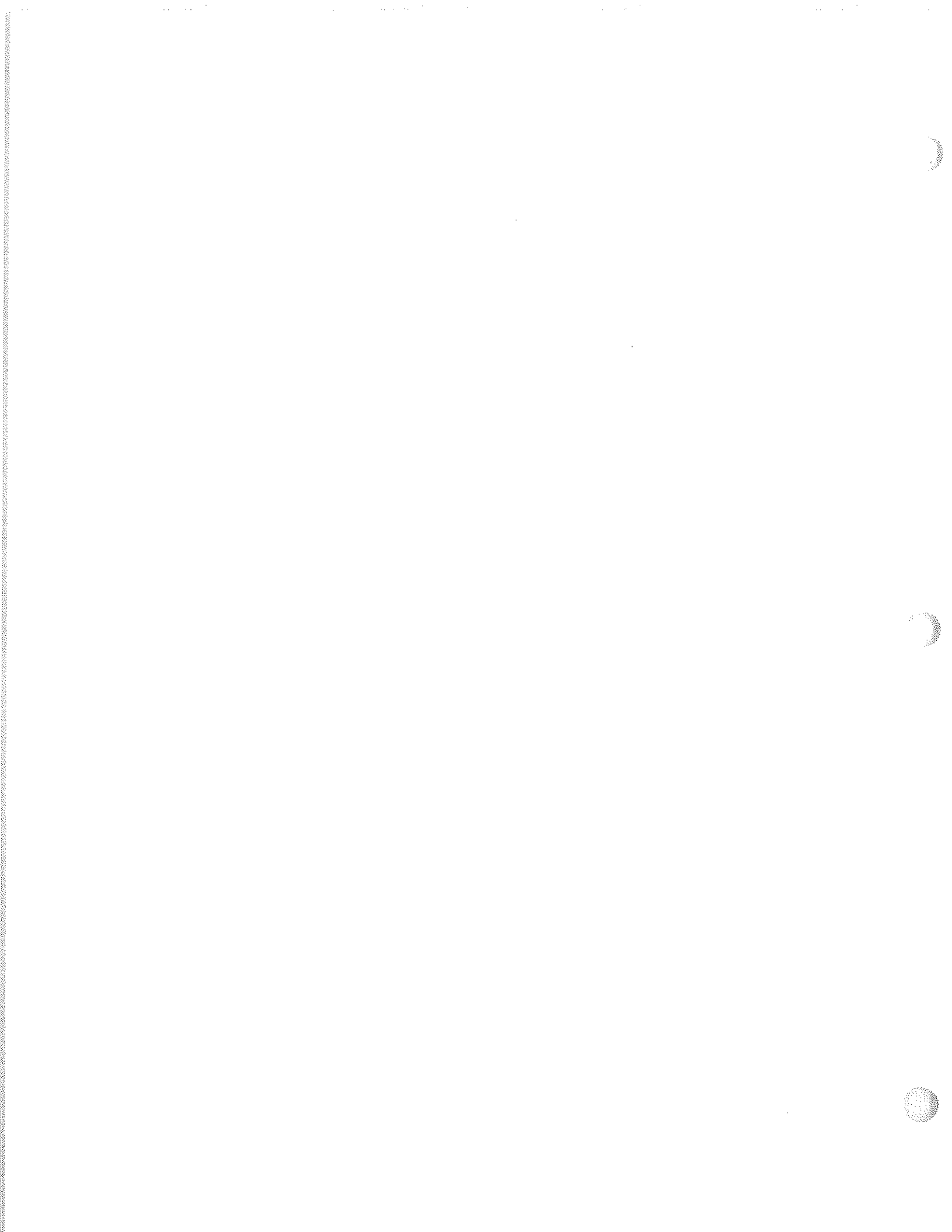

RJ LeeGroup, Inc.

530 McCormick Street • San Leandro, CA 94710
(510) 567-0480 • FAX (510) 567-0488

November 21, 1997

Mr. Roy Litzenberg
The Earth Technology, Inc.
100 West Broadway, Suite 5000
Long Beach, CA 90802

RE: PLM Standard Asbestos Analysis Results for Samples as Shown on Test Report
RJLeeGroup, Inc. Job No.: AOC711240
Client P.O./Job Number: 23517-04
Client Job Name/Location: March ARB; Building 2995

Dear Mr. Litzenberg:

Enclosed are the results from the polarized light microscopy (PLM) asbestos analysis of the above referenced sample(s). Sample(s) were analyzed in accordance with guidelines set forth in the EPA Method for the Determination of Asbestos in Bulk Building Materials, EPA/600/R-93/116 (7/93 Edition).

Test Report lists each sample identification number, gross sample description, sample location, type(s) and concentration of asbestos, type(s) and concentration of nonasbestos fibers, major components and concentration of nonfibrous material (NFM), sample run date, analyst, sample homogeneity, and a layer breakdown if applicable. All concentrations are given in area percents (visual estimation).

RJ Lee Group, Inc. is accredited by the National Voluntary Laboratory Accreditation Program (NVLAP) (NVLAP Participant Number 1208-2) for bulk asbestos fiber analysis (PLM), and by the California Department of Health Services, Environmental Laboratory Accreditation Program (CALELAP) for bulk asbestos analysis. Neither the NVLAP Accreditation of this laboratory nor this report may be used to claim product endorsement by NVLAP or any agency of the United States government.

These results are submitted pursuant to RJ Lee Group's current terms and conditions of sale, including the company's standard warranty and limitation of liability provisions and no responsibility or liability is assumed for the manner in which the results are used or interpreted. Unless notified in writing to return the sample(s) covered by this report, RJ Lee Group will store the sample(s) for a period of ninety (90) days before discarding. A shipping and handling fee will be assessed for the return of any sample(s).

If you have any questions on this report or if RJ Lee Group, Inc. can be of further assistance, please do not hesitate to call.

Sincerely,

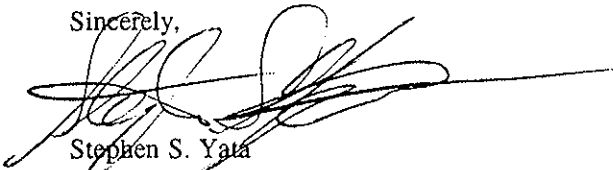

Stephen S. Yata
Geologist

SSY/sb
Enclosure

Monroeville, PA • San Leandro, CA • Washington, D.C. • Houston, TX
Chopra-Lee, Inc., Grand Island, NY

Test Report - The Earth Technology Corporation

Project #: MARB (Bldg 2995); 23517-04

Project AOC711240

Sample Number / Sample Appearance	Client Sample Number	Asbestos										Nonasbestos				Run Date	Analyst
		Chrysotile	Amosite	Crocidolite	Anthophyllite	Tremolite	Actinolite	Cellulose	Wool	Mineral	Glass	Fibers	Synthetic	Other	Fibers		
1654035CPL Black fiber material with tan fiber material	2995-01	-	-	-	-	-	-	45 %	-	-	-	-	-	-	55 %	11/21/97	BJW Non Homogeneous
1654036CPL Black fibrous layer with tan fibrous layer	2995-02	-	-	-	-	-	-	45 %	-	-	-	-	-	-	55 %	11/21/97	BJW Non Homogeneous
1654037CPL Black fibrous layer with tan fibrous layer	2995-03	-	-	-	-	-	-	45 %	-	-	-	-	-	-	55 %	11/21/97	BJW Non Homogeneous
1654038CPL Black roofing material with white shingle and tan fibers	2995-04	-	-	-	-	-	-	5 %	-	-	25 %	-	-	-	70 %	11/21/97	BJW Non Homogeneous
1654039CPL Black roofing material with white shingle and tan fibers	2995-05	-	-	-	-	-	-	5 %	-	-	25 %	-	-	-	70 %	11/21/97	BJW Non Homogeneous
1654040CPL Black roofing material with white shingle and tan fibers	2995-06	-	-	-	-	-	-	5 %	-	-	25 %	-	-	-	70 %	11/21/97	BJW Non Homogeneous

Samples received on: Friday, November 14, 1997

Authorized Signature

Date

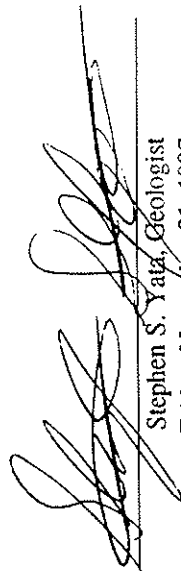

Stephen S. Yataz, Geologist
Friday, November 21, 1997

RJ Lee Group, Inc.

Bay Area Lab

530 McCormick Street
San Leandro, CA 94577

Phone (510) 567-0480
Fax (510) 567-0488

Test Report - The Earth Technology Corporation

Project #: MARB (Bidg 2995); 23517-04

Project AOC711240

Sample Number / Sample Appearance	Client Sample Number	Asbestos										Nonasbestos									
		Chrysotile	Amosite	Crocidolite	Anthophyllite	Tremolite	Actinolite	Cellulose	Wool	Glass	Fibers	Other Fibers	Synthetic	Mineral	Fibrous	Synthetic	Other	NonFibrous	Run Date	Analyst	
1654041CPL Black material	2995-07	-	-	-	-	-	-	-	-	-	-	-	-	-	-	-	-	-	90 %	11/21/97	BJW
		NFM: Tar, Misc. Part. Homogeneous																			

1654042CPL 2995-08

Sample Location Sample Not Analyzed

1654043CPL 2995-09

Sample Location Sample Not Analyzed

1654044CPL 2995-10

Yellow fiberglass with tan insulation

2 % 95 % 2 % 95 % 2 % 95 % 2 % 95 % 2 % 95 % 2 % 95 % 2 % 95 % 2 % 95 % 2 % 95 % 2 % 95 % 2 % 95 %
NFM: , Misc. Part. Non Homogeneous

1654045CPL 2995-11

Yellow fiberglass with white insulation and silver foil

9 % 85 % 9 % 85 % 9 % 85 % 9 % 85 % 9 % 85 % 9 % 85 % 9 % 85 % 9 % 85 % 9 % 85 % 9 % 85 % 9 % 85 %
NFM: , Misc. Part. Non Homogeneous

1654046CPL 2995-12

Yellow fiberglass with white insulation and silver foil

9 % 85 % 9 % 85 % 9 % 85 % 9 % 85 % 9 % 85 % 9 % 85 % 9 % 85 % 9 % 85 % 9 % 85 % 9 % 85 % 9 % 85 %
NFM: , Misc. Part. Non Homogeneous

Samples received on: Friday, November 14, 1997

Authorized Signature

Date

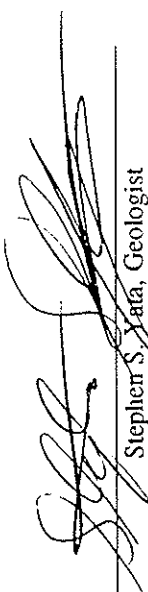

Stephen S. Yafa, Geologist
Friday, November 21, 1997

RJ Lee Group, Inc.
Bay Area Lab

530 McCormick Street
San Leandro, CA 94577

Phone (510) 567-0480
Fax (510) 567-0488

Test Report - The Earth Technology Corporation

Project #: MARB (Bldg 2995); 23517-04

Project AOC711240

-----Asbestos-----Nonasbestos-----
 Mineral Fibrous Glass Fibers Synthetic Fibers Other NonFibrous Run Date
 Sample Number / Client Sample Number Chrysotile Amosite Crocidolite Anthophyllite Tremolite Actinolite Cellulose Wool Glass Fibers Synthetic Fibers Other NonFibrous Run Date
 Sample Appearance 2995-13 15 % - - - - - 85 % 11/21/97
 White cloth with fibers NFM: , Misc. Part. Homogeneous

1654047CPL 2995-13 15 % - - - - - 85 % 11/21/97
 White cloth with fibers NFM: , Misc. Part. Homogeneous

1654048CPL 2995-14 15 % - - - - - 85 % 11/21/97
 White cloth with fibers NFM: , Misc. Part. Homogeneous

1654049CPL 2995-15 15 % - - - - - 85 % 11/21/97
 White cloth with fibers NFM: , Misc. Part. Homogeneous

1654050CPL 2995-16 100 % 11/21/97
 Black insulation NFM: , Misc. Part. Homogeneous

1654051CPL 2995-17 100 % 11/21/97
 Black insulation NFM: , Misc. Part. Homogeneous

1654052CPL 2995-18 100 % 11/21/97
 Black insulation NFM: , Misc. Part. Homogeneous

Samples received on: Friday, November 14, 1997



Authorized Signature
 Stephen S. Yata, Geologist
 Friday, November 21, 1997

Phone (510) 567-0480
 Fax (510) 567-0488

530 McCormick Street
 San Leandro, CA 94577

RJ Lee Group, Inc.
 Bay Area Lab

Test Report - The Earth Technology Corporation

Project #: MARB (Bldg 2995); 23517-04

Project AOC711240

Sample Number / Sample Appearance	Client	Asbestos-----Nonasbestos-----														
		Chrysotile	Amosite	Crocidolite	Anthrophyllite	Tremolite	Actinolite	Cellulose	Wool	Glass	Fibers	Synthetic	Other	NonFibrous	Run Date	Analyst
1654053CPL Grey/black flooring with tan mastic	2995-19	-	-	-	-	-	-	-	-	-	-	-	-	100 %	11/21/97	BJW
		NFM: , Misc. Part. Non Homogeneous														
1654054CPL Grey flooring with tan mastic	2995-20	-	-	-	-	-	1 %	-	-	-	-	-	-	99 %	11/21/97	BJW
		NFM: , Misc. Part. Non Homogeneous														
1654055CPL Grey flooring with tan mastic	2995-21	-	-	-	-	-	-	-	-	-	-	-	-	100 %	11/21/97	BJW
		NFM: , Misc. Part. Non Homogeneous														
1654056CPL Grey linoleum with tan mastic	2995-22	-	-	-	-	-	-	-	-	-	-	-	-	100 %	11/21/97	BJW
		NFM: , Misc. Part. Non Homogeneous														
1654057CPL Grey linoleum with tan mastic	2995-23	-	-	-	-	-	-	-	-	-	-	-	-	100 %	11/21/97	BJW
		NFM: , Misc. Part. Non Homogeneous														
1654058CPL Grey linoleum with tan mastic	2995-24	-	-	-	-	-	-	-	-	-	-	-	-	100 %	11/21/97	BJW
		NFM: , Misc. Part. Non Homogeneous														

Samples received on: Friday, November 14, 1997

Authorized Signature

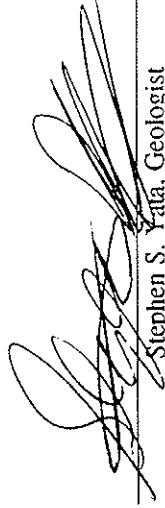

Stephen S. Yata, Geologist

Date Friday, November 21, 1997

530 McCormick Street
San Leandro, CA 94577

Phone (510) 567-0480
Fax (510) 567-0488

RJ Lee Group, Inc.
Bay Area Lab

Test Report - The Earth Technology Corporation

Project #: MARB (Bldg 2995); 23517-04

Project AOC711240

-----Asbestos-----Nonasbestos-----

Sample Number / Sample Appearance	Client	Sample Number	Chrysotile	Amosite	Crocidolite	Anthophyllite	Tremolite	Actinolite	Cellulose	Wool	Mineral	Glass	Fibrous	Synthetic	Other	NonFibrous	Run Date	Analyst
1654059CPL Tan ceiling tile with white paint	2995-25	-	-	-	-	-	-	-	35 %	45 %	-	-	-	-	-	20 %	11/21/97	BJW
NFM: Per, Misc. Part. Homogeneous																		
1654060CPL Tan ceiling tile with white paint	2995-26	-	-	-	-	-	-	-	35 %	45 %	-	-	-	-	-	20 %	11/21/97	BJW
NFM: Per, Misc. Part. Homogeneous																		
1654061CPL Tan ceiling tile with white paint	2995-27	-	-	-	-	-	-	-	35 %	45 %	-	-	-	-	-	20 %	11/21/97	BJW
NFM: Per, Misc. Part. Homogeneous																		
1654062CPL White plaster with tan paper, white paper with white joint compound	2995-28	-	-	-	-	-	-	-	10 %	-	-	5 %	-	-	-	85 %	11/21/97	BJW
NFM: Carb, Misc. Part. Non Homogeneous																		
1654063CPL White plaster with tan paper, white paper with white joint compound	2995-29	-	-	-	-	-	-	-	10 %	-	-	5 %	-	-	-	85 %	11/21/97	BJW
NFM: , Misc. Part. Non Homogeneous																		
1654064CPL White plaster with tan paper, white paper with white joint compound	2995-30	-	-	-	-	-	-	-	10 %	-	-	5 %	-	-	-	85 %	11/21/97	BJW
NFM: , Misc. Part. Non Homogeneous																		

Samples received on: Friday, November 14, 1997

Authorized Signature

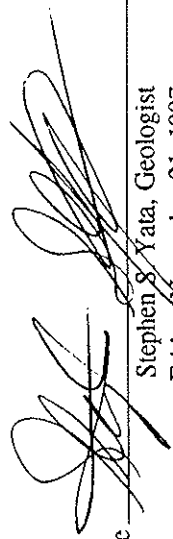

Stephen S. Yata, Geologist
Friday, November 21, 1997

Date

530 McCormick Street
San Leandro, CA 94577

Phone (510) 567-0480
Fax (510) 567-0488

RJ Lee Group, Inc.
Bay Area Lab

Test Report - The Earth Technology Corporation

Project #: MARB (Bldg 2995); 23517-04

Project AOC711240

Sample Number / Sample Appearance	Client	Asbestos					Nonasbestos					NonFibrous Run Date				
		Chrysotile	Amosite	Crocidolite	Anthophyllite	Tremolite	Cellulose	Wool	Glass	Fibers	Synthetic		Other	Fibers	Material	Analyst
1654065CPL Gold fiberglass	2995-31	-	-	-	-	-	-	99+	%	-	-	-	<1	%	11/21/97	BJW Homogeneous
NFM: , Misc. Part.																
1654066CPL Gold fiberglass with silver insulation	2995-32	-	-	-	-	-	-	95	%	-	-	-	5	%	11/21/97	BJW Homogeneous
NFM: , Misc. Part.																
1654067CPL Yellow fiberglass with silver insulation	2995-33	-	-	-	-	-	95	%	-	-	-	-	5	%	11/21/97	BJW Non Homogeneous
NFM: , Misc. Part.																
1654068CPL Yellow fiberglass with tan insulation silver foil	2995-34	-	-	-	-	-	8	%	<1	%	-	-	7	%	11/21/97	BJW Non Homogeneous
NFM: , Misc. Part.																
1654069CPL Yellow fiberglass with tan insulation silver foil	2995-35	-	-	-	-	-	8	%	<1	%	-	-	7	%	11/21/97	BJW Non Homogeneous
NFM: , Misc. Part.																
1654070CPL Pink fiberglass with tan insulation silver foil	2995-36	-	-	-	-	-	8	%	<1	%	-	-	7	%	11/21/97	BJW Non Homogeneous
NFM: , Misc. Part.																

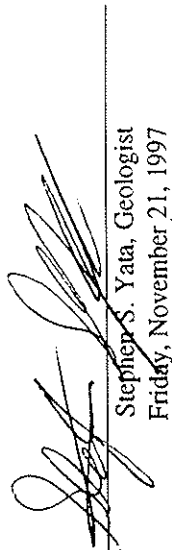
 Authorized Signature
 Stephen S. Yata, Geologist
 Friday, November 21, 1997

Samples received on: Friday, November 14, 1997

Date

Phone (510) 567-0480
 Fax (510) 567-0488

530 McCormick Street
 San Leandro, CA 94577

RJ Lee Group, Inc.
 Bay Area Lab

Test Report - The Earth Technology Corporation

Project #: MARB (Bidg 2995); 23517-04

Project AOC711240

-----Asbestos-----Nonasbestos-----

Sample Number / Sample Appearance	Client Sample Number	Chrysotile	Amosite	Crocidolite	Anthophyllite	Tremolite	Actinolite	Cellulose	Wool	Mineral	Glass	Fibers	Synthetic	Other	NonFibrous	Run Date
1654071CPL Grey baseboard with tan mastic	2995-37	-	-	-	-	-	-	-	-	-	-	-	-	-	100 %	11/21/97
		NFM: Carb, Misc. Part.														
1654072CPL Grey baseboard with tan mastic	2995-38	-	-	-	-	-	-	-	-	-	-	-	-	-	100 %	11/21/97
		NFM: , Misc. Part.														
1654073CPL Grey baseboard with tan mastic	2995-39	-	-	-	-	-	-	-	-	-	-	-	-	-	100 %	11/21/97
		NFM: , Misc. Part.														
1654074CPL Brown mastic	2995-40	-	-	-	-	-	-	<1 %	-	-	-	<1 %	-	-	99+ %	11/21/97
		NFM: , Misc. Part.														
1654075CPL Brown mastic	2995-41	-	-	-	-	-	-	<1 %	-	-	-	<1 %	-	-	99+ %	11/21/97
		NFM: , Misc. Part.														
1654076CPL Brown mastic	2995-42	-	-	-	-	-	-	<1 %	-	-	-	<1 %	-	-	99+ %	11/21/97
		NFM: , Misc. Part.														

Samples received on: Friday, November 14, 1997

Authorized Signature

Date

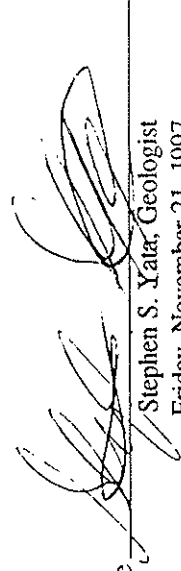

Stephen S. Yata, Geologist
Friday, November 21, 1997

RJ Lee Group, Inc.
Bay Area Lab

530 McCormick Street
San Leandro, CA 94577

Phone (510) 567-0480
Fax (510) 567-0488

Test Report - The Earth Technology Corporation

Project #: MARB (Bldg 2995); 23517-04

Project AOC711240

-----Asbestos-----Nonasbestos-----

Sample Number / Sample Appearance	Client Sample Number	Chrysotile	Amosite	Crocidolite	Anthophyllite	Tremolite	Actinolite	Cellulose	Wool	Glass	Fibers	Fibers	Other	NonFibrous	Run Date	Analyst
1654077CPL Grey stucco with tan paint	2995-43	-	-	-	-	-	-	-	-	-	-	-	-	100 %	11/21/97	BJW Homogeneous
		NFM: , Misc. Part.														
1654078CPL Grey stucco with tan paint	2995-44	-	-	-	-	-	-	-	-	-	-	-	-	100 %	11/21/97	BJW Homogeneous
		NFM: , Misc. Part.														
1654079CPL Grey stucco with tan paint	2995-45	-	-	-	-	-	-	-	-	-	-	-	-	100 %	11/21/97	BJW Homogeneous
		NFM: , Misc. Part.														
1654080CPL Grey stucco with tan paint	2995-46	-	-	-	-	-	-	-	-	-	-	-	-	100 %	11/21/97	BJW Homogeneous
		NFM: , Misc. Part.														
1654081CPL Grey stucco with tan paint	2995-47	-	-	-	-	-	-	-	-	-	-	-	-	100 %	11/21/97	BJW Homogeneous
		NFM: , Misc. Part.														

Samples received on: Friday, November 14, 1997

Authorized Signature



Stephen S. Yata, Geologist
Friday, November 21, 1997

Date

RJ Lee Group, Inc.
Bay Area Lab

530 McCormick Street
San Leandro, CA 94577

Phone (510) 567-0480
Fax (510) 567-0488

Bulk Sample Log



Asbestos and Air Quality Division, Western Region
100 W. Broadway • Suite 5000 • Long Beach, CA 90802-4443

Mail Post Office Box 22785, Long Beach, CA 90801-5785
Telephone: (310) 495-4449, (714) 821-7062 / Fax: (310) 495-7148

Facility: BLDG #2995 Functional Space:
Client: MARCO Project Number: 23517-04
Taken By: Carlos Goldamez Date Sampled: 11-7-97

Sample No.	Sample Location	Homo ID#	Material Type	Description	Asbestos Detected	
					Y	N
2995-01	Roof - SE corner	BUR-1	Comp. Roofing w/ Ballast			
-02	" - Center	↓	↓			
-03	" - NW corner	↓	↓			
-04	Roof - NW corner	DM-1	Roofing MTL @ Parapet Wall			
-05	" - Platform	↓	↓			
-06	" - SE corner	↓	↓			
-07	Roof - SE corner	RM-1	Roof Mastic			
-08	" - E. side	↓	↓			
-09	" - SW side	↓	↓			
↓-10	Rm 191 - NE corner	FPI-1	Flg Pipe Insulation			

Analytical Method: Polarized Light Microscopy

Sample Receiver: EARTH TECH • 100 W. Broadway • Suite 5000 • Long Beach, CA 90802-4443

Chain of Possession:

1.	<u>[Signature]</u> Signature	<u>[Title]</u> Title	<u>11-7-97 / 11-7-97</u> Inclusive Dates
2.	<u>[Signature]</u> Signature	<u>R. S. Lee Group</u> Title	<u>11/14/97</u> Inclusive Dates
3.	<u> </u> Signature	<u> </u> Title	<u> </u> Inclusive Dates

Bulk Sample Log



Asbestos and Air Quality Division, Western Region
100 W. Broadway • Suite 5000 • Long Beach, CA 90802-4443

Mail Post Office Box 22785, Long Beach, CA 90801-5785
Telephone: (310) 495-4449, (714) 821-7062 / Fax: (310) 495-7148

Facility: BLDG #2995 Functional Space: _____
Client: MADP Project Number: 23517-04
Taken By: Carlo Galamez Date Sampled: 11-7-97

Sample No.	Sample Location	Homo ID.#	Material Type	Description	Asbestos Detected	
					Y	N
2995-31	Rm 157 - Center	FDI-1	Flg Duct Ins.	Supply - Air		
-32	Rm 169 - NW corner	↓	↓	↓		
-33	Rm 105 - SW corner	↓	↓	↓		
-34	E Corr. - Center	FDI-2	Flg Duct Ins.	Metal wrap		
-35	S. Corr. - outside Rm 195	↓	↓	↓		
-36	Rm 105 - SE AREA	↓	↓	↓		
-37	Rm 102 - N. Side	BM-1	Baseboard/Mastic			
-38	Rm 105 - E. Side	↓	↓			
-39	Rm 105B - S. Side	↓	↓			
-40	Rm 105 - SE corner	CM-1	Carpet Mastic			

Analytical Method: Polarized Light Microscopy

Sample Receiver: EARTH TECH • 100 W. Broadway • Suite 5000 • Long Beach, CA 90802-4443

Chain of Possession:

1.	<u>[Signature]</u> Signature	_____ Title	<u>11-7-97</u> Inclusive Dates
2.	<u>[Signature]</u> Signature	<u>R. J. Lee</u> Title	<u>11/4/97</u> Inclusive Dates
3.	_____ Signature	_____ Title	_____ Inclusive Dates

